

Customer : ALGE GERMAN DISTRIBUTER

No. LX-2004-2927

Attention: _____

Date : Jul. 21, 2004

Your ref. No: _____

Your Part. No : ALBS 402151

SPECIFICATIONS

ALPS' ;

MODEL RK09L1220A0S
(100kB X2)

Spec. No. : _____

Sample No. : F1689866M

RECEIPT STATUS
RECEIVED

By Date _____

Signature _____

Name _____

Title _____

ALPS ELECTRIC CO., LTD.

HEAD OFFICE
1-7, YUKIGAYA-OHTSUKA-CHO,
OHTA-KU, TOKYO 145-8501 JAPAN

DSG'D

M. Sato

APP'D

S. Sato

Sales _____

SPECIFICATIONS

1. THIS SPECIFICATIONS APPLY TO RK09L1220A0S POTENTIOMETER.

2. CONTENTS OF THIS SPECIFICATIONS.

F1689866M
K092G000C

3. MARKING

· MARKING ON ALL UNITS
DATE CODE, RESIST. VALUE, TAPER

4. REMARKS

· FURNISH PACKAGE
NUT: 1, WASHER: 1

· CAUTION

Regardless of the suggested applications of these products being introduced in the specifications, when using them for equipment and devices requiring a high degree of safety, respective manufacturers will please preserve safety of the planned equipment and devices by providing necessary protective circuits and redundancy circuits and reconfirm if safety is being duly preserved.

Products being introduced in the specifications have been designed and manufactured for applications to ordinary electronic equipment and devices such as the AV equipment, electric home appliances, office machines and communications equipment. Consequently, when employing these products for applications requiring a high degree of safety and reliability such as the medical equipment, aviation and aircraft equipment, space equipment and burglar alarm equipment, the using manufacturers will please thoroughly study the proprieties of these products for the planned applications.

Although we are exerting our best efforts to maintain the quality of these products, we cannot guarantee that they will never cause short circuiting and open circuitry. Therefore, when designing an equipment or device with which the priority is given to the safety, you will please carefully study the influences to the whole equipment of a single function failure of Potentiometers and Encoders in advance to make out a fail-safe design providing.

SPECIFICATIONS

ELECTRICAL

1. Total resistance : 100kΩ ± 20%
2. Rated power : 0.05 W
3. Rated voltage :
 The rated voltage shall be the voltage of D.C. or A.C. (commercial frequency, effective value) corresponding to the rated power (dissipation), and be obtained from the following formula. When the obtained rated voltage exceeds the maximum working voltage given in the following, however, the maximum working voltage of the following shall be the rated voltage.

$$E = \sqrt{P \cdot R} \text{ (V)}$$
 where
 E : Rated voltage (V)
 P : Rated power (dissipation) (W)
 R : Nominal total resistance (Ω)
 Maximum working voltage : 50 V A.C. , 10 V D.C.
4. Resistance taper : B
5. Residual resistance between terminals 1&2, 2&3 : 100Ω max.
6. Sliding noise : Less than 100mV. (Measured by JIS C 6443)
7. Insulation resistance : More than 100 MΩ at 250V D.C.
8. Withstand voltage: 300V A.C. for 1 minute.
9. Gang error : 3 dB max. at 150°

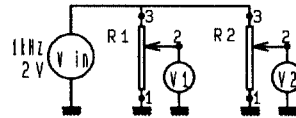

MECHANICAL

1. Total rotational angle : 300° ± 5°
2. Rotational torque : 2~25mN·m (Rotational speed 60°/sec.)
3. Stopper strength : No damage with an application of 0.5N·m.
4. Resistance to soldering heat : Please refer to the attached
5. Bushing nut tightening strength : Tightening torque to be no greater than 1N·m.
 *Pay attention otherwise the strength may not be assured.

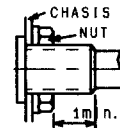

6. Push/pull strength :
 After installing the potentiometer, no damages with an application of push or pull force 80N for 10 seconds.
7. Shaft wobble :
 The resistor shall be mounted by soldering the mounting legs on the panel and a side thrust of 50mN·m at the end of the shaft shall be applied, then the total play of the shaft shall not exceed 0.6xL/20 mm-p.
 (L is the length between mounting surface and measuring point.)

ENDURANCE

1. Rotational life : 15,000 cycles min.

NOTE

1. Operating temperature range : -10~+70°C
2. Storage temperature range : -20~+80°C
3. The items except above mentioned items shall meet or exceed JIS C 6443.
4. The use for HomeAudio.
5. This type is protected against sulfides.

ALPS ELECTRIC CO., LTD.				
APPD.	CHKD.	DSGD.	TITLE	
Aug. 19, '93	Aug. 19, '93	Aug. 19, '93	F 1 6 8 9 8 6 6 M	
S. Aizawa	M. Satoh	Y. Saitoh	DOCUMENT NO.	
SYMB	DATE	APPD	CHKD	DSGD
				L X



ALPS ELECTRIC CO., LTD
1-7 YUKIGAYA OTSUKA-CHO OTA-KU TOKYO JAPAN

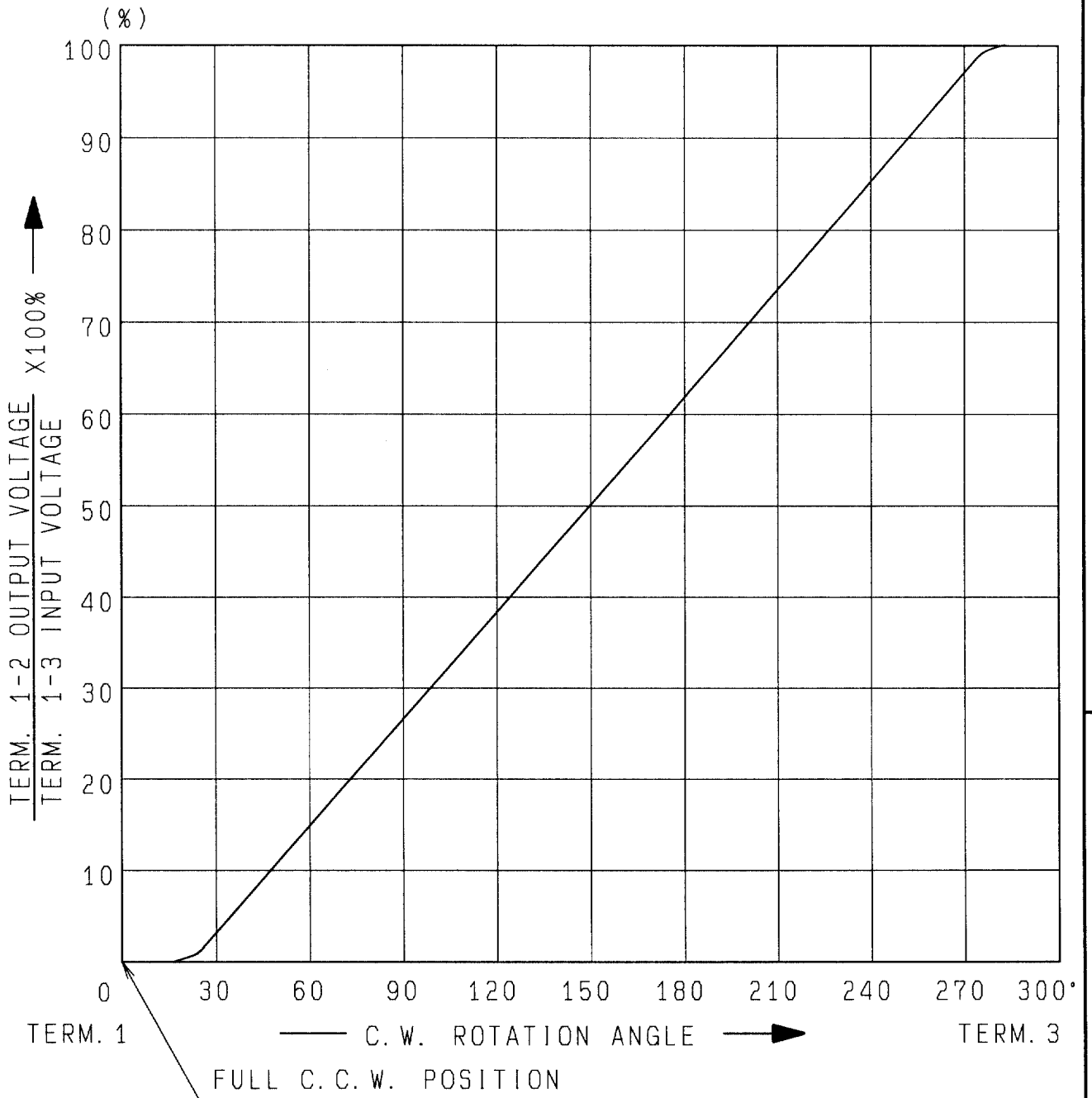

AT 150° C.W. SHAFT ROTATION FROM FULL C.C.W. POSITION VOLTAGE PERCENT SHALL FALL WITHIN THE LIMITS OF 40~60 PERCENT.

					APPD.	CHKD.	DSGD.	NAME
					Sep. 07. '93	Sep. 07. '93	Sep. 07. '93	RESISTANCE TAPER (B)
					K. Magami	K. Sasaki	K. Suzuki	DOCUMENT NO.
SYMB	DATE	APPD	CHKD	DSGD				F1689866M

LX

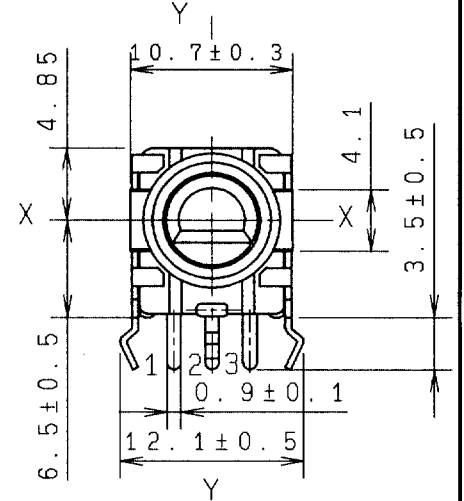
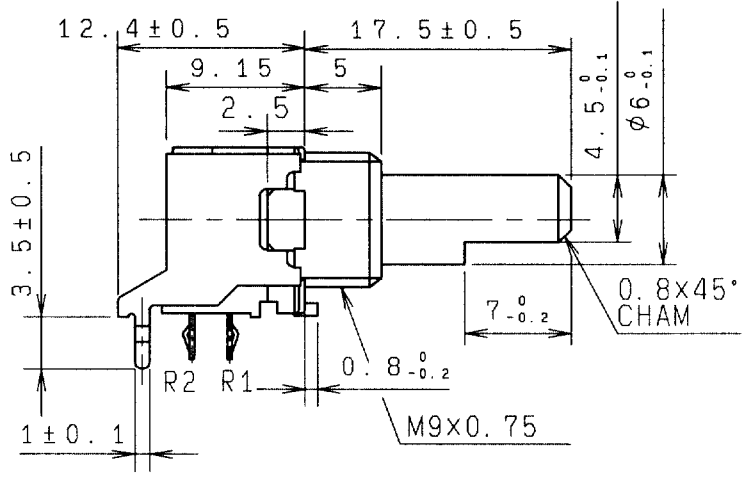

端子取付寸法図 (挿入側より見た図)
 (許容差±0.1)
 MOUNTING HOLE DETAIL
 (TOLERANCE±0.1)
 VIEWED FROM MOUNTING SIDE

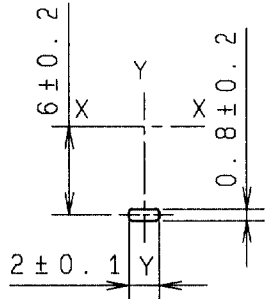
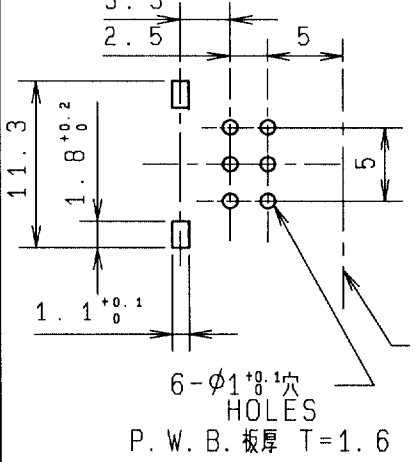

シャフト止め 詳細図
 LOCATING LUG
 DETAIL
 軸受取付面
 BUSHING
 MOUNTING
 SURFACE

軸はセンター位置を示す
 SHAFT SHOWN IN
 CENTER POSITION

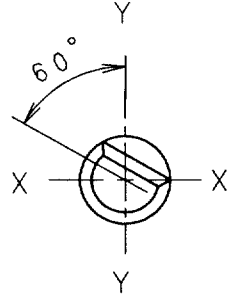

軸は、反時計方向に
 回し切った状態を示す
 SHAFT SHOWN
 IN FULL C. C. W
 POSITION.

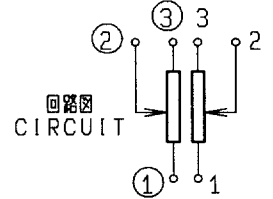

回路図
 CIRCUIT
 製品質量: 6.6g
 NET WEIGHT

指定なき部分の許容差 TOLERANCES UNLESS OTHERWISE SPEC	
$L \leq 10$	±0.3
$10 < L < 100$	±0.5
$100 \leq L$	±0.8
角度 ANGULAR DIMENSION	±5°

PART NO.		NAME		MATERIAL NAME / CODE		FINISH	
ALPS ELECTRIC CO., LTD.							
DSGN. 1-設計1課 Y. Saitoh 93-10-01				SCALE 2/1		NO. F1689866M	
CHKD. SEC M. Satoh 93-10-01						TITLE 9形1軸2連VR組立図 FIGURE	
APPD. SEC S. Aizawa 93-10-01						DOCUMENT NO. G01	
SYMB	DATE	APPD	CHKD	DSGD	UNIT mm	K092G000C	

Metal Shaft Potentiometer 9mm Size Metal Shaft Snap-in Type

RK09L Series



Single-unit and dual-unit type suits a variety of controls.

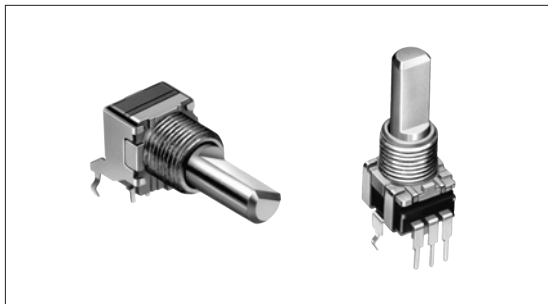

Features

- Snap-in structure assures easy mounting.
- Closed structure improves dust and flux resistance.
- Available in horizontal and vertical type.

Applications

- For various control in audio equipment products - DVD players/recorders, mini component systems, portable audio equipment
- For various control in mixing consoles and electronic musical instruments

Rotary Potentiometers

Slide Potentiometers

Multi Control Devices

Sensors

Metal Shaft

Insulated Shaft

Hollow Type

Knob Operating

Typical Specifications

Items	Specifications
Total resistance tolerance	±20%
Maximum operating voltage	50V AC , 10V DC
Total rotational angle	300±5°
Rotational torque	2 to 25mN·m
Operating life	15,000cycles
Operating temperature range	-10°C to +70°C

Recommended Products List

Number of resistor elements	Mounting direction	Shaft type	Length of the shaft (mm)	Center detent	Total resistance (kΩ)	Resistance taper	Minimum packing unit (pcs.)	Products No.	Drawing No.						
Single-unit	Horizontal type	Flat	15	Without	10	15A	100	RK09L1120A2S	1						
				With		1B		RK09L1120036							
			20	Without		15A		RK09L1120A69							
						Vertical type		12.5		Without	50	RK09L1140A5E	2		
	15		10	RK09L1140A66											
				20				With	1B		RK09L1140A5P				
	25		Without					5			RK09L1140A2U				
			Dual-unit	Horizontal type for tone					15		With	50		15A	100
	Horizontal type for vol.							Without			100	RK09L1140A65			
				25		Without			50	RK09L122002M					
15	With	10			15A		RK09L1220A1B								
		20		Without	50	1B	RK09L12B0A31								
Vertical type for tone	15				Without	50	3B	RK09L12B0A3Z	4						
		20	50	1B		RK09L124000Z									
	15		Without	10		15A	RK09L1240A0W								
		20		Without		10	15A	RK09L12D0A1W							
20	Without		10		15A	RK09L12D0A1T									



Note

Products other than those listed in above recommended products are also available. Please contact us for details.

Refer to P.13 for product varieties.
Refer to P.52 for product specifications.

Dimensions

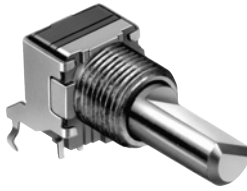
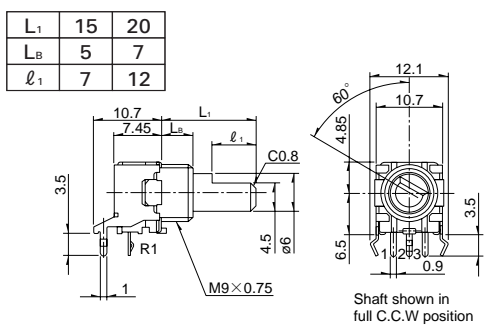
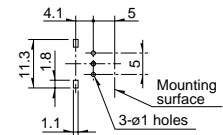
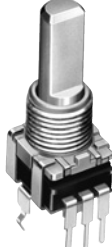
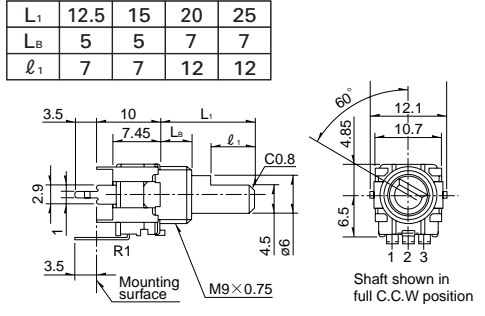
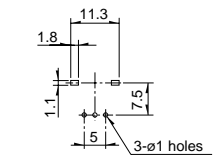
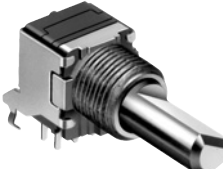
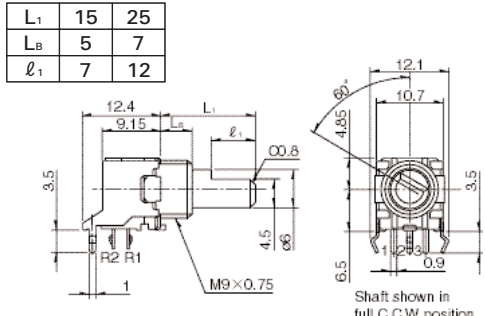
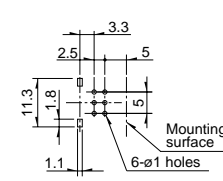
Unit:mm

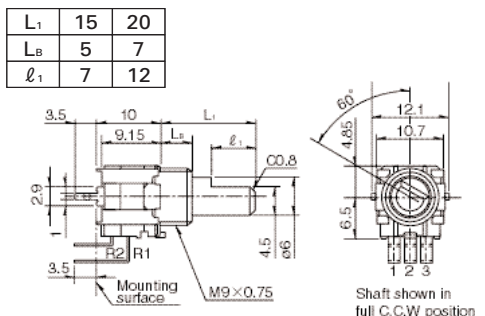
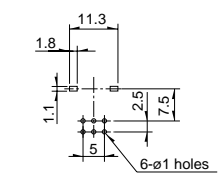
No.	Photo	Style	PC board mounting hole dimensions (Viewed from mounting side)															
1	<p>Single-shaft, single-unit Horizontal type RK09L1120</p> 	<table border="1"> <tr><td>L₁</td><td>15</td><td>20</td></tr> <tr><td>L_B</td><td>5</td><td>7</td></tr> <tr><td>ℓ₁</td><td>7</td><td>12</td></tr> </table>  <p>Shaft shown in full C.C.W position</p>	L ₁	15	20	L _B	5	7	ℓ ₁	7	12	 <p>3-ø1 holes</p>						
L ₁	15	20																
L _B	5	7																
ℓ ₁	7	12																
2	<p>Single-shaft, single-unit Vertical type RK09L1140</p> 	<table border="1"> <tr><td>L₁</td><td>12.5</td><td>15</td><td>20</td><td>25</td></tr> <tr><td>L_B</td><td>5</td><td>5</td><td>7</td><td>7</td></tr> <tr><td>ℓ₁</td><td>7</td><td>7</td><td>12</td><td>12</td></tr> </table>  <p>Shaft shown in full C.C.W position</p>	L ₁	12.5	15	20	25	L _B	5	5	7	7	ℓ ₁	7	7	12	12	 <p>3-ø1 holes</p>
L ₁	12.5	15	20	25														
L _B	5	5	7	7														
ℓ ₁	7	7	12	12														
3	<p>Single-shaft, dual-unit Horizontal type RK09L1220 (For tone) RK09L12B0 (For vol.)</p> 	<table border="1"> <tr><td>L₁</td><td>15</td><td>25</td></tr> <tr><td>L_B</td><td>5</td><td>7</td></tr> <tr><td>ℓ₁</td><td>7</td><td>12</td></tr> </table>  <p>Shaft shown in full C.C.W position</p>	L ₁	15	25	L _B	5	7	ℓ ₁	7	12	 <p>6-ø1 holes</p>						
L ₁	15	25																
L _B	5	7																
ℓ ₁	7	12																
4	<p>Single-shaft, dual-unit Vertical type RK09L1240 (For tone) RK09L12D0 (For vol.)</p> 	<table border="1"> <tr><td>L₁</td><td>15</td><td>20</td></tr> <tr><td>L_B</td><td>5</td><td>7</td></tr> <tr><td>ℓ₁</td><td>7</td><td>12</td></tr> </table>  <p>Shaft shown in full C.C.W position</p>	L ₁	15	20	L _B	5	7	ℓ ₁	7	12	 <p>6-ø1 holes</p>						
L ₁	15	20																
L _B	5	7																
ℓ ₁	7	12																

Dimensions of Bushing and Fixing Lug

Unit:mm

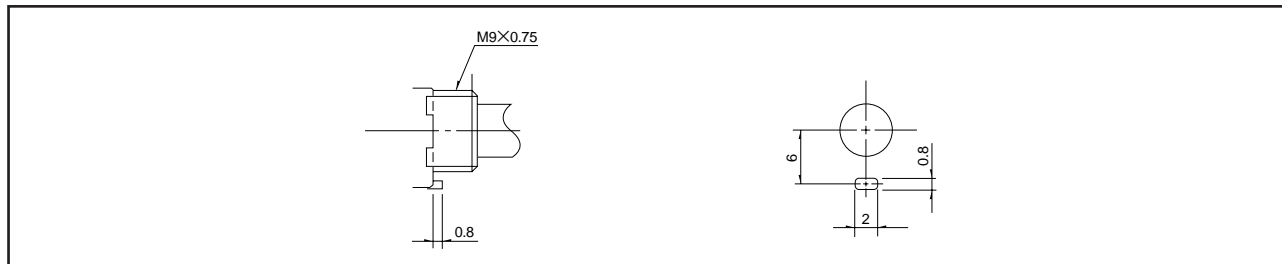

Product Varieties

In addition to the recommended products, the following specifications can also be accommodated.

Total Resistance Variety

Total resistance (kΩ)	5	10	20	50	100
-----------------------	---	----	----	----	-----

Resistance Taper

Resistance taper	15A	1B	3B	15C
------------------	-----	----	----	-----

Shaft Variety

Unit:mm

Shaft shown in full CCW position

Detail dimensions

L ₁	L _B	l ₁
12.5	5	7
15	5	7
17.5	5	7
20	7	12
25	7	12

Note

marked are specifications recommended by ALPS.

Rotary Potentiometers

Slide Potentiometers

Multi Control Devices

Sensors

Metal Shaft

Insulated Shaft

Hollow Type

Knob Operating

Refer to P.14, 211 for resistance taper.

Orders For Specifications Not Listed In The Recommended Products

When ordering product varieties that are not listed in the Recommended Product list, please specify by referring to the below example.

Sample Part Number



Model type

Code	Model type
112	Single-unit horizontal type
114	Single-unit vertical type
122	Dual-unit horizontal type for tone
124	Dual-unit vertical type for tone
12B	Dual-unit horizontal type for vol.
12D	Dual-unit vertical type for vol.

Shaft type

Code	Shaft type
F	Flat

* Only available in flat format.

Length of the shaft (L₁) (mm)

Code	Length of the shaft	Code	Length of the shaft	Code	Length of the shaft
12	12.5	17	17.5	25	25
15	15	20	20		

Detent

Code	Center detent
C0	Without
C1	With

Resistance taper

Code	Resistance taper	Code	Resistance taper
A	15A	V	3B
B	1B	C	15C

B:For tone & general(model type : 112,114,122,124)
V:For vol.(model type : 112,114,12B,12D)

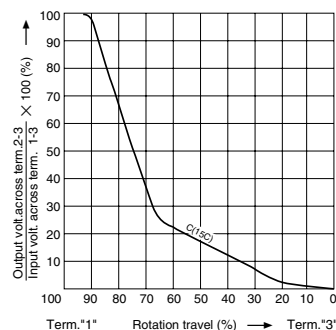
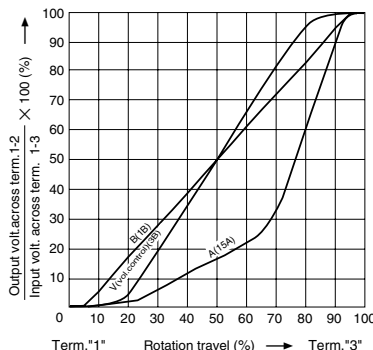

Total resistance

Code	Total resistance (kΩ)	Code	Total resistance (kΩ)
502	5	503	50
103	10	104	100
203	20		

Note

marked are specifications recommended by ALPS.

Rotary Potentiometers

Slide Potentiometers

Multi Control Devices

Sensors

Metal Shaft

Insulated Shaft

Hollow Type

Knob Operating

Product Specifications

Model		RK09L	RK097 RK098	RK117	RK119	RK163 RK168
Items	Operating temperature range	-10°C to +70°C	-20°C to +70°C	-30°C to +70°C	-40°C to +85°C	-10°C to +70°C
Electrical performance	Total resistance tolerance	±20%				
	Rated power	0.05W				
	Maximum operating voltage	50V AC, 10V DC				RK163: 150V AC, 5V, DC RK168: 50V AC
	Residual resistance	$R \leq 10k\Omega$ $10k\Omega < R < 50k\Omega$ $50k\Omega \leq R$	20Ω max. 30Ω max. Nominal total resistance of 0.1% or less		$R \leq 10k\Omega$ 50Ω max. $10k\Omega < R \leq 50k\Omega$ 80Ω max. $50k\Omega < R$ Nominal total resistance of 0.2% or less	$R \leq 10k\Omega$ 20Ω max. $10k\Omega < R \leq 50k\Omega$ 30Ω max. $50k\Omega < R$ Nominal total resistance of 0.1% or less
	Maximum attenuation (Volume control)		$5k\Omega \leq R < 10k\Omega$ $10k\Omega \leq R < 50k\Omega$ $50k\Omega \leq R < 100k\Omega$ $100k\Omega \leq R$	70dB min. 80dB min. 90dB min. 100dB min.		
	Insulation resistance	100MΩ min. 250V DC				RK163: 100MΩ min. 500V DC RK168: 100MΩ min. 250V DC
	Voltage proof	300V AC (for 1minute)				RK163: 500V AC for minute RK168: 300V AC for minute
Mechanical performance	Total rotational angle	300±5°	300±5° (Shaft movement type is 300 \pm 5°)		300 \pm 10°	RK163: 300±3° RK168: 300±5°
	Rotational torque	2 to 25mN·m		5 to 20mN·m	7.5±3.5mN·m	RK163: 3 to 25mN·m RK168: 10 to 40mN·m
	Stopper strength	0.5N·m (With push-lock mechanism type: 0.4N·m)			0.5N·m	0.9N·m
	Push-pull strength	80N max.	100N max.			
	Vibration	10 to 55 to 10Hz/min., the amplitude is 1.5mm for all the frequencies, in the 3 direction of X, Y and Z and for 2 hours respectively				
	Solder heat resistance	Manual soldering	350°C max. 3s max.			350±10°C 3 \pm 0s
Dip soldering		260±5°C, 5±1s				
Reflow soldering					Please see P.35	
Endurance	Operating life	15,000cycles				
Environmental performance	Cold	-20°C±2°C for 96h	-30±2°C for 96h		-40±2°C for 240h	-20±2 for 96h
	Dry heat	70±2°C for 96h			85±2°C for 240h	70±2°C for 96h
	Damp heat	40±2°C, 90 to 95%RH for 96h			60±2°C, 90 to 95%RH for 240h	40±2°C, 90 to 95%RH for 96h

Push-on Switch Specifications

Items	RK097		RK117		RK119	
Contact arrangement	Single pole and single throw (Push on)					
Travel (mm)	0.5	1.5	0.5	1.5	0.5±0.3	1.5±0.5
Operating force (N)	4 \pm 2	5±2	6±3	5±2		4±2
Rating	0.5A 12V DC		3A 16V DC		0.1A 5V DC (1mA 5V DC min.ratings)	0.5A 16V DC (1mA 16V DC min.ratings)
Contact resistance	100mΩ for initial period; 200mΩ after operating life					
Operating life	10,000 times min.	20,000 times min.	10,000 times min.	20,000 times min.	100,000 times min.	20,000 times min.

Note

The operating temperature range for automotive applications can be raised upon request. Please contact us for requirements of this kind.

Attached Parts

The following parts are included with the product.

Unit:mm

Applicable products	Bearing screw diameter	Hexagonal nut	Flat washer
RK09L RK168 RK097 RK203	M9		
RK271	M8		
RK097 RK098 RK163	M7		
RK097 RK098	M6		

Rotary Potentiometers

Slide Potentiometers

Multi Control Devices

Sensors

Metal Shaft

Insulated Shaft

Hollow Type

Knob Operating