

**Green Pt** Conductive Plastic Linear Sensor

<RoHS Compliance>

# LP-F series

### FEATURES

- Light Weight
- Low friction.

### DIMENSION (mm)

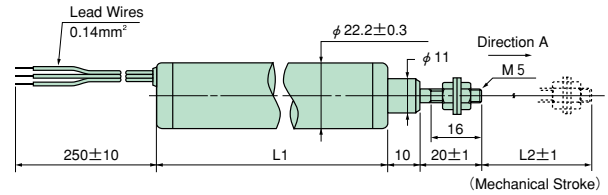

### MOUNTING

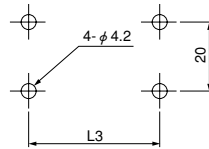

### MTG Holes Spacing

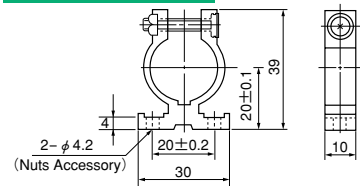

### Housing Length · Mounting

Model No.	LP-100F-C	LP-150F-C	LP-200F-C	LP-250F-C	LP-300F-C
Housing Length(L1)	138±1mm	188±1mm	238±1mm	288±1mm	338±1mm
Mech. Stroke(L2)	103±1mm	153±1mm	203±1mm	253±1mm	303±1mm
MTG Holes Spacing(L3)	124mm	174mm	224mm	274mm	324mm

### Electrical Specifications

Model No.	LP-100F-C	LP-150F-C	LP-200F-C	LP-250F-C	LP-300F-C
Electrical Stroke	100mm±0.5mm	150mm±0.5mm	200mm±1mm	250mm±1mm	300mm±1mm
Total Resistance	1, 2, 5, 10kΩ	1, 2, 5, 10kΩ	1, 2, 5, 10kΩ	2, 5, 10kΩ	2, 5, 10kΩ
Total Resistance Tolerance	±20%				
Independent Linearity	±0.3%				
Power Rating	2W / 70°C	3W / 70°C	4W / 70°C	4W / 70°C	4W / 70°C
Output Smoothness	0.1% / MAX.				
Insulation Resistance	100MΩ MIN.DC500V				
Dielectric Strength	AC500V 1 Minute				
TC of Resistance	±400ppm / °C				

### Mechanical Specifications

Friction	1N MAX.				
Weight	Approx. 110g	Approx. 140g	Approx. 170g	Approx. 200g	Approx. 230g

### Environmental Specifications

Operating Temperature	-25~80°C
Vibration	100m / s <sup>2</sup> 500Hz 3 axis 2hours each
Shock	500m / s <sup>2</sup> 11ms 6 axis 3times
Life Cycle	5M Cycles MIN.

### OPTIONS

- 2 sections
- Independent Linearity : ±0.1%

### SCHEMATIC

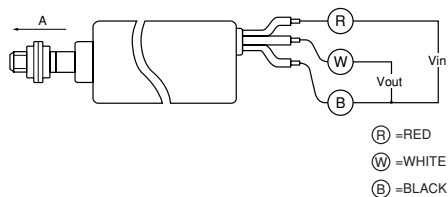

Red, White and Black indicate harness colors

### OUTPUT CHARACTERISTICS

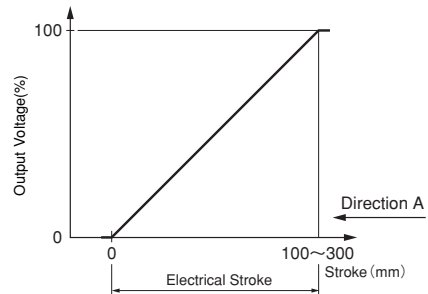

### MOUNTING HARDWARE

- 4-M4 Nuts
- 2-M5 Nuts, 2-Lock Washers