

REF. NO: MPCL 98CAT PG72

REVISION

C.O.N	SYM	DESCRIPTION	DATE	DRAWN	APPR'D
	A	"SEAL COMPLIANCE:IP54" WAS "SEAL: WATERPROOF".	08/10/03	TSUGAWA	

**GENERAL:**

MODEL LP-50FBS-8 IS A WATERPROOFED, CONDUCTIVE PLASTIC, LINEAR MOTION POTENTIOMETER, WITH AN INTERNAL RETURN SPRING. ITS STURDY AND PRECISION CONSTRUCTION ALLOWS UNIT TO BE SUITABLE FOR APPLICATIONS IN WET, OILY DUSTY OPERATING ENVIRONMENTS.

**ELECTRICAL SPECIFICATIONS:**

ELECTRICAL STROKE:	50 mm
TOTAL RESISTANCE:	0.5, 1, 2, 5 KOHMS
TOTAL RESIS. TOLERANCE:	±20%
LINEARITY (INDEPENDENT):	±0.5%
REPEATABILITY:	±0.005%
POWER RATING:	1.5 WATTS @70°C
RESISTANCE TEMP. COEFFICIENT:	400 ppm/°C
INSULATION RESISTANCE:	100 meg OHMS MIN. @500 Vdc
DIELECTRIC STRENGTH:	500 Vrms,50/60Hz,for 1 MINUTE

**MECHANICAL SPECIFICATIONS:**

MECHANICAL STROKE:	( 50 ±1 ) mm
FRICTION (SPRING FORCE):	1.6 kgf MAX.
MOUNTING HOLES:	REFER TO FIGURE 1

**ENVIRONMENTAL SPECIFICATIONS:**

OPERATING TEMPERATURE:	-40° TO +100°C
VIBRATION:	10 Gs, 500 Hz
SHOCK:	50 Gs, 11 mS
LIFE:	5 MILLION CYCLES MIN.
① SEAL COMPLIANCE:	IP54

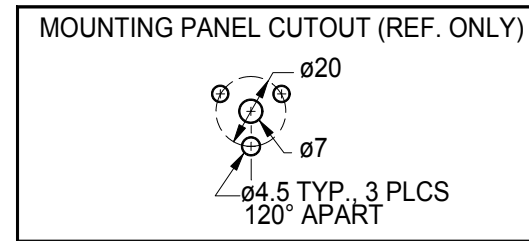
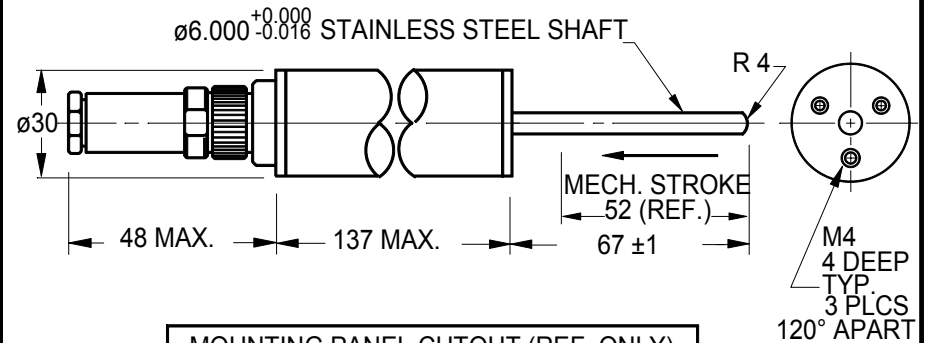

FIGURE 1 OUTLINE DIMENSIONS

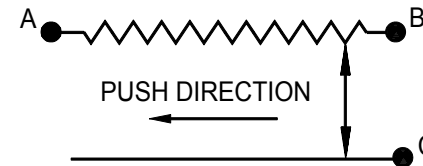

FIGURE 2 SCHEMATIC

UNLESS OTHERWISE SPECIFIED, DIMENSIONS ARE IN mm(in).  
 TOLERANCES:  
 ANGLES ±1.5°  
 ≤10 mm: ±0.25  
 <100 mm: ±0.5  
 ≥100 mm: ±1

DRAWN	T.TSUGAWA	DATE	08/11/98
CHECKED		DATE	
APPROVED		DATE	
APPROVED		DATE	
SCALE:		FILE:	LP-50FBS-8

SPECIFICATION DWG  
 FOR  
**MODEL LP-50FBS-8**  
 SEALED, LINEAR POT.  
 ( WITH RETURN SPRING )

<b>Midori America Corporation</b> <small>FULLERTON, CA</small>	
<b>B-MAC-B24</b>	<b>A</b>
1 OF 1	