

The multi-axis controller VV6 is a rugged switching device according IEC 947-5-1 EN 60947 DIN VDE 0660-200 for hoisting applications. The modular design enables the switching device to be used universally. The VV6 is resistant to oil, maritime climate ozone and UV radiation.

**Contact complement** 2 A 250 V AC 15 res. 1 A 24 V DC 13 (standard) or 4 A 250 V AC 15 (special)

Mechanical life 20 million (operating cycles)  
Permissible ambient temperature Operation -40° C to +60° C  
Storage -50° C to +80° C

Climate resistance  
Damp heat constant DIN IEC 68 part 2-3  
Damp heat cyclic DIN IEC 68 part 2-30  
Degree of protection front IP 54 IEC 529 DIN 40050  
Technical data look catalog 5/100

Spindle block with schematic representation of the master controller installation and deflection directions. Version shown for Left-hand side installation (right-hand side installation is mirror image).

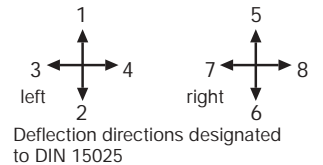

| Pos. | VV 61   | VV 61.1 | VV 62 | VV 64 | VV 64.1 | Type              | Weight gramm | Price EURO |
|------|---|---------|-------|-------|---------|-------------------|--------------|------------|
| 1    |   |         |       |       |         | VV 61             | 960          |            |
| 2    |   |         |       |       |         | VV 61.1           | 980          |            |
| 3    |   |         |       |       |         | VV 62             | 900          |            |
| 4    |   |         |       |       |         | VV 64             | 1010         |            |
| 5    |   |         |       |       |         | VV 64.1           | 960          |            |
| 10   | Gate cross-shaped (prohibits diagonal shifting)   |         |       |       |         | P                 | 60           |            |
| 11   | Gate special-shaped (for e. H-gate)   |         |       |       |         | P                 | 60           |            |
| 12   | Spring return in 0-position (for each direction)  |         |       |       |         | Z                 | 110          |            |
| 13   | Friktion brake (for each direction)   |         |       |       |         | R                 | 30           |            |
| 14   |   |         |       |       |         |                   |              |            |
| 20   | Control-handle with knob solid  |         |       |       |         | M                 | 50           |            |
| 21   | Control-handle with latch for mechanical zero interlock   |         |       |       |         | T                 | 100          |            |
| 22   | Control-handle with dead man's button 1 NO  |         |       |       |         | H                 | 100          |            |
| 23   | Control-handle with signal button 1 NO  |         |       |       |         | D                 | 110          |            |
| 24   | Control-handle with push button 1 NO  |         |       |       |         | DV                | 110          |            |
| 25   | Control-handle with flat push button 1 NO   |         |       |       |         | B 1               | 40           |            |
| 26   | Control handle with palm grip B 1   |         |       |       |         | B 1T              | 60           |            |
| 27   | Control handle with palm grip B 1 with push button top 1 NO   |         |       |       |         |                   |              |            |
| 28   | Control handle long or short 200, 160 mm  |         |       |       |         |                   |              |            |
| 29   | More knobs, grips and T-grips with and without signal devices look catalog 1/280...   |         |       |       |         |                   |              |            |
| 30   | Masterswitch switching sequence 4-0-4   |         |       |       |         | No. of contacts 2 | 01           | 290        |
| 31   |   |         |       |       |         | 4                 | 02           | 350        |
| 32   | Direction 1-2 and 3-4 each 1 masterswitch   |         |       |       |         | 6                 | 03           | 410        |
| 33   | Switching program according contact-arrangement MS... look catalog 5/001  |         |       |       |         | 8                 | 04           | 470        |
| 34   | or to your contact-arrangement  |         |       |       |         | 10                | 05           | 530        |
| 35   |   |         |       |       |         | 12                | 06           | 590        |
| 36   | Switching sequence 5-0-5 or 6-0-6   |         |       |       |         |                   |              |            |
| 40   | Potentiometer e.t.c. each masterswitch with mounted Wire-wound potentiometer T 130, with centre tap linear Life 10' switching cycle resistance 2 x 0,5/1/2/5/10 kOhm, 1,5 Watt wiper current max. 10 mA |         |       |       |         | P                 | 70           |            |
| 41   | Prepared for mounting potentiometer shaft 6 mm adjusting-angle 2 x 150°   |         |       |       |         | (P)               |              |            |
| 42   | Prepared for mounting potentiometer e.t.c. adjusting-angle variable.  |         |       |       |         | (P)               |              |            |
| 43   | more Potentiometer e.t.c. look catalog 1/240...   |         |       |       |         |                   |              |            |
| 50   | Steel sheet housing B 200 masterswitch max. size 05   |         |       |       |         | B                 | 1300         |            |
| 51   | Steel sheet housing B 230x440 masterswitch max. size 07   |         |       |       |         | B                 | 1600         |            |
| 52   | More housing look catalog 1/250   |         |       |       |         |                   |              |            |
| 60   | Indicating labels not engraved with 2 or 4 arrows   |         |       |       |         |                   |              |            |
| 61   | Engraved each 10 characters   |         |       |       |         |                   |              |            |
| 62   |   |         |       |       |         |                   |              |            |
| 70   | Command and indicating devices look catalog 1/260   |         |       |       |         |                   |              |            |



T = dead man's button  
H = signal button  
M = latch for mechanical zero interlock

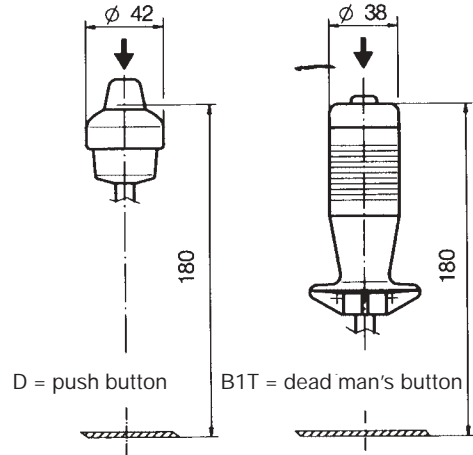
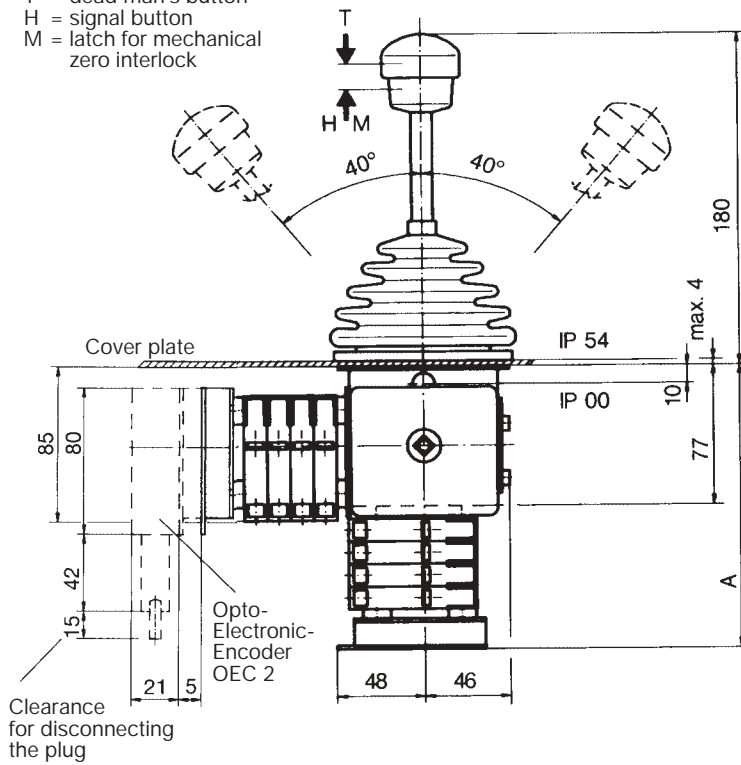

| Type | No. of contacts | Dimension A | Dimension B |
|------|-----------------|-------------|-------------|
| 01   | 2               | 119         | 82          |
| 02   | 4               | 131         | 94          |
| 03   | 6               | 144         | 107         |
| 04   | 8               | 156         | 119         |
| 05   | 10              | 169         | 132         |
| 06   | 12              | 181         | 144         |

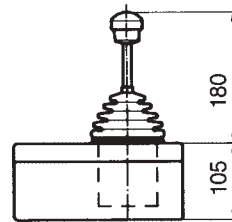
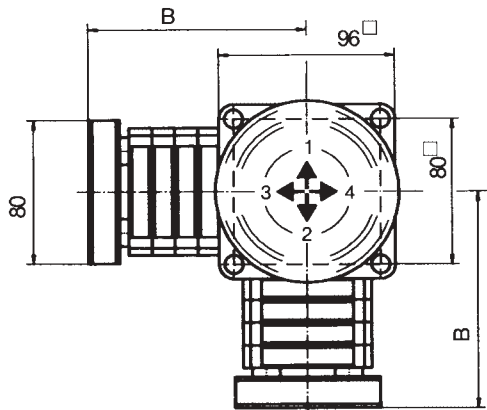

Steel sheet housing

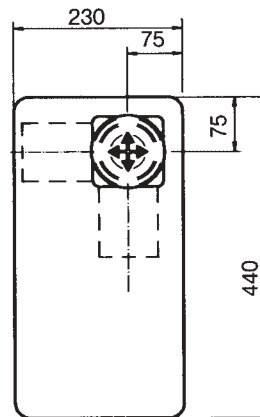
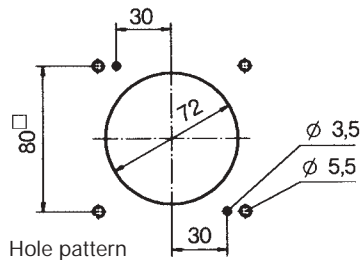

Example for type-sign

- Steel sheet housing
- Multi-axis controller
- Gate
- Dead man's button
- Masterswitch direction 1-2

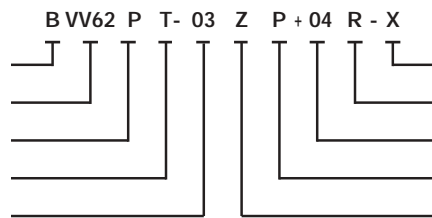

- Special please to describe
- Friction brake direction 3-4
- Masterswitch direction 3-4
- Potentiometer e.t.c. direction 1-2
- Spring return direction 1-2