



The multi-axis controller V 10 is a rugged switching device according IEC 947-5-1 EN 60947 DIN VDE 0660-200 for remote control and electro-hydraulic applications.

The V 10 is resistant to oil, maritime climate ozone and UV radiation.

Contact complement 0,5 A 110 V AC 15 res. 1,5 A 24 V DC 13

I min > 0,2 mA 2 V DC 12 Gold plated for max. load of 0,12 Watt (standard)

or I max < 300 mA 0,4 V DC 12 max. capacity 0,12 Watt do not exceed!

I min >0,2 mA 2 V DC 12 max. contact reliability for very low current (special)

Mechanical life 6 million (operating cycles)

Permissible ambient temperature Operation -40° C to + 60° C

Storage -50° C to + 80° C

Climate resistance

Damp heat constant

Damp heat cyclic

Degree of protection front

Technical data

Description data look catalog 5/002

DIN IEC 68 part 2-3

DIN IEC 68 part 2-30

IP 54 IEC 529 DIN 40050

look catalog 5/100 1

Spindle block with schematic representation of the master controller installation and deflection directions.

Version shown for Left-hand side installation

(right-hand side installation is mirror image).

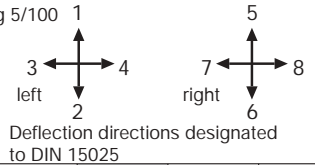

Pos.	V 10.1	V 10	Type	Weight gramm	Price EURO
1			V 10.1	200	
2					
3			V 10	250	
4					
5					
10	Gate cross-shaped	(prohibits diagonal shifting)	P	20	
11	Gate special-shaped	(for e. H-gate)	P	20	
12	Spring return in 0-position	(include in the spindle block)	Z		
13	Friction brake	(for each direction)	R		
14					
20	Control-handle with knob solid				
21	Control-handle with latch for mechanical zero interlock		M	50	
22	Control-handle with dead man's button	1 NO	T	80	
23					
24					
25					
26	Control-handle with palm grip B 5		B 5	40	
27	Control-handle with palm grip B 5 with push button top	1 NO	B 5D	60	
28					
29	More knobs, grips and T-grips with and without signal devices	look catalog 1/280...			
30	Masterswitch without switching sequence	No. of contacts 2	01	20	
31		4	02	40	
32	Direction 1-2 and 3-4 each 1 masterswitch	6	03	60	
33	Switching program according contact-arrangement MS...	look catalog 5/001			
34	or to your contact-arrangement				
35					
36	Switching sequence 4-0-4				
40	Potentiometer e.t.c. each masterswitch with mounted				
41	Conductive-plastic-potentiometer T 320, with centre tap linear	Life 10 ⁷ switching cycles	P	20	
42	resistance 2 x 5 kOhm, 0,5 Watt wiper current max. 1 mA				
43	more Potentiometer e.t.c. look catalog 1/240...				
50	Plastic housing I 122 x 120		I	350	
51					
52	More housing look catalog 1/250				
56	Platine with Can-Bus System look catalog 3/504				
60	Indicating labels not engraved with 2 or 4 arrows				
61	Engraved each 10 characters				
62					
70	Command and indicating devices look catalog 1/260				



Knob solid

T = dead man's button

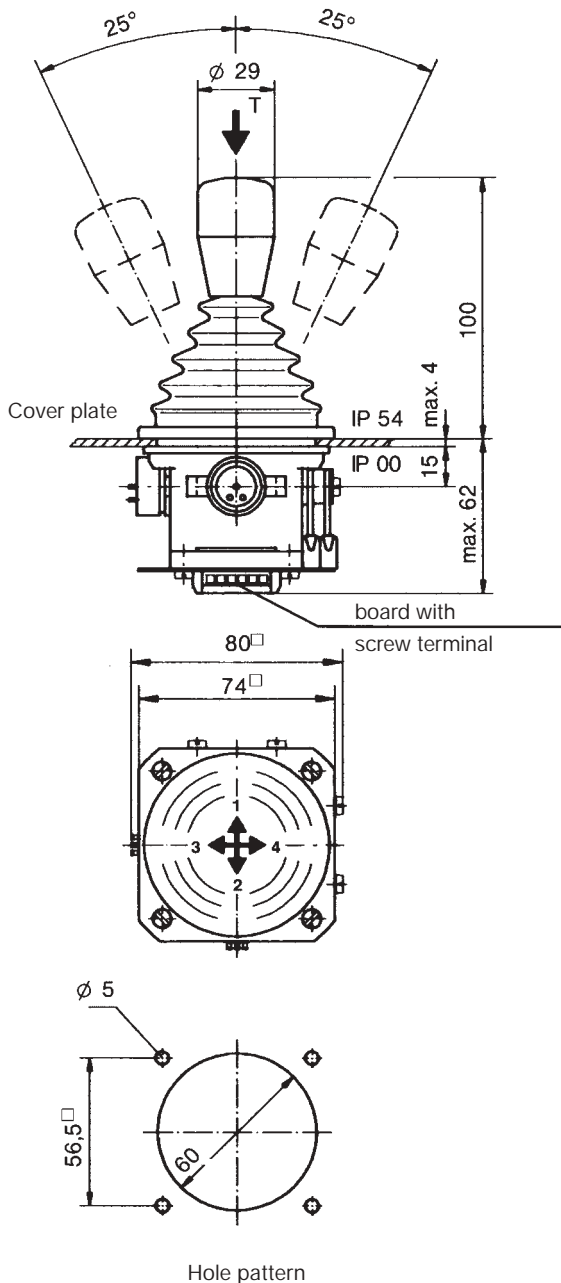

ball grip

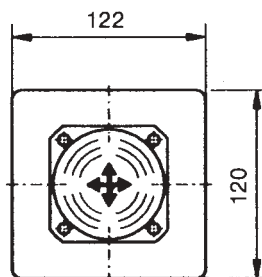
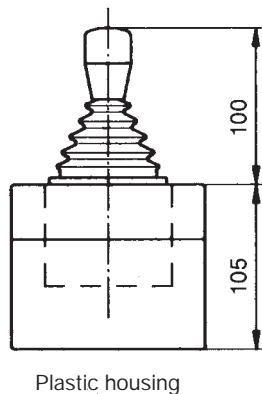
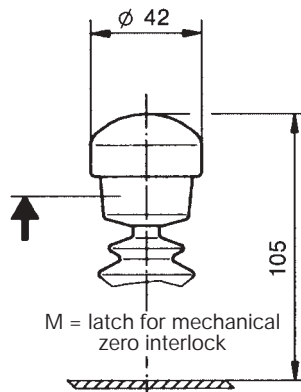

palm grip B 5

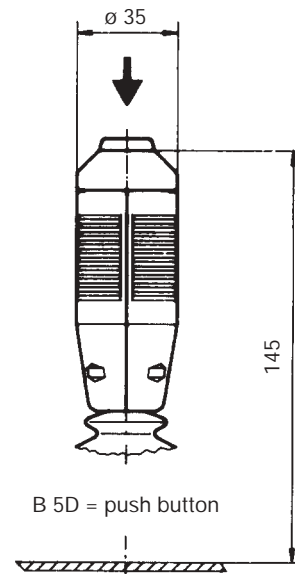

Example for type-sign

Plastic housing

Multi-axis controller

Gate

Dead man's button

Masterswitch direction 1-2

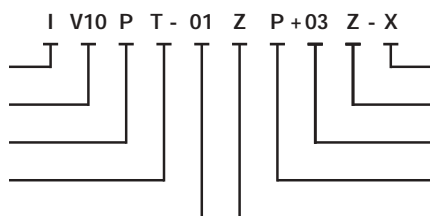

Special please to describe

Spring return direction 3-4

Masterswitch direction 3-4

Potentiometer e.t.c. direction 1-2

Spring return direction 1-2