

<p>ALL RIGHTS RESERVED. NO PORTION OF THIS PUBLICATION, WHETHER IN WHOLE OR IN PART CAN BE REPRODUCED WITHOUT THE EXPRESS WRITTEN CONSENT OF SPC TECHNOLOGY.</p> <p>SPC-F005.DWG</p>	REVISIONS					DOC. NO. SPC-F005 * Effective: 7/8/02 * DCP No: 1398					
	DCP #	REV	DESCRIPTION			DRAWN	DATE	CHECKD	DATE	APPRVD	DATE
	1933	A	RELEASED			EO	09/07/06	SA	09/13/06	HO	09/13/06

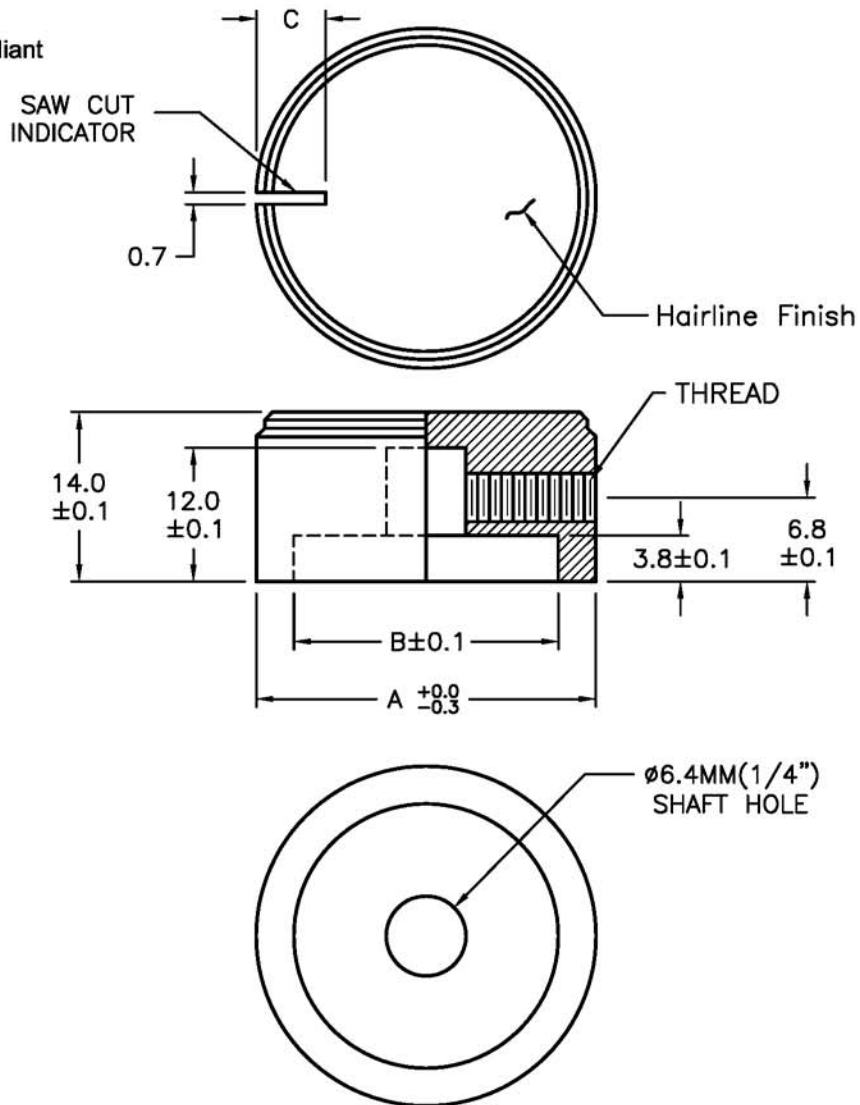

RoHS
Compliant



NOTE: INCLUDES ONE SET SCREW

	DIMENSIONS			Set Screw	FINISH ANODIZED
	A	B	C		
1023	16.0	12.0	4.0	M4X4	Silver
1024	22.0	16.0	5.0	M4X6	
1025	28.0	22.0	5.5	M4X6	
1026	16.0	12.0	4.0	M4X4	Black
1027	22.0	16.0	5.0	M4X6	
1028	28.0	22.0	5.5	M4X6	

DISCLAIMER:
ALL STATEMENTS AND TECHNICAL INFORMATION CONTAINED HEREIN ARE BASED UPON INFORMATION AND/OR TESTS WE BELIEVE TO BE ACCURATE AND RELIABLE. SINCE CONDITIONS OF USE ARE BEYOND OUR CONTROL, THE USER SHALL DETERMINE THE SUITABILITY OF THE PRODUCT FOR THE INTENDED USE AND ASSUME ALL RISK AND LIABILITY WHATSOEVER IN CONNECTION THEREWITH.

TOLERANCES:

UNLESS OTHERWISE SPECIFIED, DIMENSIONS ARE FOR REFERENCE PURPOSES ONLY.

DRAWN BY:

EKLAS ODISH

DATE:

09/07/06

CHECKED BY:

SAMI ALNADI

DATE:

09/13/06

APPROVED BY:

HISHAM ODISH

DATE:

09/13/06

DRAWING TITLE:

Solid Aluminum Knobs, Plain Sides Machined Finish

SIZE

A

DWG. NO.

ELECTRONIC FILE

REV

A

SCALE: NTS

U.O.M.: MILLIMETERS

SHEET: 1 OF 1