

# MODEL OFCP50

● Wirewound ● Servomount ● RoHS Compliant

## ● Standard Dimensions



Model OFCP50

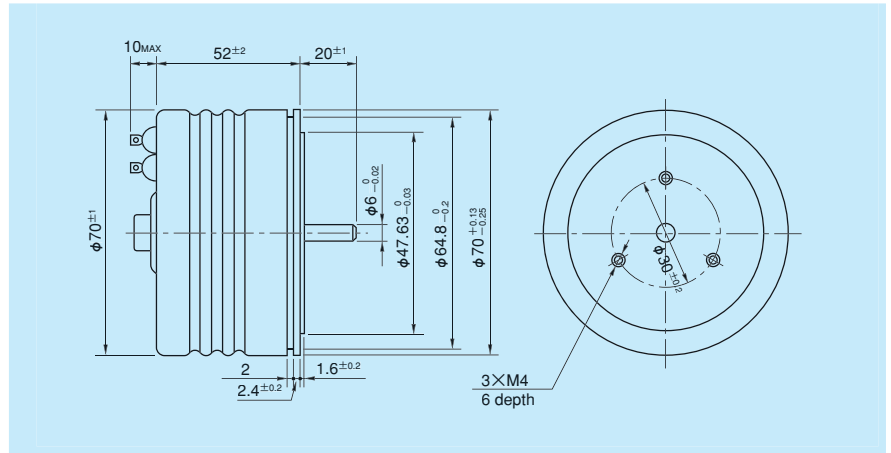

## ● General Specifications

<b>Standard Resistance Range</b>	1kΩ to 50kΩ
<b>Total Resistance Tolerance</b>	Standard Class ±3% (H) Precision Class ±1% (F)
<b>Independent Linearity Tolerance</b>	Standard Class ±0.5% Precision Class ±0.1% (±0.2% in case of within 2kΩ)
<b>Power Rating</b>	1.5W
<b>Noise</b>	Within 100Ω E.N.R.

<b>Electrical Travel</b>	355° ±3°
<b>Mechanical Travel</b>	360° (Endless)
<b>Insulation Resistance</b>	Over 100MΩ at 1,000V.D.C.
<b>Dielectric Strength</b>	1 minute at 1,000V.A.C.
<b>Starting Torque</b>	Within 30mN · m (300gf · cm)
<b>Resistance Temperature Coefficient</b>	±20p.p.m./°C
<b>Mass</b>	Approx. 500g

## ● Standard Resistance Values ■ No. of Wire Turns ■ Resistance Wire Used

Resist. Value (Ω)	1k	2k	5k	10k	20k	50k
No. of Wire Turns	1,000	1,250	1,810	2,180	2,780	3,500
Resist. Wire Used	Ni-Cr System					

## ● Special Specifications Available

(In case of the potentiometer with special specifications, the general specifications and environmental specifications may change. Please consult us in advance.)

- Special lower practical resistance values (50Ω to 500Ω)
- Extra taps (Available up to 3 taps)
- With stopper (Rotating angle is 330° and the stopper strength is 0.9N · m [9kgf · cm])
- Special electrical travel
- Shaft dia. (φ 6.35mm) with inch dimension
- Special machining on the shaft
- Shaft with front and rear extension (Rear shaft with 6mm dia. and 20mm length)