

MODEL OF20HHP

- Hybrid
- Bushingmount
- Servomount
- RoHS Compliant



Model OF20HHP-10S

● Standard Dimensions

■ Bushingmount Type

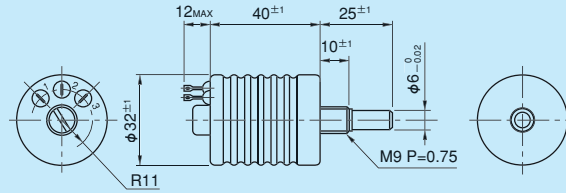

Note: 1 pc. inner teeth washer and 2 pcs. hex nuts are attached.

■ Servomount Type

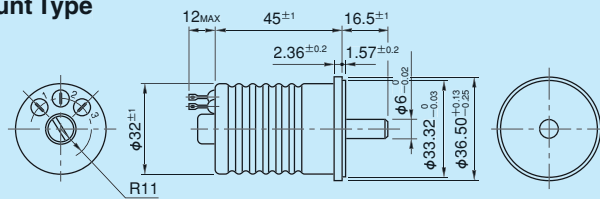

Wirewound type is also available. (For the characteristics, please refer to model 20HP)

● Standard Model Numbers

Bushingmount type	
10-turn models	OF20HHP-10S
Servomount type	
10-turn models	OF20HHP-10S

● General Specifications

Standard Resistance Values	2k, 5k, 10k, 20k, 50k, 100k (Ω)
Total Resistance Tolerance	Standard Class ±10% (K) Precision Class ±5% (J)
Independent Linearity Tolerance	Standard Class ±0.25% Precision Class ±0.1%
Resolution	Essentially infinite
Output Smoothness	Within 0.015% against input voltage
Contact Resistance Variation	Within 3% C.R.V.
Power Rating	2.0W

Electrical Travel	3,600° ±5°
Mechanical Travel	3,600° +10° 0°
Insulation Resistance	Over 100MΩ at 1,000V.D.C.
Dielectric Strength	1 minute at 1,000V.A.C.
Starting Torque	Within 20mN · m (200gf · cm)
Stopper Strength	Approx. 0.9N · m (9kgf · cm) (Bushingmount type) Approx. 0.6N · m (6kgf · cm) (Servomount type)
Resistance Temperature Coefficient	±100p.p.m./°C
Mass	Approx. 100g

● Special Specifications Available

- Extra tap (Available up to 1 tap)
- 5-turn type
- Shaft dia. (φ 6.35mm) & bushing with inch dimension
- Special machining on the shaft
- Wirewound resistive element type (Model OF20HP and OF20HPS. For technical details of these types, please refer to those of models 20HP and 20HPS in this catalog.)

(In case of the potentiometer with special specifications, the general specifications and environmental specifications may change. Please consult us in advance.)