

Conductive Plastic Angle Sensor

# CP-45F Series - CP-45FRBN



- Conductive Plastic Angle Sensor
- Effective Electrical Travel : 350°
- Independent Linearity : ±0.1%
- Screw Mount
- IP54
- 【Options】
- Additional Center Tap :
  - C.T(A) ... No shorted angle
  - C.T(B) ... Shorted on Tap (Shorted angle 1~5°)
- 【Material】
- Housing : Aluminum
- Shaft : Stainless Steel
- Bearing : Stainless steel

## Dimension [mm]

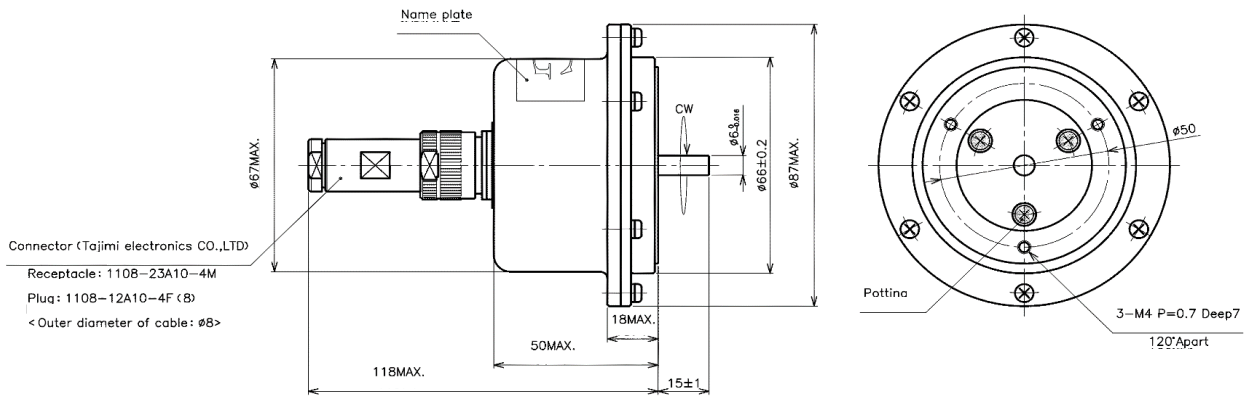

## Output Characteristics

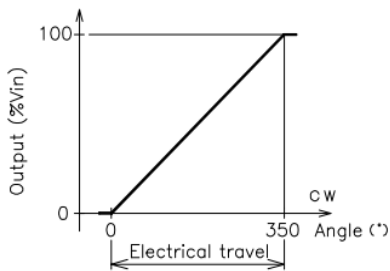

## Schematic

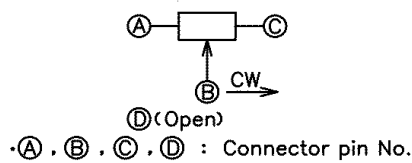

## Mounting

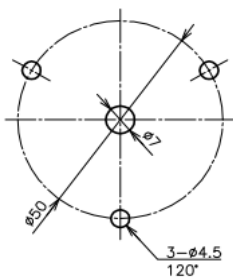

Screw Mount

<b>【Model No.】</b>	CP-45FRBN
--------------------	-----------

**【Electrical Data】**

Effective Electrical Travel	350 +2, -3	°
Total Resistance	1, 2, 5, 10 (Option: 0.5, 20)	kΩ
Total Resistance Tolerance	±15	%
Independent Linearity	±0.1	%
Power Rating	3/70°C	W
Output Smoothness	MAX. 0.1	%
Insulation Resistance	MIN. 100/DC1000V	MΩ
Dielectric Strength	AC1000/1min.	V
Temperature Coefficient Of Resistance	±400	ppm/K

**【Mechanical Data】**

Total Mechanical Travel	360 Endless	°
Torque	MAX. 25	mN·m
Thrust Load Tolerance	2	N
Radial Load Tolerance	4	N
Mass	600 Approx.	g
IP Rating	IP54	

**■ Accessories**

Connector plug:TAJIMI ELECTRICS  
 Model TC1108-12A10-4F8  
 Applicable cable φ8

**■ Handling Instruction**

·To avoid burnout of resistive element, do not supply more than 1mA current to terminal 2.