

# Full range of products tool book

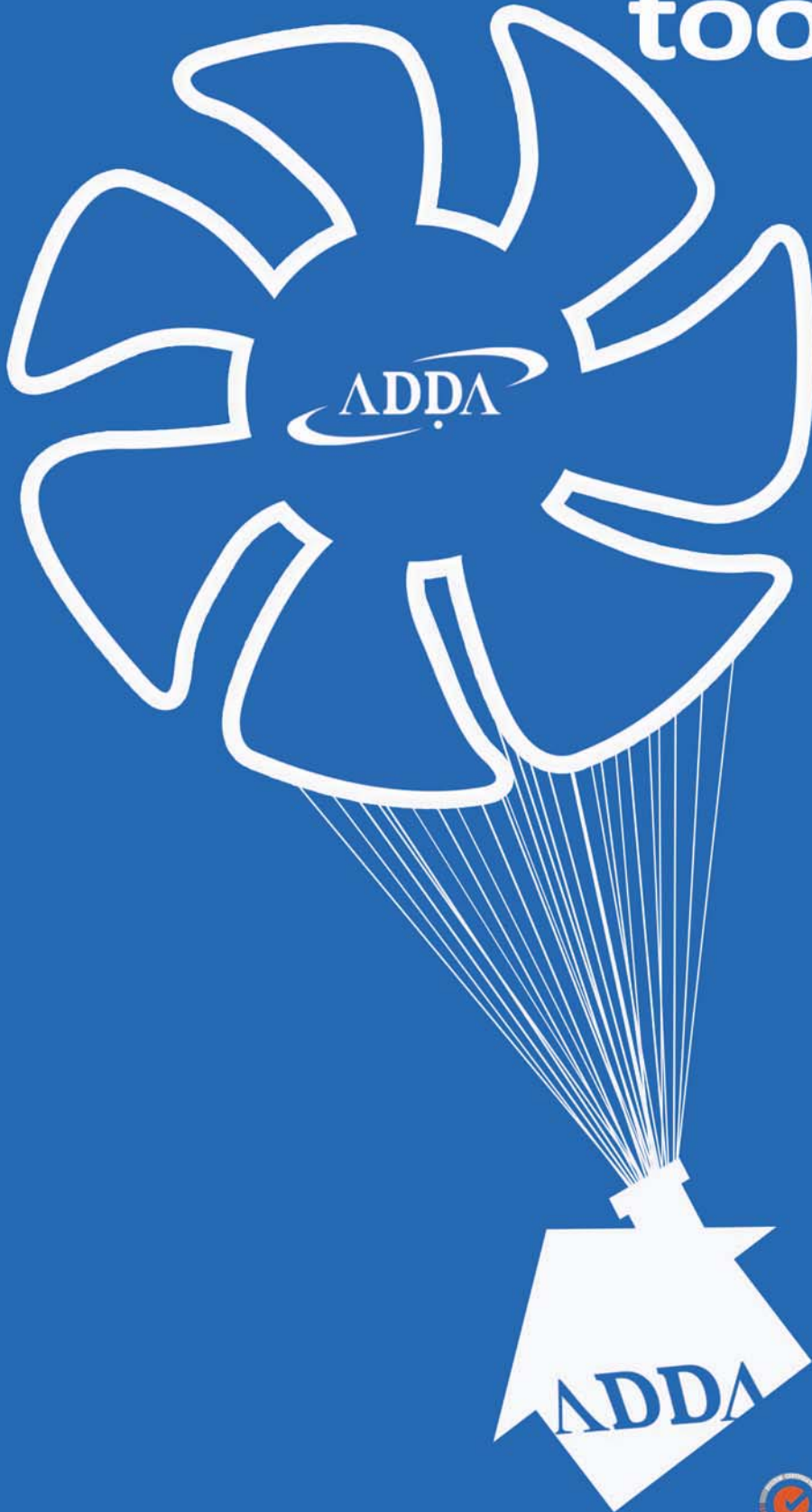

IECQ OC080000

ADDA CORP.  
REGISTERED FIRM  
CERTIFICATE NO. 0000000000

# Index

## Stable & Cool

- 01 Index
- 02 Home application
- 04 IPC application
- 05 Medical Equipment application
- 06 Cloud computing application
- 07 Thermal module application
- 08 AC Fan application
- 09 DC Fan Model Numbering Scheme
- 10 DC Fan
  - 31 DC Fan Signal Control Models
- 39 Blower Fan
- 42 DC Chip cooler Fan
- 43 Waterproof and Dustproof Fan
- 44 AC Fan Model Numbering Scheme
- 45 AC FAN
- 48 Fan accessories
  - 48 Metal Finger Guard
  - 49 Plastic Filters
  - 50 Plugs & Cables
- 51 Global Locations
- 52 Honors & Certifications

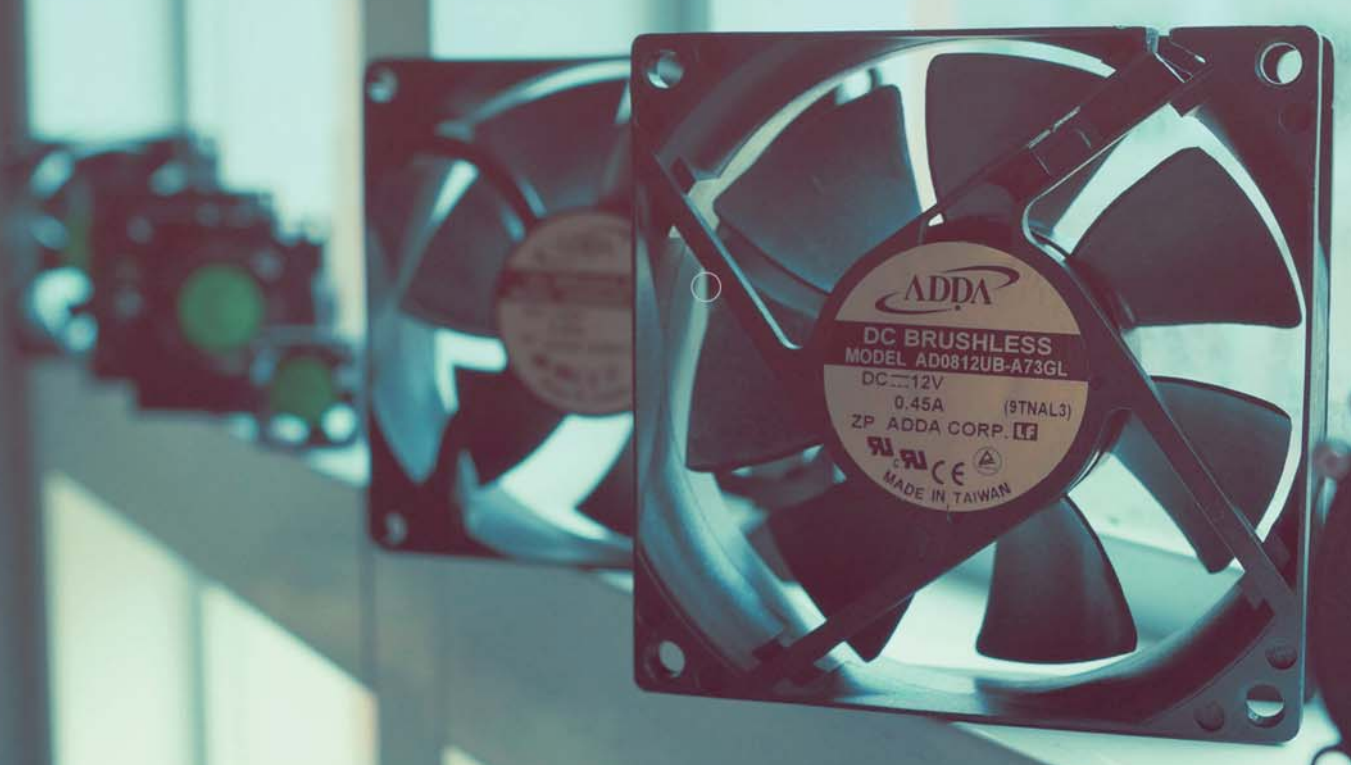

# DC <sup>AC</sup> fan Thermal Module Chip Cooler

## Life with ADDA!

2013 ADDA Concepts

- Home Application
- Industrial PC system

- **ADDA Promises**  
Full range products  
State-of-the-art technology  
Prompt & Excellent services
- **Where Can You find ADDA fan?**  
Home, Gaming, Medical Electronic, Automation,  
Digital Signage, Transportation, Networking ect...
- **Every Green Fan in ADDA!**

# HOME

Living Room

Kitchen

Car Industry



Living Room



Car Industry



**LCD TV**  
AD4010



**Projector**  
AD7015



Kitchen



**Micro Projector**  
AD2010



**Refrigerator**  
AD1225



**Air Filter**  
AD12025



**Car Audio**  
AD4510



**Game Machine**  
AB5510



**Oven**  
AB12032



**Monitor**  
AD4020



**Automotive Air Conditioner**  
AS14051



**Audio Equipment**  
AD8025



**Coffee Machine**  
AD4010



**High Power Intercom**  
AD4010



**Set-up Box (STB)**  
AD5015



**Dish Washer**  
AQ7530



**Seat Cushion**  
AD5015



The fan size for reference only, for more information please contact with our ADDA sales representative. Thanks!!



computer  
telecom  
application

industrial & life  
automation

Medical Electronic

Digital Signage

ATM

Kiosk

Networking

internet  
application

Transportation

Automation

Energy

industrial  
automation

# IPC

Cooling fan products for Industrial PC appliance.



AD0612HB-A73GL



AG12024XB257100(OKU)



AB05124UB150100



AD0412VB-B5BDS(HFP)



AD0812XX-A74GL(N)

2013  
**MEDICAL  
 EQUIP.**  
 SERIES



AD0612HB-A71GL



AD0312LB-G50



AD0412LX-G76(T)



AD0612HB-A70GL(T)



Laparoscope



Supersonic



Electrocardiograph



X-ray machine

# Cloud Computing

Telecom & Server



**FOR 1U SERVER**

 **AD4028**  
AD04012UB285300(00LAP)



Energy Saving **76.9%**  
Super Silent **12.4%**

**FOR 1U SERVER**

**AS4056**  
AS04012UB565BA2



High Pressure **49.4%**  
High Air Flow **7.4%**

**FOR 2U SERVER**

**AS6038**  
AS06012UB385BB0



High Air Flow **25%**  
Energy Saving **41.1%**

**FOR 2U SERVER**

**AS8038**  
AS08012HB385BB1



High Pressure **118.6%**  
Energy Saving **6.4%**

**FOR 2U SERVER**

**AS8038**  
AS08012HB385BB2



High Pressure **95.4%**  
High Air Flow **5.3%**

**FOR MORE THAN 2U SERVER**

**AS9238**  
AS09212UB389BB0



High Pressure **35%**

**FOR MORE THAN 2U SERVER**

**AS14038**  
AS14012XB387BB0



High Pressure **18%**  
Energy Saving **5%**

**FOR MORE THAN 2U SERVER**

**AS10451**  
AS14048UB519BB0



High Pressure **39.2%**  
High Air Flow **15.5%**

**Thermal module cooler**



**TDP 135W~140W**





2012 Taiwan Excellence Award



Cooler Monster

# Thermal Module

**Cloud Server**  
cooler



**TDP** Thermal Design Power  
**135W~140W**



**Notebook**  
stamping plate

**LED Industry**  
stamping fin, heatpipe,  
soldering



**Profile Projector**  
stamping fin, heatpipe  
extrusion heatsink  
soldering



**Telecommunication**  
extrusion heatsink



**AIO**  
stamping fin, heatpipe,  
stamping plate, soldering



**Graphic Card**  
stamping fin  
heatpipe  
diecasting heatsink  
soldering



**Copy Machine**  
extrusion heatsink





# AC in water

- ▶ Passed the salt spray test.
- ▶ Parylene coating technology.
- ▶ High-performance packaging & infusion technology.
- ▶ Used at harsh environment.



## OSmart<sup>®</sup> AC FAN

### Patent



(M410115)



(3174467)



(ZL201120564116.X)



(202011109335.7)



## OSmart AC Fan applications

### Commercial

Oven

Commercial Freezer

Freeze Cabinet



### Industrial

Power Backup Station

Industry Power Supply Rack

Uninterruptible Power System

Power Welding Machine



### Latest Technology

Solar Thermal Power Plant System

Automation Controller Box

Electrical Car Charger



- ▶ Low noise.
- ▶ Reasonable cost.
- ▶ Lower power consumption.
- ▶ Low-speed operation.
- ▶ RPM adjustable with temperature sensor.
- ▶ Customize RPM.

# DC fan

Old

New

AD|06|12|H|X - A|7|3|GL

① ② ③ ④ ⑤ ⑥ ⑦ ⑧ ⑨

## ① AD

AB=Blower AD=Dc Axial Fan  
AP=Chip Cooler AQ=Waterproof Fan

## ② 06- Frame Size

15=15mm 20=20mm 02=25mm 03=30mm  
35=35mm 04=40mm 45=45mm 50=50mm  
06=60mm 07=70mm 08=80mm 09=92mm  
12=120mm 17=172mm  
A= 01mm B= 02mm C= 03mm D= 04mm E= 05mm  
F= 06mm G= 07mm H= 08mm J= 09mm K= 10mm  
L= 11mm M= 12mm N= 13mm P= 14mm S= 17mm  
T= 18mm U= 19mm V= 20mm W= 21mm X= 22mm  
Y= 23mm Z= 24mm

## ③ 12-Voltage

05=5VDC 12=12VDC 24=24VDC 48=48VDC

## ④ H-Speed

D= Ultra Low L= Low M= Medium  
H= High U= Ultra High  
V= Max. High Speed  
X= Over Ultra High

## ⑤ X-Bearing Type

B=Ball bearing S=Sleeve bearing  
X=Hypro

## ⑥ A-Thickness

A=25mm B=28mm C=20mm D=15mm  
E=12mm F=38mm G=10mm H=13mm  
J= 8mm K= 6mm L=14mm M=23mm  
P=18mm Q= 7mm R= 9mm S=16mm  
T=11mm V= 4mm Y=32mm Z=33mm

## ⑦ 7-Impeller number

5= 5 blades 7= 7 blades 9= 9 blades  
A=11 blades B=13 blades C=15 blades  
D=17 blades E=19 blades F=21 blades  
0=Blower blade shape

## ⑧ 3-Function

0=By impedance 1=By IC 2=RD  
3=FG  
4=By IC with variable speed sensor(VS)  
6=By transistor FG 7=two speed  
8=VS+FG 9=PWM control  
A=VS+RD B=PWM+FG C=RD+FG

## ⑨ GL-Fan type

GL=Low Noise  
Blank=Standard  
GP=Great Performance  
DS=Dynamic & Static

AD|040|05|H|B|56|7|3|00

① ② ③ ④ ⑤ ⑥ ⑦ ⑧ ⑨

## ① AD

AB=Blower AS=Dynamic Static Strc.  
AD=Dc Axial Fan AY=Rib Fan/no heat sink  
AG=Great Performance  
AP=Chip Cooler  
AQ=Waterproof Fan  
AR=Round Frame

## ② 040- Frame Size

1mmx1mm ~ 999mmx999mm

## ③ 05-Voltage

03=3VDC 05=5VDC 12=12VDC  
24=24VDC 48=48VDC

## ④ H-Speed

D=Ultra low L=Low  
M=Medium H=High  
U=Ultra High X=Over Ultra High  
V=Max. High Speed E=Over Max. High Speed

## ⑤ B-Bearing Type

B=Two Ball S=Sleeve  
X=Hypro F=FDB

## ⑥ 56-Thickness

00mm~99mm / A0=100mm /  
B0=110mm / C0=120mm

## ⑦ 7-Impeller number

5= 5 blades 7= 7 blades 9= 9 blades  
A=11 blades B=13 blades C=15 blades  
D=17 blades E=19 blades F=21 blades  
0=Blower blade shape  
M=Multiple Fan

## ⑧ 3-Function

0=By impedance 1=By IC 2=RD  
3=FG  
4=By IC with variable speed sensor(VS)  
6=By transistor FG  
7=two speed  
8=VS+FG  
9=PWM control  
A=VS+RD  
B=PWM+FG  
C=FG+RD

## ⑨ 00-Randomize

# DC Fan

- AD 15mm ~ 172mm / Thickness : min 06mm ~ max 51mm
- AS 40mm ~ 140mm / Thickness : min 28mm ~ max 76mm
- AG 20mm ~ 127mm / Thickness : min 10mm ~ max 38mm



80x80x76



40x40x28

Bearing type: ●=Ball ※=Sleeve ○=1B1S ●=Hypro Bearing

	Frame size (mm)	Model No.	Bearing Type	Rated Voltage (VDC)	Current (A)	Power (W)	Rated Speed (RPM)	Maximum AirFlow (CMM) (CFM)	Maximum Pressure (InAq) (mmAq)	*Noise Level (dB/A)	Weight (g)
AD1506-9	15x15x06	AD1505LX-K90(X)	●	5	0.04	0.18	9000	0.002 0.10	0.02 0.508	10.0	1.4
	15x15x06	AD1505MX-K90(X)	●	5	0.04	0.20	12000	0.004 0.16	0.03 0.762	12.0	1.4
	15x15x06	AD1505HX-K90(X)	●	5	0.05	0.25	15000	0.005 0.20	0.07 1.727	24.3	1.4
AD2006-7	20x20x06	AD2005DX-K70(X)	○●	5	0.06	0.28	7000	0.01 0.30	0.02 0.51	12.0	4
	20x20x06	AD2005LX-K70(X)	○●	5	0.10	0.48	10500	0.01 0.50	0.05 1.27	20.0	4
AD2010(T)-7	20x20x10	AD2005LB-G70(T)	◎●	5	0.06	0.30	9000	0.01 0.50	0.04 1.02	15.0	6
	20x20x10	AD2005MB-G70(T)	◎●	5	0.09	0.47	11500	0.02 0.60	0.06 1.52	22.0	6
AD2010-7	20x20x10	AD2012LB-G70	◎●	12	0.04	0.50	9000	0.01 0.50	0.04 1.02	15.0	6
	20x20x10	AD2012MB-G70	◎●	12	0.05	0.60	11500	0.02 0.60	0.06 1.52	22.0	6
AG2010-7	20x20x10	AG02005LX107100	◎●	5	0.08	0.39	12000	0.04 1.50	0.21 5.33	23.0	4.8
	20x20x10	AG02005MX107100	◎●	5	0.09	0.45	14000	0.05 1.80	0.25 6.35	26.0	4.8
	20x20x10	AG02005HX107100	◎●	5	0.15	0.75	16000	0.06 2.16	0.38 9.68	29.4	4.8
AD2506-5	25x25x06	AD0205DX-K50(X)	○●	5	0.05	0.26	7000	0.04 1.40	0.06 1.52	14.0	5
	25x25x06	AD0205LX-K50(X)	○●	5	0.09	0.43	9000	0.05 1.80	0.11 2.79	21.5	5
	25x25x06	AD0205MX-K50(X)	○●	5	0.11	0.57	12000	0.07 2.40	0.19 4.70	29.0	5
	25x25x06	AD0205HX-K50(X)	○●	5	0.15	0.74	14000	0.07 2.60	0.20 5.08	35.0	5
	25x25x06	AD0212LX-K50(X)	○●	12	0.05	0.55	9000	0.05 1.80	0.11 2.79	21.5	5
	25x25x06	AD0212MX-K50(X)	○●	12	0.06	0.72	12000	0.07 2.40	0.19 4.70	29.0	5
AD2510	25x25x10	AD0205LB-G50(GLT)	◎●	5	0.08	0.40	8000	0.05 1.60	0.09 2.29	18.3	8
	25x25x10	AD0205MB-G50(GLT)	◎●	5	0.09	0.45	10000	0.06 2.10	0.15 3.81	23.0	8
AD2510GL-5	25x25x10	AD0212DB-G50(GL)	◎●	12	0.04	0.48	6000	0.03 1.10	0.04 1.02	12.5	8
	25x25x10	AD0212LB-G50(GL)	◎●	12	0.05	0.54	8000	0.05 1.60	0.09 2.29	18.3	8
	25x25x10	AD0212MB-G50(GL)	◎●	12	0.06	0.72	10000	0.06 2.10	0.15 3.81	23.0	8
AD2515-5	25x25x15	AD0205LX-D50(X)	◎	5	0.04	0.20	5000	0.03 1.12	0.03 0.76	14.0	8
	25x25x15	AD0205MX-D50(X)	◎	5	0.05	0.25	6000	0.04 1.48	0.05 1.37	17.5	8
	25x25x15	AD0205HX-D50(X)	◎	5	0.11	0.55	8000	0.05 1.60	0.11 2.90	20.0	8
	25x25x15	AD0205HX-D51(X)	◎	5	0.07	0.35	8000	0.05 1.60	0.11 2.90	20.0	8
AD3006-7	30x30x06	AD0305DX-K70(X)	○●	5	0.05	0.25	6000	0.06 2.00	0.06 1.52	18.0	6
	30x30x06	AD0305LX-K70(X)	○●	5	0.06	0.32	7500	0.07 2.40	0.08 2.03	22.0	6
	30x30x06	AD0305MX-K70(X)	○●	5	0.10	0.52	9000	0.08 3.00	0.11 2.79	26.5	6
	30x30x06	AD0305HX-K70(X)	○●	5	0.12	0.60	10500	0.10 3.50	0.15 3.81	32.0	6
	30x30x06	AD0312LX-K70(X)	○●	12	0.04	0.46	7500	0.07 2.40	0.08 2.03	22.0	6
	30x30x06	AD0312HX-K70(X)	○●	12	0.06	0.77	10500	0.10 3.50	0.15 3.81	32.0	6
AD3010(T)-5	30x30x10	AD0305DB-G50(T)	◎●	5	0.05	0.25	6000	0.06 2.00	0.06 1.52	19.0	8
	30x30x10	AD0305LB-G50(T)	◎●	5	0.07	0.35	8000	0.08 3.00	0.12 2.92	26.0	8



40x40x56



120x120x38



60x60x25



140x140x51

\*:Noise is measured at the distance of 1 meter from the axis of intake.  
Specifications are subject to change without prior notice.

Bearing type: ○=Ball ※=Sleeve ◐=1B1S ●=Hypro Bearing

	Frame size (mm)	Model No.	Bearing Type		Rated Voltage (VDC)	Current (A)	Power (W)	Rated Speed (RPM)	Maximum AirFlow (CMM) (CFM)		Maximum Pressure (InAq) (mmAq)		*Noise Level (dB/A)	Weight (g)
AD3010(T)-5	30x30x10	AD0305MB-G50(T)	○	●	5	0.10	0.51	9000	0.09	3.30	0.15	3.76	30.0	8
	30x30x10	AD0305HB-G50(T)	○	●	5	0.11	0.55	10500	0.11	4.00	0.20	5.08	34.0	8
AD3010-5	30x30x10	AD0312DB-G50	○	●	12	0.04	0.42	6000	0.06	2.00	0.06	1.52	19.0	8
	30x30x10	AD0312LB-G50	○	●	12	0.05	0.60	8000	0.08	3.00	0.12	2.92	26.0	8
	30x30x10	AD0312MB-G50	○	●	12	0.06	0.72	9000	0.09	3.30	0.15	3.76	30.0	8
	30x30x10	AD0312HB-G50	○	●	12	0.07	0.84	10500	0.11	4.00	0.20	5.08	34.0	8
AG3010-5	30x30x10	AG03005LX105100	○	●	5	0.07	0.35	6500	0.10	3.46	0.10	2.51	17.5	6.5
	30x30x10	AG03005MX105100	○	●	5	0.11	0.55	8000	0.12	4.34	0.14	3.48	22.3	6.5
	30x30x10	AG03005HX105100	○	●	5	0.13	0.65	9500	0.15	5.45	0.20	5.18	29.0	6.5
	30x30x10	AG03012HX105100	○	●	12	0.12	1.44	11000	0.17	5.85	0.24	6.10	32.0	6.5
AD3015-5	30x30x15	AD0305LB-D50	○		5	0.06	0.31	4500	0.06	2.20	0.05	1.14	14.0	10
	30x30x15	AD0305MB-D50	○		5	0.07	0.36	5500	0.07	2.60	0.07	1.88	16.0	10
	30x30x15	AD0305HB-D50	○		5	0.12	0.60	7000	0.10	3.70	0.11	2.79	22.5	10
AD3506-7	35x35x06	AD3505LX-K70(X)	○●		5	0.07	0.35	6500	0.10	3.50	0.08	2.03	24.0	7
	35x35x06	AD3505MX-K70(X)	○●		5	0.12	0.60	8000	0.12	4.20	0.10	2.54	33.0	7
	35x35x06	AD3512LX-K70(X)	○●		12	0.05	0.55	6500	0.10	3.50	0.08	2.03	24.0	7
	35x35x06	AD3512MX-K70(X)	○●		12	0.05	0.59	8000	0.12	4.20	0.10	2.54	33.0	7
AD3510(T)-5	35x35x10	AD3505DB-G50(T)	○	●	5	0.04	0.21	4500	0.08	3.00	0.05	1.27	17.0	9
	35x35x10	AD3505LB-G50(T)	○	●	5	0.09	0.44	7000	0.14	5.00	0.10	2.54	28.0	9
	35x35x10	AD3505MB-G50(T)	○	●	5	0.13	0.63	8000	0.17	6.00	0.17	4.32	32.0	9
	35x35x10	AD3505HB-G50(T)	○	●	5	0.15	0.73	9500	0.20	7.20	0.20	5.08	36.0	9
AD3510-5	35x35x10	AD3512LB-G50	○	●	12	0.05	0.60	7000	0.14	5.00	0.10	2.54	28.0	9
	35x35x10	AD3512MB-G50	○	●	12	0.06	0.66	8000	0.17	6.00	0.17	4.32	32.0	9
	35x35x10	AD3512HB-G50	○	●	12	0.09	1.08	9500	0.20	7.20	0.20	5.08	36.0	9
AG3510-5	35x35x10	AG03512MX105300		●	12	0.07	0.84	7500	0.18	6.30	0.14	3.56	27.0	9
	35x35x10	AG03512HX105300		●	12	0.12	1.42	9500	0.21	7.50	0.22	5.59	35.0	9
AD3828DS-5	38x38x28	AD3812UB-B5BDS(P)	○		12	0.18	2.16	10000	0.37	13.20	0.76	19.30	45.5	40
	38x38x28	AD3812XB-B5BDS(P)	○		12	0.40	4.80	13000	0.50	17.50	1.29	32.77	52.0	40
	38x38x28	AD3812VB-B5BDS(P)	○		12	0.45	5.40	15000	0.57	20.00	1.68	42.67	54.0	40
AD3828GP-5	38x38x28	AD3812MB-B51GP(TP)	○		12	0.11	1.32	7000	0.21	7.50	0.26	6.60	28.5	38
	38x38x28	AD3812HB-B51GP(TP)	○		12	0.22	2.64	9000	0.28	10.00	0.44	11.18	38.5	38
	38x38x28	AD3812UB-B51GP(TP)	○		12	0.29	3.48	11000	0.35	12.40	0.66	16.76	41.0	38
	40x40x06	AD0405LX-K90(X)	○●		5	0.04	0.20	4800	0.12	4.22	0.05	1.22	22.0	9
AD4006-9	40x40x06	AD0405MX-K90(X)	○●		5	0.07	0.35	5800	0.14	5.10	0.07	1.78	27.6	9
	40x40x06	AD0405HX-K90(X)	○●		5	0.10	0.50	6600	0.16	5.80	0.09	2.29	31.0	9

# DC Fan

- AD 15mm ~ 172mm / Thickness : min 06mm ~ max 51mm
- AS 40mm ~ 140mm / Thickness : min 28mm ~ max 76mm
- AG 20mm ~ 127mm / Thickness : min 10mm ~ max 38mm



80x80x76



40x40x28

Bearing type: ◎=Ball ※=Sleeve ○=1B1S ●=Hypro Bearing

	Frame size (mm)	Model No.	Bearing Type	Rated Voltage (VDC)	Current (A)	Power (W)	Rated Speed (RPM)	Maximum AirFlow (CMM)	Maximum AirFlow (CFM)	Maximum Pressure (InAq)	Maximum Pressure (mmAq)	*Noise Level (dB/A)	Weight (g)
AD4006-9	40x40x06	AD0412LX-K90(X)	○●	12	0.04	0.48	4800	0.12	4.22	0.05	1.22	22.0	9
	40x40x06	AD0412MX-K90(X)	○●	12	0.05	0.60	5800	0.14	5.10	0.07	1.78	27.6	9
	40x40x06	AD0412HX-K90(X)	○●	12	0.06	0.72	6600	0.16	5.80	0.09	2.29	31.0	9
AG4010-7	40x40x10	AG04012DB107100	◎●	12	0.05	0.60	4000	0.12	4.20	0.06	1.52	15.0	17
	40x40x10	AG04012LB107100	◎●	12	0.06	0.72	5000	0.15	5.46	0.09	2.18	23.2	17
	40x40x10	AG04012MB107100	◎●	12	0.07	0.84	6000	0.19	6.81	0.12	3.05	26.5	17
	40x40x10	AG04012HB107100	◎●	12	0.08	0.96	7000	0.23	8.04	0.16	4.14	31.0	17
	40x40x10	AG04012UB107100	◎●	12	0.10	1.20	8000	0.26	9.21	0.20	5.08	35.7	17
	40x40x10	AG04012XB107100	◎●	12	0.13	1.56	9000	0.29	10.31	0.23	5.94	37.2	17
	40x40x10	AG04012VB107100	◎●	12	0.17	2.04	10000	0.32	11.40	0.33	8.43	39.1	17
AD4010(T)-7	40x40x10	AD0405DB-G70(T)	◎※○●	5	0.05	0.25	3300	0.09	3.30	0.04	1.12	14.0	17
	40x40x10	AD0405LB-G70(T)	◎※○●	5	0.07	0.35	4200	0.12	4.20	0.06	1.52	21.0	17
	40x40x10	AD0405MB-G70(T)	◎※○●	5	0.11	0.55	4800	0.14	5.00	0.08	1.98	22.0	17
	40x40x10	AD0405HB-G70(T)	◎※○●	5	0.16	0.80	6000	0.18	6.20	0.10	2.54	26.0	17
	40x40x10	AD0405UB-G70(T)	◎※○●	5	0.19	0.95	6800	0.20	7.00	0.17	4.32	29.0	17
	40x40x10	AD0412DB-G70(T)	◎※○●	12	0.04	0.48	3300	0.09	3.30	0.04	1.12	14.0	17
	40x40x10	AD0412LB-G70(T)	◎※○●	12	0.06	0.72	4200	0.12	4.20	0.06	1.52	21.0	17
	40x40x10	AD0412MB-G70(T)	◎※○●	12	0.06	0.72	4800	0.14	5.00	0.08	1.98	22.0	17
	40x40x10	AD0412HB-G70(T)	◎※○●	12	0.09	1.08	6000	0.18	6.20	0.10	2.54	26.0	17
	40x40x10	AD0412UB-G70(T)	◎※○●	12	0.09	1.08	6800	0.20	7.00	0.17	4.32	29.0	17
	40x40x10	AD0424LB-G70(T)	◎※○●	24	0.03	0.72	4200	0.12	4.20	0.06	1.52	21.0	17
	40x40x10	AD0424MB-G70(T)	◎※○●	24	0.04	0.96	4800	0.14	5.00	0.08	1.98	22.0	17
40x40x10	AD0424HB-G70(T)	◎※○●	24	0.06	1.44	6000	0.18	6.20	0.10	2.54	26.0	17	
40x40x10	AD0424UB-G70(T)	◎※○●	24	0.08	1.92	6800	0.20	7.00	0.17	4.32	29.0	17	
AD4010-7	40x40x10	AD0405LB-G70(8)	◎※○●	5	0.07	0.35	4200	0.12	4.20	0.06	1.52	21.0	17
	40x40x10	AD0405MB-G70(8)	◎※○●	5	0.11	0.55	4800	0.14	5.00	0.08	1.98	22.0	17
	40x40x10	AD0405HB-G70(8)	◎※○●	5	0.16	0.80	6000	0.18	6.20	0.10	2.54	26.0	17
	40x40x10	AD0412LB-G70(8)	◎※○●	12	0.06	0.72	4200	0.12	4.20	0.06	1.52	21.0	17
	40x40x10	AD0412MB-G70(8)	◎※○●	12	0.06	0.72	4800	0.14	5.00	0.08	1.98	22.0	17
	40x40x10	AD0412HB-G70(8)	◎※○●	12	0.09	1.08	6000	0.18	6.20	0.10	2.54	26.0	17
	40x40x10	AD0424LB-G70(8)	◎※○●	24	0.03	0.72	4200	0.12	4.20	0.06	1.52	21.0	17
	40x40x10	AD0424MB-G70(8)	◎※○●	24	0.04	0.96	4800	0.14	5.00	0.08	1.98	22.0	17
40x40x10	AD0424HB-G70(8)	◎※○●	24	0.06	1.44	6000	0.18	6.20	0.10	2.54	26.0	17	
AD4015-5	40x40x15	AD0412LB-D51	◎	12	0.07	0.84	6000	0.18	6.47	0.16	4.09	25.8	27
	40x40x15	AD0412MB-D51	◎	12	0.09	1.08	7000	0.22	7.60	0.20	5.08	31.8	27



40x40x56



120x120x38



60x60x25



140x140x51

\*:Noise is measured at the distance of 1 meter from the axis of intake.  
Specifications are subject to change without prior notice.

Bearing type: ◎=Ball ※=Sleeve ○=1B1S ●=Hypro Bearing

	Frame size (mm)	Model No.	Bearing Type	Rated Voltage (VDC)	Current (A)	Power (W)	Rated Speed (RPM)	Maximum AirFlow (CMM) (CFM)	Maximum Pressure (InAq) (mmAq)	*Noise Level (dB/A)	Weight (g)
<b>AD4015-5</b>	40x40x15	AD0412HB-D51	◎	12	0.11	1.32	8000	0.24 8.48	0.25 6.32	36.0	27
	40x40x15	AD0412LB-D71GP(P)	◎	12	0.12	1.44	7000	0.25 9.00	0.27 6.86	31.5	24
<b>AD4015GP-7</b>	40x40x15	AD0412MB-D71GP(P)	◎	12	0.16	1.92	8300	0.30 10.60	0.38 9.65	37.0	24
	40x40x15	AD0412UB-D71GP(P)	◎	12	0.19	2.28	9500	0.34 12.10	0.51 12.95	40.5	24
<b>AG4015-7</b>	40x40x15	AD0412UB-D71GP(P)	◎	12	0.23	2.76	11000	0.40 14.20	0.66 16.76	44.0	24
	40x40x15	AG04012LB157300	◎	12	0.07	0.84	7000	0.27 9.36	0.22 5.69	33.2	21
	40x40x15	AG04012MB157300	◎	12	0.09	1.08	8000	0.30 10.56	0.29 7.29	36.9	21
	40x40x15	AG04012HB157300	◎	12	0.12	1.44	9000	0.34 11.99	0.35 8.94	39.6	21
	40x40x15	AG04012UB157300	◎	12	0.17	2.04	10000	0.38 13.31	0.42 10.69	41.7	21
<b>AD4020GP-7</b>	40x40x20	AG04012XB157300	◎	12	0.21	2.52	11000	0.42 14.69	0.52 13.08	43.5	21
	40x40x20	AD0412LB-C73GP(P)	◎	12	0.08	0.96	5000	0.18 6.40	0.15 3.81	19.0	28
	40x40x20	AD0412MB-C73GP(P)	◎	12	0.12	1.44	6200	0.23 8.00	0.23 5.84	26.0	28
	40x40x20	AD0412HB-C73GP(P)	◎	12	0.14	1.68	7200	0.27 9.40	0.32 8.13	30.0	28
	40x40x20	AD0412UB-C73GP(P)	◎	12	0.15	1.80	8200	0.31 11.00	0.40 10.16	33.0	28
<b>AD4020(T)-5</b>	40x40x20	AD0412XB-C73GP(P)	◎	12	0.24	2.88	10000	0.37 13.00	0.54 13.72	42.0	28
	40x40x20	AD0405DB-C50(T1)	◎※ ●	5	0.09	0.45	4200	0.13 4.49	0.08 2.03	17.5	28
	40x40x20	AD0405LB-C50(T1)	◎※ ●	5	0.14	0.70	6200	0.20 7.00	0.17 4.19	30.0	28
	40x40x20	AD0405MB-C50(T1)	◎※ ●	5	0.16	0.80	6900	0.22 7.74	0.20 5.08	33.0	28
	40x40x20	AD0405HB-C50(T1)	◎※ ●	5	0.25	1.25	7800	0.25 8.80	0.28 7.11	36.0	28
	40x40x20	AD0412DB-C50(T1)	◎※ ●	12	0.04	0.48	4200	0.13 4.49	0.08 2.03	17.5	28
	40x40x20	AD0412LB-C50(T1)	◎※ ●	12	0.07	0.84	6200	0.20 7.00	0.17 4.19	30.0	28
	40x40x20	AD0412MB-C50(T1)	◎※ ●	12	0.08	0.96	6900	0.22 7.74	0.20 5.08	33.0	28
	40x40x20	AD0412HB-C50(T1)	◎※ ●	12	0.10	1.20	7800	0.25 8.80	0.28 7.11	36.0	28
	40x40x20	AD0412UB-C50(T1)	◎※ ●	12	0.14	1.68	8500	0.27 9.58	0.32 8.13	37.5	28
	40x40x20	AD0424DB-C50(T1)	◎※ ●	24	0.14	1.68	4200	0.13 4.49	0.08 2.03	17.5	28
	40x40x20	AD0424LB-C50(T1)	◎※ ●	24	0.05	1.20	6200	0.20 7.00	0.17 4.19	30.0	28
	40x40x20	AD0424MB-C50(T1)	◎※ ●	24	0.06	1.44	6900	0.22 7.74	0.20 5.08	33.0	28
	40x40x20	AD0424HB-C50(T1)	◎※ ●	24	0.07	1.68	7800	0.25 8.80	0.28 7.11	36.0	28
<b>AG4020-5</b>	40x40x20	AD0412XB205100	◎	12	0.11	1.32	8500	0.31 11.00	0.28 7.01	35.0	28
	40x40x20	AG04012VB205100	◎	12	0.22	2.64	10000	0.43 15.10	0.45 11.43	39.4	28
<b>AD4028-3</b>	40x40x28	AD0412DB-B31	◎	12	0.05	0.60	4500	0.17 5.90	0.09 2.27	19.2	38
	40x40x28	AD0412LB-B31	◎	12	0.08	0.96	6000	0.22 7.70	0.17 4.32	32.0	38
	40x40x28	AD0412MB-B31	◎	12	0.10	1.20	7500	0.27 9.60	0.22 5.59	34.6	38
	40x40x28	AD0412HB-B31	◎	12	0.16	1.92	9000	0.35 12.20	0.35 8.76	39.0	38
	40x40x28	AD0412UB-B31	◎	12	0.20	2.40	10000	0.37 13.10	0.45 11.43	42.5	38

# DC Fan

- AD 15mm ~ 172mm / Thickness : min 06mm ~ max 51mm
- AS 40mm ~ 140mm / Thickness : min 28mm ~ max 76mm
- AG 20mm ~ 127mm / Thickness : min 10mm ~ max 38mm



80x80x76



40x40x28

Bearing type: ◎=Ball ※=Sleeve ○=1B1S ●=Hypro Bearing

	Frame size (mm)	Model No.	Bearing Type	Rated Voltage (VDC)	Current (A)	Power (W)	Rated Speed (RPM)	Maximum AirFlow (CMM) (CFM)	Maximum Pressure (InAq) (mmAq)	*Noise Level (dB/A)	Weight (g)
<b>AD4028-3</b>	40x40x28	AD0424HB-B31	◎	24	0.08	1.92	8100	0.31 10.80	0.27 6.96	36.2	38
<b>AD4028DS-5</b>	40x40x28	AD0412HB-B5BDS(HFP)	◎	12	0.30	3.60	11000	0.51 18.10	0.87 22.10	48.0	42
	40x40x28	AD0412UB-B5BDS(HFP)	◎	12	0.40	4.80	13000	0.62 22.00	1.20 30.48	52.5	42
	40x40x28	AD0412XB-B5BDS(HFP)	◎	12	0.60	7.20	15000	0.71 25.20	1.60 40.64	56.0	42
	40x40x28	AD0412VB-B5BDS(HFP)	◎	12	0.73	8.76	16000	0.76 27.00	1.85 46.99	58.0	42
<b>AD4028GP-5</b>	40x40x28	AD0412MB-B53GP(P)	◎	12	0.14	1.68	8000	0.31 11.00	0.34 8.51	36.0	38
	40x40x28	AD0412HB-B53GP(P)	◎	12	0.16	1.92	9000	0.37 13.00	0.41 10.49	41.0	38
	40x40x28	AD0412UB-B53GP(P)	◎	12	0.30	3.60	11000	0.45 16.00	0.63 16.00	45.0	38
	40x40x28	AD0412XB-B53GP(P)	◎	12	0.45	5.40	13000	0.54 19.00	0.87 22.00	49.0	38
<b>AD4028LAP-5</b>	40x40x28	AD04012DB285300(OOLAP)	◎	12	0.13	1.56	8000	0.25 8.75	0.43 10.95	27.4	57
	40x40x28	AD04012LB285300(OOLAP)	◎	12	0.21	2.52	11000	0.36 12.63	0.72 18.39	36.8	57
	40x40x28	AD04012MB285300(OOLAP)	◎	12	0.32	3.84	14000	0.45 15.89	1.24 31.50	46.6	57
	40x40x28	AD04012HB285300(OOLAP)	◎	12	0.50	6.00	16500	0.54 19.23	1.71 43.51	48.8	57
	40x40x28	AD04012UB285300(OOLAP)	◎	12	0.60	7.20	18000	0.59 20.72	1.95 49.50	50.8	57
<b>AS4028LAP-5</b>	40x40x28	AS04012DB2856A0(OOLAP)	◎	12	0.15	1.80	10000	0.31 10.95	0.69 17.53	40.3	41
	40x40x28	AS04012LB2856A0(OOLAP)	◎	12	0.16	1.92	11000	0.34 12.08	0.85 21.59	43.9	41
	40x40x28	AS04012MB2856A0(OOLAP)	◎	12	0.20	2.40	12000	0.38 13.41	1.00 25.40	46.3	41
	40x40x28	AS04012HB2856A0(OOLAP)	◎	12	0.26	3.12	13000	0.42 14.77	1.16 29.46	48.5	41
<b>AD4048DS-5</b>	40x40x48	AD0412UB-N5BDS(48P)	◎	12	0.85	10.20	in:12800/ out:10200	0.71 25.20	1.20 30.48	59.0	74
	40x40x48	AD0412XB-N5BDS(48P)	◎	12	1.00	12.00	in:14000/ out:11000	0.76 27.00	1.41 35.81	60.5	74
<b>AS4056-5</b>	40x40x56	AS04012XB565B00	◎	12	1.00	12.00	in:16000/ out:8000	0.78 27.50	2.00 50.80	60.5	84
<b>AS4056-5</b>	40x40x56	AS04012LB565B01	◎	12	0.80	9.60	in:14000/ out:13000	0.69 24.27	1.58 40.13	62.3	103
	40x40x56	AS04012MB565B01	◎	12	1.00	12.00	in:15000/ out:14000	0.78 27.42	1.82 46.33	63.6	103
	40x40x56	AS04012HB565B01	◎	12	1.10	13.20	in:16000/ out:15000	0.83 29.47	2.11 53.47	65.0	103
	40x40x56	AS04012UB565B01	◎	12	1.30	15.60	in:17000/ out:16000	0.90 31.70	2.49 63.17	66.1	103
<b>AS4056-5</b>	40x40x56	AS04012LB565BA2	◎	12	1.03	12.36	In:16500/ Out:21000	0.82 28.80	2.68 67.95	71.0	103



40x40x56



120x120x38



60x60x25



140x140x51

\*:Noise is measured at the distance of 1 meter from the axis of intake.  
Specifications are subject to change without prior notice.

Bearing type: ◎=Ball ※=Sleeve ○=1B1S ●=Hypro Bearing

	Frame size (mm)	Model No.	Bearing Type	Rated Voltage (VDC)	Current (A)	Power (W)	Rated Speed (RPM)	Maximum AirFlow (CMM) (CFM)	Maximum Pressure (InAq) (mmAq)	*Noise Level (dB/A)	Weight (g)
AS4056-5	40x40x56	AS04012MB565BA2	◎	12	1.16	13.92	In:17500/ Out:22000	0.87 30.87	2.97 75.51	71.7	103
	40x40x56	AS04012HB565BA2	◎	12	1.32	15.84	In:18500/ Out:23000	0.93 32.67	3.40 86.44	72.5	103
	40x40x56	AS04012UB565BA2	◎	12	1.60	19.20	In:19500/ Out:24000	0.96 34.05	3.72 94.59	73.5	103
AD4506-9	45x45x06	AD4505LX-K90(X)	○●	5	0.05	0.25	4500	0.16 5.80	0.06 1.42	23.0	11
	45x45x06	AD4505MX-K90(X)	○●	5	0.07	0.35	5500	0.20 7.20	0.08 2.03	27.4	11
	45x45x06	AD4505HX-K90(X)	○●	5	0.10	0.50	6200	0.23 8.25	0.10 2.54	32.6	11
	45x45x06	AD4512LX-K90(X)	○●	12	0.04	0.48	4500	0.16 5.80	0.06 1.42	23.0	11
	45x45x06	AD4512MX-K90(X)	○●	12	0.05	0.60	5500	0.20 7.20	0.08 2.03	27.4	11
	45x45x06	AD4512HX-K90(X)	○●	12	0.06	0.72	6200	0.23 8.25	0.10 2.54	32.6	11
AD4510(T)-7	45x45x10	AD4505LB-G70(T)	◎※○●	5	0.09	0.45	3800	0.16 5.82	0.05 1.37	17.5	17
	45x45x10	AD4505MB-G70(T)	◎※○●	5	0.12	0.60	4500	0.20 7.01	0.07 1.83	22.0	17
	45x45x10	AD4505HB-G70(T)	◎※○●	5	0.18	0.90	5500	0.25 8.67	0.10 2.62	27.4	17
	45x45x10	AD4512LB-G70(T)	◎※○●	12	0.06	0.72	3800	0.16 5.82	0.05 1.37	17.5	17
	45x45x10	AD4512MB-G70(T)	◎※○●	12	0.06	0.72	4500	0.20 7.01	0.07 1.83	22.0	17
	45x45x10	AD4512HB-G70(T)	◎※○●	12	0.09	1.08	5500	0.25 8.67	0.10 2.62	27.4	17
	45x45x10	AD4524LB-G70(T)	◎※○●	24	0.03	0.72	3800	0.16 5.82	0.05 1.37	17.5	17
	45x45x10	AD4524MB-G70(T)	◎※○●	24	0.05	1.20	4500	0.20 7.01	0.07 1.83	22.0	17
	45x45x10	AD4524HB-G70(T)	◎※○●	24	0.06	1.44	5500	0.25 8.67	0.10 2.62	27.4	17
AD5010(T)-7	50x50x10	AD0505LB-G70(T)	◎※○●	5	0.10	0.45	3700	0.23 8.00	0.05 1.27	20.0	18
	50x50x10	AD0505MB-G70(T)	◎※○●	5	0.13	0.65	4300	0.25 9.00	0.08 2.03	24.0	18
	50x50x10	AD0505HB-G70(T)	◎※○●	5	0.22	1.10	5000	0.29 10.30	0.10 2.54	27.5	18
	50x50x10	AD0512LB-G70(T)	◎※○●	12	0.08	0.96	3700	0.23 8.00	0.05 1.27	20.0	18
	50x50x10	AD0512MB-G70(T)	◎※○●	12	0.10	1.20	4300	0.25 9.00	0.08 2.03	24.0	18
	50x50x10	AD0512HB-G70(T)	◎※○●	12	0.12	1.44	5000	0.29 10.30	0.10 2.54	27.5	18
	50x50x10	AD0512UB-G70(T)	◎※○●	12	0.10	1.20	5600	0.34 12.00	0.12 3.15	32.0	18
	50x50x10	AD0524LB-G70(T)	◎※○●	24	0.05	1.20	3700	0.23 8.00	0.05 1.27	20.0	18
	50x50x10	AD0524MB-G70(T)	◎※○●	24	0.06	1.44	4300	0.25 9.00	0.08 2.03	24.0	18
50x50x10	AD0524HB-G70(T)	◎※○●	24	0.08	1.92	5000	0.29 10.30	0.10 2.54	27.5	18	
AD5010-7	50x50x10	AD0505LB-G70(8)	◎※○●	5	0.10	0.45	3900	0.25 9.00	0.06 1.52	20.0	18
	50x50x10	AD0505MB-G70(8)	◎※○●	5	0.15	0.75	4600	0.29 10.40	0.10 2.54	25.0	18
	50x50x10	AD0505HB-G70(8)	◎※○●	5	0.23	1.15	5200	0.32 11.20	0.12 3.05	28.0	18
	50x50x10	AD0512LB-G70(8)	◎※○●	12	0.08	0.96	3900	0.25 9.00	0.06 1.52	20.0	18



# DC Fan

- AD 15mm ~ 172mm / Thickness : min 06mm ~ max 51mm
- AS 40mm ~ 140mm / Thickness : min 28mm ~ max 76mm
- AG 20mm ~ 127mm / Thickness : min 10mm ~ max 38mm



80x80x76



40x40x28

Bearing type: ◎=Ball ※=Sleeve ○=1B1S ●=Hypro Bearing

	Frame size (mm)	Model No.	Bearing Type	Rated Voltage (VDC)	Current (A)	Power (W)	Rated Speed (RPM)	Maximum AirFlow (CMM)	Maximum AirFlow (CFM)	Maximum Pressure (InAq)	Maximum Pressure (mmAq)	*Noise Level (dB/A)	Weight (g)
AD5010-7	50x50x10	AD0512MB-G70(8)	◎※○●	12	0.09	1.08	4600	0.29	10.40	0.10	2.54	25.0	18
	50x50x10	AD0512HB-G70(8)	◎※○●	12	0.12	1.44	5200	0.31	11.00	0.12	3.05	28.0	18
	50x50x10	AD0524LB-G70(8)	◎※○●	24	0.05	1.20	3900	0.24	8.40	0.07	1.78	21.0	18
	50x50x10	AD0524MB-G70(8)	◎※○●	24	0.06	1.44	4600	0.29	10.40	0.10	2.54	25.0	18
	50x50x10	AD0524HB-G70(8)	◎※○●	24	0.08	1.92	5200	0.31	11.00	0.12	3.05	28.0	18
AD5015(T)-7	50x50x15	AD5005HB-D70	◎※●	5	0.21	1.05	4800	0.40	14.30	0.13	3.28	34.0	27
	50x50x15	AD5012LB-D70(T1)	◎※●	12	0.07	0.84	3600	0.31	11.00	0.07	1.78	25.0	27
	50x50x15	AD5012MB-D70(T1)	◎※●	12	0.08	0.96	4300	0.37	13.00	0.10	2.54	30.0	27
	50x50x15	AD5012HB-D70(T1)	◎※●	12	0.11	1.32	4800	0.40	14.30	0.13	3.28	34.0	27
	50x50x15	AD5012UB-D70(T1)	◎※●	12	0.14	1.68	5500	0.47	16.50	0.18	4.57	37.5	27
AD5020(T)-5	50x50x20	AD5012UB-C50(T)	◎●	12	0.19	2.22	6300	0.49	17.4	0.26	6.604	37.5	43
AD5020-7	50x50x20	AD5012LB-C71	◎※●	12	0.08	0.96	3600	0.34	12.00	0.08	2.03	24.0	32
	50x50x20	AD5012MB-C71	◎※●	12	0.10	1.20	4300	0.42	15.00	0.11	2.79	29.0	32
	50x50x20	AD5012HB-C71	◎※●	12	0.13	1.56	5000	0.50	17.50	0.15	3.81	33.7	32
	50x50x20	AD5012UB-C71	◎※●	12	0.19	2.22	6000	0.57	20.00	0.21	5.33	38.4	32
	50x50x20	AD5024LB-C71	◎※●	24	0.06	1.44	3600	0.34	12.00	0.08	2.03	24.0	32
	50x50x20	AD5024MB-C71	◎※●	24	0.08	1.92	4300	0.42	15.00	0.11	2.79	29.0	32
	50x50x20	AD5024HB-C71	◎※●	24	0.11	2.64	5000	0.50	17.50	0.15	3.81	33.7	32
	50x50x20	AD5024UB-C71	◎※●	24	0.15	3.60	6000	0.57	20.00	0.21	5.33	38.4	32
AD6010GL(T)-11	60x60x10	AD0605LB-GA0(GLT1)	◎※○●	5	0.25	1.25	3400	0.41	14.50	0.09	2.39	26.0	30
	60x60x10	AD0605MB-GA0(GLT1)	◎※○●	5	0.33	1.65	4000	0.52	18.49	0.11	2.67	32.8	30
	60x60x10	AD0612LB-GA0(GLT1)	◎※○●	12	0.10	1.20	3400	0.41	14.50	0.09	2.39	26.0	30
	60x60x10	AD0612MB-GA0(GLT1)	◎※○●	12	0.14	1.68	4000	0.52	18.49	0.11	2.67	32.8	30
	60x60x10	AD0612HB-GA0(GLT1)	◎※○●	12	0.25	3.00	4600	0.61	21.37	0.14	3.61	35.8	30
	60x60x10	AD0624LB-GA0(GLT1)	◎※○●	24	0.04	0.96	3400	0.41	14.50	0.09	2.39	26.0	30
	60x60x10	AD0624MB-GA0(GLT1)	◎※○●	24	0.10	2.40	4000	0.52	18.49	0.11	2.67	32.8	30
	60x60x10	AD0624HB-GA0(GLT1)	◎※○●	24	0.18	4.32	4600	0.61	21.37	0.14	3.61	35.8	30
AD6010(T)-7	60x60x10	AD0605DB-G70(T)	◎※○●	5	0.05	0.25	2800	0.24	8.39	0.05	1.19	16.10	23
	60x60x10	AD0605LB-G70(T)	◎※○●	5	0.09	0.45	3500	0.30	10.64	0.07	1.83	22.90	23
	60x60x10	AD0605MB-G70(T)	◎※○●	5	0.12	0.60	4200	0.34	12.00	0.09	2.29	28.00	23
	60x60x10	AD0612DB-G70(T)	◎※○●	12	0.04	0.48	2800	0.24	8.39	0.05	1.19	16.10	23
	60x60x10	AD0612LB-G70(T)	◎※○●	12	0.09	1.08	3500	0.30	10.64	0.07	1.83	22.90	23
	60x60x10	AD0612MB-G70(T)	◎※○●	12	0.11	1.32	4200	0.34	12.00	0.09	2.29	28.00	23
	60x60x10	AD0612HB-G70(T)	◎※○●	12	0.12	1.44	4900	0.42	14.82	0.12	3.00	35.00	23
	60x60x10	AD0624LB-G70(T)	◎※○●	24	0.03	0.72	3500	0.30	10.64	0.07	1.83	22.90	23



40x40x56



120x120x38



60x60x25



140x140x51

\*:Noise is measured at the distance of 1 meter from the axis of intake.  
Specifications are subject to change without prior notice.

Bearing type: ●=Ball ※=Sleeve ○=1B1S ●=Hypro Bearing

	Frame size (mm)	Model No.	Bearing Type	Rated Voltage (VDC)	Current (A)	Power (W)	Rated Speed (RPM)	Maximum AirFlow (CMM)	Maximum AirFlow (CFM)	Maximum Pressure (InAq)	Maximum Pressure (mmAq)	*Noise Level (dB/A)	Weight (g)	
<b>AD6010(T)-7</b>	60x60x10	AD0624MB-G70(T)	◎※○●	24	0.04	0.96	4200	0.34	12.00	0.09	2.29	28.00	23	
	60x60x10	AD0624HB-G70(T)	◎※○●	24	0.05	1.20	4900	0.42	14.82	0.12	3.00	35.00	23	
<b>AD6010-7</b>	60x60x10	AD0612LB-G71	◎※○●	12	0.05	0.60	3500	0.30	10.64	0.07	1.83	22.90	23	
	60x60x10	AD0612MB-G71	◎※○●	12	0.05	0.60	4200	0.34	12.00	0.09	2.29	28.00	23	
	60x60x10	AD0612HB-G71	◎※○●	12	0.06	0.60	4900	0.42	14.82	0.12	3.00	35.00	23	
<b>AD6015GL(T)-7</b>	60x60x15	AD0605LB-D70GL(T)	◎※○●	5	0.14	0.70	3500	0.35	12.33	0.08	2.06	24.8	38	
	60x60x15	AD0605MB-D70GL(T)	◎※○●	5	0.18	0.90	3900	0.41	14.32	0.12	3.10	28.8	38	
	60x60x15	AD0605HB-D70GL(T)	◎※○●	5	0.19	0.95	4500	0.45	15.82	0.15	3.71	33.4	38	
	60x60x15	AD0612DB-D70GL(T)	◎※○●	12	0.06	0.72	3100	0.31	10.80	0.06	1.63	21.3	38	
	60x60x15	AD0612LB-D70GL(T)	◎※○●	12	0.07	0.84	3500	0.35	12.33	0.08	2.06	24.8	38	
	60x60x15	AD0612MB-D70GL(T)	◎※○●	12	0.08	0.96	3900	0.41	14.32	0.12	3.10	28.8	38	
	60x60x15	AD0612HB-D70GL(T)	◎※○●	12	0.09	1.08	4500	0.45	15.82	0.15	3.71	33.4	38	
	60x60x15	AD0612UB-D70GL(T)	◎※○●	12	0.12	1.44	5100	0.52	18.36	0.17	4.29	38.6	38	
	60x60x15	AD0624LB-D70GL(T)	◎※○●	24	0.03	0.72	3500	0.35	12.33	0.08	2.06	24.8	38	
	60x60x15	AD0624MB-D70GL(T)	◎※○●	24	0.04	0.96	3900	0.41	14.32	0.12	3.10	28.8	38	
	60x60x15	AD0624HB-D70GL(T)	◎※○●	24	0.05	1.20	4500	0.45	15.82	0.15	3.71	33.4	38	
	60x60x15	AD0624UB-D70GL(T)	◎※○●	24	0.06	1.44	5100	0.52	18.36	0.17	4.29	38.6	38	
	<b>AD6015(T)-9</b>	60x60x15	AD0605DB-D90(T)	◎※○●	5	0.09	0.45	3100	0.43	15.05	0.07	1.65	22.80	38
		60x60x15	AD0605LB-D90(T)	◎※○●	5	0.17	0.85	3500	0.48	17.03	0.08	2.01	25.80	38
60x60x15		AD0605MB-D90(T)	◎※○●	5	0.20	1.00	3900	0.53	18.88	0.10	2.62	29.70	38	
60x60x15		AD0605HB-D90(T)	◎※○●	5	0.23	1.15	4500	0.64	22.67	0.14	3.63	32.70	38	
60x60x15		AD0612DB-D90(T)	◎※○●	12	0.06	0.72	3100	0.43	15.05	0.07	1.65	22.80	38	
60x60x15		AD0612LB-D90(T)	◎※○●	12	0.08	0.96	3500	0.48	17.03	0.08	2.01	25.80	38	
60x60x15		AD0612MB-D90(T)	◎※○●	12	0.13	1.56	3900	0.53	18.88	0.10	2.62	29.70	38	
60x60x15		AD0612HB-D90(T)	◎※○●	12	0.17	2.04	4500	0.64	22.67	0.14	3.63	32.70	38	
60x60x15		AD0624LB-D90(T)	◎※○●	24	0.04	0.96	3500	0.48	17.03	0.08	2.01	25.80	38	
60x60x15		AD0624MB-D90(T)	◎※○●	24	0.06	1.44	3900	0.53	18.88	0.10	2.62	29.70	38	
60x60x15	AD0624HB-D90(T)	◎※○●	24	0.08	1.92	4500	0.64	22.67	0.14	3.63	32.70	38		
<b>AG6015-9</b>	60x60x15	AG06005DB159100	◎※●	5	0.10	0.05	3000	0.37	13.13	0.08	1.93	21.00	39	
	60x60x15	AG06005LB159100	◎※●	5	0.13	0.65	3500	0.42	14.82	0.10	2.54	25.30	39	
	60x60x15	AG06005MB159100	◎※●	5	0.19	0.95	4000	0.49	17.25	0.13	3.38	28.70	39	
	60x60x15	AG06005HB159100	◎※●	5	0.28	1.40	4500	0.58	20.39	0.16	4.14	32.10	39	
	60x60x15	AG06012DB159100	◎※●	12	0.04	0.48	3000	0.37	13.13	0.08	1.93	21.00	39	
	60x60x15	AG06012LB159100	◎※●	12	0.06	0.72	3500	0.42	14.82	0.10	2.54	25.30	39	
60x60x15	AG06012MB159100	◎※●	12	0.08	0.96	4000	0.49	17.25	0.13	3.38	28.70	39		

# DC Fan

- AD 15mm ~ 172mm / Thickness : min 06mm ~ max 51mm
- AS 40mm ~ 140mm / Thickness : min 28mm ~ max 76mm
- AG 20mm ~ 127mm / Thickness : min 10mm ~ max 38mm



80x80x76



40x40x28

Bearing type: ○=Ball ※=Sleeve ◐=1B1S ●=Hypro Bearing

	Frame size (mm)	Model No.	Bearing Type	Rated Voltage (VDC)	Current (A)	Power (W)	Rated Speed (RPM)	Maximum AirFlow (CMM)	Maximum AirFlow (CFM)	Maximum Pressure (InAq)	Maximum Pressure (mmAq)	*Noise Level (dB/A)	Weight (g)
AG6015-9	60x60x15	AG06012HB159100	○※ ●	12	0.10	1.20	4500	0.58	20.39	0.16	4.14	32.10	39
	60x60x15	AG06012UB159100	○※ ●	12	0.14	1.68	5000	0.61	21.47	0.20	5.13	35.80	39
	60x60x15	AG06012XB159100	○※ ●	12	0.26	3.12	6000	0.76	27.01	0.29	7.26	40.70	39
	60x60x15	AG06024DB159100	○※ ●	24	0.04	0.96	3000	0.37	13.13	0.08	1.93	21.00	39
	60x60x15	AG06024LB159100	○※ ●	24	0.05	1.20	3500	0.42	14.82	0.10	2.54	25.30	39
	60x60x15	AG06024MB159100	○※ ●	24	0.07	1.68	4000	0.49	17.25	0.13	3.38	28.70	39
	60x60x15	AG06024HB159100	○※ ●	24	0.08	1.92	4500	0.58	20.39	0.16	4.14	32.10	39
	60x60x15	AG06024UB159100	○※ ●	24	0.10	2.40	5000	0.61	21.47	0.20	5.13	35.80	39
AD6020GL(T)-7	60x60x20	AD0605DB-C70GL(T)	○※ ●	5	0.07	0.35	3000	0.30	10.74	0.05	1.37	18.40	49
	60x60x20	AD0605LB-C70GL(T)	○※ ●	5	0.12	0.60	3500	0.35	12.50	0.08	2.08	23.50	49
	60x60x20	AD0605MB-C70GL(T)	○※ ●	5	0.16	0.80	3900	0.40	14.28	0.11	2.84	28.00	49
	60x60x20	AD0605HB-C70GL(T)	○※ ●	5	0.18	0.90	4600	0.47	16.46	0.14	3.56	31.00	49
	60x60x20	AD0612DB-C70GL(T)	○※ ●	12	0.05	0.60	3000	0.30	10.74	0.05	1.37	18.40	49
	60x60x20	AD0612LB-C70GL(T)	○※ ●	12	0.06	0.72	3500	0.35	12.50	0.08	2.08	23.50	49
	60x60x20	AD0612MB-C70GL(T)	○※ ●	12	0.08	0.96	3900	0.40	14.28	0.11	2.84	28.00	49
	60x60x20	AD0612HB-C70GL(T)	○※ ●	12	0.10	1.44	4600	0.47	16.46	0.14	3.56	31.00	49
	60x60x20	AD0612UB-C70GL(T)	○※ ●	12	0.13	1.56	5100	0.54	18.93	0.18	4.65	35.50	49
	60x60x20	AD0612XB-C70GL(T)	○※ ●	12	0.20	2.40	6100	0.67	23.55	0.28	7.19	39.00	49
	60x60x20	AD0624LB-C70GL(T)	○※ ●	24	0.04	0.96	3500	0.35	12.50	0.08	2.08	23.50	49
	60x60x20	AD0624MB-C70GL(T)	○※ ●	24	0.04	0.96	3900	0.40	14.28	0.11	2.84	28.00	49
60x60x20	AD0624HB-C70GL(T)	○※ ●	24	0.05	1.20	4500	0.46	16.31	0.13	3.40	31.00	49	
AG6020(T)-7	60x60x20	AG06012DB207600	○ ●	12	0.16	1.92	4000	0.56	19.75	0.17	4.32	31.80	47.6
	60x60x20	AG06012LB207600	○ ●	12	0.18	2.16	4500	0.64	22.74	0.21	5.41	35.40	47.6
	60x60x20	AG06012MB207600	○ ●	12	0.20	2.40	5000	0.72	25.32	0.26	6.63	38.60	47.6
	60x60x20	AG06012HB207600	○ ●	12	0.23	2.76	5500	0.83	29.14	0.32	8.20	40.80	47.6
	60x60x20	AG06012UB207600	○ ●	12	0.28	3.36	6000	0.87	30.82	0.37	9.40	43.20	47.6
AG6020-7	60x60x20	AG06012DB207300	○ ●	12	0.16	1.92	4000	0.56	19.75	0.17	4.32	31.80	47.6
	60x60x20	AG06012LB207300	○ ●	12	0.18	2.16	4500	0.64	22.74	0.21	5.41	35.40	47.6
	60x60x20	AG06012MB207300	○ ●	12	0.20	2.40	5000	0.72	25.32	0.26	6.63	38.60	47.6
	60x60x20	AG06012HB207300	○ ●	12	0.23	2.76	5500	0.83	29.14	0.32	8.20	40.80	47.6
	60x60x20	AG06012UB207300	○ ●	12	0.28	3.36	6000	0.87	30.82	0.37	9.40	43.20	47.6
	60x60x20	AG06024DB207300	○ ●	24	0.10	2.40	4000	0.56	19.75	0.17	4.32	31.80	47.6
	60x60x20	AG06024LB207300	○ ●	24	0.12	2.88	4500	0.64	22.50	0.21	5.41	35.40	47.6
	60x60x20	AG06024MB207300	○ ●	24	0.14	3.36	5000	0.70	24.60	0.26	6.63	38.60	47.6
60x60x20	AG06024HB207300	○ ●	24	0.16	3.84	5500	0.83	29.14	0.32	8.20	40.80	47.6	



40x40x56



120x120x38



60x60x25



140x140x51

\*:Noise is measured at the distance of 1 meter from the axis of intake.  
Specifications are subject to change without prior notice.

Bearing type: ○=Ball ※=Sleeve ◯=1B1S ●=Hypro Bearing

	Frame size (mm)	Model No.	Bearing Type		Rated Voltage (VDC)	Current (A)	Power (W)	Rated Speed (RPM)	Maximum AirFlow (CMM) (CFM)		Maximum Pressure (InAq) (mmAq)		*Noise Level (dB/A)	Weight (g)
<b>AG6020-7</b>	60x60x20	AG06024UB207300	○	●	24	0.19	4.56	6000	0.85	30.17	0.34	8.69	41.30	47.6
	60x60x20	AD0605DB-C71GL	○※	●	5	0.07	0.35	3000	0.31	10.94	0.08	1.93	18.40	49
	60x60x20	AD0605LB-C71GL	○※	●	5	0.10	0.50	3500	0.37	13.00	0.10	2.57	23.60	49
	60x60x20	AD0605MB-C71GL	○※	●	5	0.13	0.65	3900	0.42	14.75	0.13	3.20	25.20	49
	60x60x20	AD0605HB-C71GL	○※	●	5	0.18	0.90	4500	0.50	17.66	0.17	4.29	30.20	49
	60x60x20	AD0605UB-C71GL	○※	●	5	0.23	1.15	5100	0.54	19.01	0.21	5.36	34.10	49
	60x60x20	AD0612DB-C71GL	○※	●	12	0.04	0.48	3000	0.31	10.94	0.08	1.93	18.40	49
<b>AD6020GL-7</b>	60x60x20	AD0612LB-C71GL	○※	●	12	0.05	0.60	3500	0.37	13.00	0.10	2.57	23.60	49
	60x60x20	AD0612MB-C71GL	○※	●	12	0.06	0.72	3900	0.42	14.75	0.13	3.20	25.20	49
	60x60x20	AD0612HB-C71GL	○※	●	12	0.08	0.96	4500	0.50	17.66	0.17	4.29	30.20	49
	60x60x20	AD0612UB-C71GL	○※	●	12	0.09	1.08	5100	0.54	19.01	0.21	5.36	34.10	49
	60x60x20	AD0612XB-C71GL	○※	●	12	0.13	1.56	6100	0.67	23.58	0.30	7.52	38.00	49
	60x60x20	AD0624LB-C71GL	○※	●	24	0.04	0.96	3500	0.37	13.00	0.10	2.57	23.60	49
	60x60x20	AD0624MB-C71GL	○※	●	24	0.05	1.20	3900	0.42	14.75	0.13	3.20	25.20	49
<b>AD6025GL(T)-7</b>	60x60x20	AD0624HB-C71GL	○※	●	24	0.06	1.44	4500	0.50	17.66	0.17	4.29	30.20	49
	60x60x20	AD0624UB-C71GL	○※	●	24	0.07	1.68	5100	0.54	19.01	0.21	5.36	34.10	49
	60x60x25	AD0605LB-A70GL(T)	○※	●	5	0.10	0.50	2500	0.37	13.20	0.06	1.60	18.1	53
	60x60x25	AD0605MB-A70GL(T)	○※	●	5	0.19	0.95	3500	0.52	18.19	0.12	3.10	28.6	53
	60x60x25	AD0605HB-A70GL(T)	○※	●	5	0.30	1.50	4500	0.69	24.49	0.20	5.08	35.2	53
	60x60x25	AD0612DB-A70GL(T)	○※	●	12	0.05	0.60	2000	0.30	10.44	0.04	0.97	12.6	53
	60x60x25	AD0612LB-A70GL(T)	○※	●	12	0.06	0.72	2500	0.37	13.20	0.06	1.60	18.1	53
	60x60x25	AD0612MB-A70GL(T)	○※	●	12	0.08	0.96	3600	0.53	18.78	0.13	3.23	29.8	53
	60x60x25	AD0612HB-A70GL(T)	○※	●	12	0.19	2.28	4600	0.70	24.78	0.20	5.08	36.8	53
	60x60x25	AD0612UB-A70GL(T)	○※	●	12	0.25	3.00	5000	0.76	27.00	0.23	5.84	40.0	53
	60x60x25	AD0624LB-A70GL(T)	○※	●	24	0.04	0.96	2500	0.37	13.20	0.06	1.60	18.1	53
	60x60x25	AD0624MB-A70GL(T)	○※	●	24	0.06	1.44	3500	0.52	18.19	0.12	3.10	28.6	53
	60x60x25	AD0624HB-A70GL(T)	○※	●	24	0.10	2.40	4500	0.69	24.49	0.20	5.08	35.2	53
60x60x25	AD0624UB-A70GL(T)	○※	●	24	0.14	3.36	5000	0.76	27.00	0.23	5.84	40.0	53	
<b>AD6025GL-7</b>	60x60x25	AD0605LB-A71GL	○※	●	5	0.08	0.40	2500	0.37	13.20	0.06	1.60	18.1	53
	60x60x25	AD0605MB-A71GL	○※	●	5	0.17	0.85	3500	0.53	18.54	0.12	3.10	26.0	53
	60x60x25	AD0605HB-A71GL	○※	●	5	0.35	1.75	4500	0.69	24.33	0.21	5.26	36.3	53
	60x60x25	AD0612LB-A71GL	○※	●	12	0.04	0.48	2500	0.37	13.20	0.06	1.60	18.1	53
	60x60x25	AD0612MB-A71GL	○※	●	12	0.08	0.96	3500	0.53	18.54	0.12	3.10	26.0	53
	60x60x25	AD0612HB-A71GL	○※	●	12	0.13	1.56	4500	0.69	24.33	0.21	5.26	36.3	53
	60x60x25	AD0612UB-A71GL	○※	●	12	0.22	2.64	5300	0.83	29.40	0.27	6.86	40.5	53

# DC Fan

- AD 15mm ~ 172mm / Thickness : min 06mm ~ max 51mm
- AS 40mm ~ 140mm / Thickness : min 28mm ~ max 76mm
- AG 20mm ~ 127mm / Thickness : min 10mm ~ max 38mm



80x80x76



40x40x28

Bearing type: ◎=Ball ※=Sleeve ○=1B1S ●=Hypro Bearing

	Frame size (mm)	Model No.	Bearing Type	Rated Voltage (VDC)	Current (A)	Power (W)	Rated Speed (RPM)	Maximum AirFlow (CMM)	Maximum AirFlow (CFM)	Maximum Pressure (InAq)	Maximum Pressure (mmAq)	*Noise Level (dB/A)	Weight (g)
AD6025GL-7	60x60x25	AD0612XB-A71GL	◎	12	0.30	3.60	6100	2.64	31.40	0.32	8.13	42.9	53
	60x60x25	AD0624LB-A71GL	◎※ ●	24	0.07	1.68	2500	0.37	13.20	0.06	1.60	18.1	53
	60x60x25	AD0624MB-A71GL	◎※ ●	24	0.06	1.44	3500	0.53	18.54	0.12	3.10	26.0	53
	60x60x25	AD0624HB-A71GL	◎※ ●	24	0.08	1.92	4500	0.69	24.33	0.21	5.26	36.3	53
	60x60x25	AD0624UB-A71GL	◎※ ●	24	0.11	2.64	5000	0.79	27.88	0.24	6.15	37.6	53
AD6025GP-7	60x60x25	AD0612HB-A71GP(P)	◎	12	0.10	1.20	4500	0.61	21.60	0.24	5.97	35.30	77
	60x60x25	AD0612UB-A71GP(P)	◎	12	0.22	2.64	5500	0.75	26.57	0.35	8.81	41.40	77
	60x60x25	AD0612XB-A71GP(P)	◎	12	0.28	3.60	6500	0.90	31.77	0.49	12.42	44.30	77
	60x60x25	AD0612VB-A71GP(P)	◎	12	0.38	4.56	7500	1.06	37.31	0.69	17.48	50.00	77
	60x60x25	AD0612EB-A71GP(PCU)	◎	12	0.60	7.20	9000	1.26	44.40	0.95	24.00	52.50	77
	60x60x25	AD0624HB-A71GP(P)	◎	24	0.08	1.92	4500	0.61	21.60	0.24	5.97	35.30	77
	60x60x25	AD0624UB-A71GP(P)	◎	24	0.11	2.64	5500	0.75	26.57	0.35	8.81	41.40	77
	60x60x25	AD0624XB-A71GP(P)	◎	24	0.14	3.36	6500	0.90	31.77	0.49	12.42	44.30	77
	60x60x25	AD0624VB-A71GP(P)	◎	24	0.18	4.32	7500	1.06	37.31	0.69	17.48	50.00	77
	60x60x25	AD0624EB-A71GP(PCU)	◎	24	0.30	7.20	9000	1.26	44.40	0.95	24.00	52.50	77
	60x60x25	AD0648HB-A71GP(P)	◎	48	0.04	1.92	4500	0.61	21.60	0.24	5.97	35.30	77
	60x60x25	AD0648UB-A71GP(P)	◎	48	0.05	2.40	5500	0.75	26.57	0.35	8.81	41.40	77
	60x60x25	AD0648XB-A71GP(P)	◎	48	0.07	3.36	6500	0.90	31.77	0.49	12.42	44.30	77
	60x60x25	AD0648VB-A71GP(P)	◎	48	0.09	4.32	7500	1.06	37.31	0.69	17.48	50.00	77
	AD6025(T)-7	60x60x25	AD06005LB257000	◎※ ●	5	0.07	0.35	2500	0.36	12.71	0.08	1.93	15.90
60x60x25		AD06005MB257000	◎※ ●	5	0.16	0.80	3500	0.49	17.34	0.13	3.33	26.90	53
60x60x25		AD06005HB257000	◎※ ●	5	0.28	1.40	4500	0.66	23.34	0.23	5.92	33.80	53
60x60x25		AD06012DB257000	◎※ ●	12	0.03	0.36	2000	0.28	9.98	0.05	1.24	12.40	53
60x60x25		AD06012LB257000	◎※ ●	12	0.04	0.48	2500	0.36	12.71	0.08	1.93	15.90	53
60x60x25		AD06012MB257000	◎※ ●	12	0.08	0.96	3500	0.49	17.34	0.13	3.33	26.90	53
60x60x25		AD06012HB257000	◎※ ●	12	0.12	1.44	4500	0.66	23.34	0.23	5.92	33.80	53
60x60x25		AD06012UB257000	◎※ ●	12	0.18	2.16	5000	0.74	25.97	0.28	7.19	37.10	53
60x60x25		AD06024MB257000	◎※ ●	24	0.03	0.72	3500	0.49	17.34	0.13	3.33	26.90	53
60x60x25		AD06024HB257000	◎※ ●	24	0.06	1.44	4500	0.66	23.34	0.23	5.92	33.80	53
60x60x25		AD06024UB257000	◎※ ●	24	0.08	1.92	5000	0.74	25.97	0.28	7.19	37.10	53
60x60x25		AD06024XB257000	◎※ ●	24	0.14	3.36	6000	0.89	31.38	0.37	9.30	42.80	53
AD6025-7	60x60x25	AD06012DB257100	◎※ ●	12	0.03	0.36	2000	0.28	9.98	0.05	1.24	12.40	53
	60x60x25	AD06012LB257100	◎※ ●	12	0.05	0.60	2500	0.36	12.71	0.08	1.93	15.90	53
	60x60x25	AD06012MB257100	◎※ ●	12	0.08	0.96	3500	0.49	17.34	0.13	3.33	26.90	53
	60x60x25	AD06012HB257100	◎※ ●	12	0.12	1.44	4500	0.66	23.34	0.23	5.92	33.80	53



40x40x56



120x120x38



60x60x25



140x140x51

\*:Noise is measured at the distance of 1 meter from the axis of intake.  
Specifications are subject to change without prior notice.

Bearing type: ◎=Ball ※=Sleeve ○=1B1S ●=Hypro Bearing

	Frame size (mm)	Model No.	Bearing Type	Rated Voltage (VDC)	Current (A)	Power (W)	Rated Speed (RPM)	Maximum AirFlow (CMM)	Maximum AirFlow (CFM)	Maximum Pressure (InAq)	Maximum Pressure (mmAq)	*Noise Level (dB/A)	Weight (g)
AD6025-7	60x60x25	AD06012UB257100	◎※●	12	0.17	2.04	5000	0.74	25.97	0.28	7.19	37.10	53
	60x60x25	AD06012XB257100	◎※●	12	0.26	3.12	6000	0.89	31.38	0.37	9.30	42.80	53
	60x60x25	AD06012VB257100	◎	12	0.33	3.96	6600	0.98	34.70	0.44	11.13	46.80	53
	60x60x25	AD06024LB257100	◎※●	24	0.04	0.96	2500	0.36	12.71	0.08	1.93	15.90	53
	60x60x25	AD06024MB257100	◎※●	24	0.05	1.20	3500	0.49	17.34	0.13	3.33	26.90	53
	60x60x25	AD06024HB257100	◎※●	24	0.08	1.92	4500	0.66	23.34	0.23	5.92	33.80	53
	60x60x25	AD06024UB257100	◎※●	24	0.10	2.40	5000	0.74	25.97	0.28	7.19	37.10	53
	60x60x25	AD06024XB257100	◎※●	24	0.14	3.36	6000	0.89	31.38	0.37	9.30	42.80	53
	60x60x25	AD06024VB257100	◎	24	0.20	4.80	6600	0.98	34.70	0.44	11.13	46.80	53
AD6025-7	60x60x25	AD06012HB257BZ0	◎※●	12	0.13	1.56	4500	0.65	22.85	0.21	5.36	35.50	57
	60x60x25	AD06012UB257BZ0	◎※●	12	0.16	1.92	5000	0.72	25.30	0.25	6.40	39.20	57
	60x60x25	AD06012XB257BZ0	◎※●	12	0.24	2.88	6000	0.87	30.55	0.37	9.45	43.40	57
AD6038DS-7	60x60x38	AD0612MB-F73DS	◎	12	0.28	3.36	6000	1.04	36.56	0.56	14.27	49.80	109
	60x60x38	AD0612HB-F73DS	◎	12	0.64	7.68	8000	1.37	48.37	0.98	24.99	58.00	109
	60x60x38	AD0612UB-F73DS	◎	12	1.40	16.80	10000	1.73	61.00	1.20	30.48	63.60	109
	60x60x38	AD0624MB-F73DS	◎	24	0.16	3.84	6000	1.04	36.56	0.56	14.27	49.80	109
	60x60x38	AD0624HB-F73DS	◎	24	0.34	8.16	8000	1.37	48.37	0.98	24.99	58.00	109
	60x60x38	AD0624UB-F73DS	◎	24	0.70	16.80	10000	1.73	61.00	1.20	30.48	63.60	109
	60x60x38	AD0648MB-F73DS	◎	48	0.09	4.32	6000	1.04	36.56	0.56	14.27	49.80	109
	60x60x38	AD0648HB-F73DS	◎	48	0.20	9.60	8000	1.37	48.37	0.98	24.99	58.00	109
	60x60x38	AD0648UB-F73DS	◎	48	0.38	18.24	10000	1.73	61.00	1.20	30.48	63.60	109
AS6038-7	60x60x38	AS06012HB387100	◎	12	1.45	17.40	13000	1.94	68.37	1.95	49.63	61.40	125
	60x60x38	AS06012UB387100	◎	12	2.10	25.20	14500	2.16	76.18	2.42	61.34	64.10	125
	60x60x38	AS06012XB387100	◎	12	2.70	32.40	16000	2.42	85.54	2.95	74.93	66.70	125
	60x60x38	AS06024HB387100	◎	24	0.73	17.52	13000	1.94	68.37	1.95	49.63	61.40	125
	60x60x38	AS06024UB387100	◎	24	0.92	22.08	14500	2.16	76.18	2.42	61.34	64.10	125
	60x60x38	AS06024XB387100	◎	24	1.25	30.00	16000	2.42	85.54	2.95	74.93	66.70	125
	60x60x38	AS06048HB387100	◎	48	0.36	17.28	13000	1.94	68.37	1.95	49.63	61.40	125
	60x60x38	AS06048UB387100	◎	48	0.47	22.56	14500	2.16	76.18	2.42	61.34	64.10	125
	60x60x38	AS06048XB387100	◎	48	0.63	30.24	16000	2.42	85.54	2.95	74.93	66.70	125
AS6038-5	60x60x38	AS06012LB385BB0	◎	12	0.45	5.40	10000	1.06	37.40	1.20	30.40	50.4	143
	60x60x38	AS06012MB385BB0	◎	12	0.70	8.40	12500	1.32	46.50	1.79	45.47	56.1	143
	60x60x38	AS06012HB385BB0	◎	12	1.13	13.50	15000	1.61	56.70	2.51	63.75	60.9	143
	60x60x38	AS06012UB385BB0	◎	12	1.70	20.40	17500	1.86	65.60	3.19	80.90	65.3	143

# DC Fan

- AD 15mm ~ 172mm / Thickness : min 06mm ~ max 51mm
- AS 40mm ~ 140mm / Thickness : min 28mm ~ max 76mm
- AG 20mm ~ 127mm / Thickness : min 10mm ~ max 38mm



80x80x76



40x40x28

Bearing type: ◎=Ball ※=Sleeve ○=1B1S ●=Hypro Bearing

	Frame size (mm)	Model No.	Bearing Type	Rated Voltage (VDC)	Current (A)	Power (W)	Rated Speed (RPM)	Maximum AirFlow (CMM) (CFM)	Maximum Pressure (InAq) (mmAq)	*Noise Level (dB/A)	Weight (g)
AS6076-5	60x60x76	AS06012HB765300	◎	12	1.60	19.20	in:11500/ out:7000	1.88 66.54	2.01 51.00	64.5	260
	60x60x76	AS06012UB765300	◎	12	2.60	31.20	in:11000/ out:13000	2.30 81.07	2.44 61.90	67.9	260
AD7015(T)-11	70x70x15	AD0712DB-DA0(T)	◎※●	12	0.07	0.84	2500	0.53 18.83	0.07 1.88	28.7	54
	70x70x15	AD0712LB-DA0(T)	◎※●	12	0.08	0.96	3000	0.61 21.50	0.09 2.39	32.7	54
	70x70x15	AD0712MB-DA0(T)	◎※●	12	0.12	1.44	3500	0.71 25.10	0.12 3.10	35.3	54
	70x70x15	AD0712HB-DA0(T)	◎※●	12	0.18	2.16	4000	0.83 29.30	0.18 4.45	39.0	54
	70x70x15	AD0712UB-DA0(T)	◎※●	12	0.28	3.36	4500	0.99 34.80	0.20 4.98	43.4	54
AD7015(T)-7	70x70x15	AD0712DB-D70(T)	◎※●	12	0.07	0.84	2500	0.55 19.34	0.07 1.78	25.6	54
	70x70x15	AD0712LB-D70(T)	◎※●	12	0.11	1.32	3000	0.66 23.41	0.10 2.49	30.2	54
	70x70x15	AD0712MB-D70(T)	◎※●	12	0.15	1.80	3500	0.81 28.61	0.15 3.71	36.9	54
	70x70x15	AD0712HB-D70(T)	◎※●	12	0.23	2.76	4000	0.91 32.17	0.17 4.24	40.3	54
AD7015-7	70x70x15	AD0712DB-D71	◎※●	12	0.06	0.72	2500	0.55 19.34	0.07 1.78	25.6	54
	70x70x15	AD0712LB-D71	◎※●	12	0.08	0.96	3000	0.66 23.41	0.10 2.49	30.2	54
	70x70x15	AD0712MB-D71	◎※●	12	0.10	1.22	3500	0.81 28.61	0.15 3.71	36.9	54
	70x70x15	AD0712HB-D71	◎※●	12	0.15	1.76	4000	0.91 32.17	0.17 4.24	40.3	54
	70x70x15	AD0712UB-D71	◎※●	12	0.22	2.64	4500	1.01 35.80	0.23 5.79	41.9	54
AD7015-9	70x70x15	AD0712DB-D91	◎※●	12	0.05	0.60	2500	0.50 17.60	0.07 1.78	23.8	50
	70x70x15	AD0712LB-D91	◎※●	12	0.06	0.72	3000	0.61 21.40	0.10 2.49	27.6	50
	70x70x15	AD0712MB-D91	◎※●	12	0.11	1.32	3700	0.74 26.30	0.15 3.76	33.7	50
	70x70x15	AD0712HB-D91	◎※●	12	0.18	2.16	4600	0.93 32.70	0.22 5.64	40.6	50
	70x70x15	AD0712UB-D91	◎※●	12	0.26	3.12	5500	1.15 40.45	0.26 6.71	44.4	50
AD7015-11	70x70x15	AD0712DB-DA1	◎※●	12	0.07	0.84	2500	0.53 18.83	0.07 1.88	28.7	54
	70x70x15	AD0712LB-DA1	◎※●	12	0.08	0.96	3000	0.61 21.50	0.09 2.39	32.7	54
	70x70x15	AD0712MB-DA1	◎※●	12	0.12	1.44	3500	0.71 25.10	0.12 3.10	35.3	54
	70x70x15	AD0712HB-DA1	◎※●	12	0.18	2.16	4000	0.83 29.30	0.18 4.45	39.0	54
	70x70x15	AD0712UB-DA1	◎※●	12	0.28	3.36	4500	0.99 34.80	0.20 4.98	43.4	54
AG07020-9	70x70x20	AG07012HB209300(OPJ)	◎	12	0.30	3.60	4500	1.15 40.78	0.26 6.60	41.50	61
	70x70x20	AG07012UB209300(OPJ)	◎	12	0.35	4.20	5000	1.26 44.50	0.31 7.87	43.50	61
AD7025GP-7	70x70x25	AD0712LB-A73GP	◎	12	0.17	2.04	3700	1.06 37.30	0.18 4.52	36.8	90
	70x70x25	AD0712MB-A73GP	◎	12	0.22	2.62	4200	1.19 42.00	0.22 5.64	40.6	90
	70x70x25	AD0712HB-A73GP	◎	12	0.30	3.60	4700	1.33 46.90	0.30 7.62	43.0	90
	70x70x25	AD0712UB-A73GP	◎	12	0.33	3.96	5000	1.41 49.70	0.38 9.65	44.0	90
AD7025GL-7	70x70x25	AD0712DB-A70GL(T)	◎※○●	12	0.68	0.84	2500	0.62 21.90	0.08 2.03	21.0	61



40x40x56



120x120x38



60x60x25



140x140x51

\*:Noise is measured at the distance of 1 meter from the axis of intake.  
Specifications are subject to change without prior notice.

Bearing type: ○=Ball ※=Sleeve ◯=1B1S ●=Hypro Bearing

	Frame size (mm)	Model No.	Bearing Type	Rated Voltage (VDC)	Current (A)	Power (W)	Rated Speed (RPM)	Maximum AirFlow (CMM) (CFM)	Maximum Pressure (InAq) (mmAq)	*Noise Level (dB/A)	Weight (g)
AD7025GL-7	70x70x25	AD0712LB-A70GL(T)	○※○●	12	0.10	1.20	3300	0.80 28.20	0.15 3.81	31.6	61
	70x70x25	AD0712MB-A70GL(T)	○※○●	12	0.12	1.44	3800	0.91 32.30	0.18 4.47	33.6	61
	70x70x25	AD0712HB-A70GL(T)	○※○●	12	0.18	2.16	4200	1.01 35.50	0.22 5.51	38.0	61
	70x70x25	AD0712UB-A70GL(T)	○※○●	12	0.20	2.40	4500	1.10 38.90	0.25 6.25	38.9	61
	70x70x25	AD0724MB-A70GL(T)	○※○●	24	0.09	2.40	3800	0.91 32.30	0.18 4.47	33.6	61
	70x70x25	AD0724HB-A70GL(T)	○※○●	24	0.11	3.12	4200	1.01 35.50	0.22 5.51	38.0	61
AD7038DS-7	70x70x38	AD0712UB-F7BDS	○	12	0.62	7.44	6500	1.71 60.30	0.67 16.97	57.60	95
AD8015-7	80x80x15	AD0805MB-D71	○※○●	5	0.13	0.65	2440	0.62 21.81	0.08 1.98	24.9	62
	80x80x15	AD0805HB-D71	○※○●	5	0.22	1.10	3200	0.84 29.72	0.12 3.10	34.4	62
	80x80x15	AD0812LB-D71	○※○●	12	0.04	0.48	2000	0.52 18.34	0.05 1.32	18.8	62
	80x80x15	AD0812MB-D71	○※○●	12	0.05	0.60	2440	0.62 21.81	0.08 1.98	24.9	62
	80x80x15	AD0812HB-D71	○※○●	12	0.11	1.32	3200	0.84 29.72	0.12 3.10	34.4	62
	80x80x15	AD0812UB-D71	○※○●	12	0.16	1.92	3800	0.97 34.34	0.17 4.39	38.1	62
	80x80x15	AD0824MB-D71	○※○●	24	0.05	1.20	2440	0.62 21.81	0.08 1.98	24.9	62
	80x80x15	AD0824HB-D71	○※○●	24	0.08	1.92	3200	0.84 29.72	0.12 3.10	34.4	62
AD8015-7	80x80x15	AD0812LB-D7B	○※●	12	0.08	1.08	2500	0.65 22.95	0.08 1.63	25.8	63
	80x80x15	AD0812MB-D7B	○※●	12	0.10	1.20	3000	0.81 28.63	0.13 3.25	30.9	63
	80x80x15	AD0812HB-D7B	○※●	12	0.11	1.32	3500	0.89 31.50	0.15 3.81	36.5	63
	80x80x15	AD0812UB-D7B	○※●	12	0.17	2.04	4000	1.04 36.71	0.20 5.00	39.6	63
	80x80x15	AD0812XB-D7B	○※●	12	0.22	2.64	4500	1.18 41.78	0.24 6.25	43.4	63
	80x80x15	AD0812VB-D7B	○●	12	0.26	3.12	5000	1.30 46.00	0.29 7.37	46.5	63
AD8015(T)-7	80x80x15	AD0812LB-D70(T)	○※●	12	0.06	0.72	2000	0.52 18.34	0.05 1.32	18.8	62
	80x80x15	AD0812MB-D70(T)	○※●	12	0.08	0.96	2440	0.62 21.81	0.08 1.98	24.9	62
	80x80x15	AD0812HB-D70(T)	○※●	12	0.11	1.32	3200	0.84 29.72	0.12 3.10	34.4	62
	80x80x15	AD0824MB-D70(T)	○※●	24	0.04	0.96	2440	0.62 21.81	0.08 1.98	24.9	62
	80x80x15	AD0824HB-D70(T)	○※●	24	0.08	1.92	3200	0.84 29.72	0.12 3.10	34.4	62
AD8015GP-9	80x80x15	AD0812LB-D9*GP	○※●	12	0.07	0.84	2000	0.64 22.64	0.06 1.45	22.1	63
	80x80x15	AD0812MB-D9*GP	○※●	12	0.11	1.32	2500	0.82 28.91	0.09 2.16	29.6	63
	80x80x15	AD0812HB-D9*GP	○※●	12	0.13	1.56	3000	1.01 35.52	0.13 3.33	35.3	63
	80x80x15	AD0812UB-D9*GP	○※●	12	0.18	2.16	3500	1.15 40.69	0.16 4.14	39.7	63
	80x80x15	AD0812XB-D9*GP	○	12	0.29	3.48	4000	1.31 46.35	0.20 5.00	42.7	63
AD8015(T)-9	80x80x15	AD0812DB-D90(T)	○※●	12	0.07	0.84	2500	0.71 24.96	0.09 2.18	30.2	63
	80x80x15	AD0812LB-D90(T)	○※●	12	0.10	1.20	3000	0.84 29.58	0.12 2.97	36.0	63
	80x80x15	AD0812MB-D90(T)	○※●	12	0.14	1.68	3500	0.99 34.90	0.16 3.94	40.4	63
	80x80x15	AD0812HB-D90(T)	○※●	12	0.20	2.40	4000	1.14 40.11	0.20 4.95	44.5	63



# DC Fan

- AD 15mm ~ 172mm / Thickness : min 06mm ~ max 51mm
- AS 40mm ~ 140mm / Thickness : min 28mm ~ max 76mm
- AG 20mm ~ 127mm / Thickness : min 10mm ~ max 38mm



80x80x76



40x40x28

Bearing type: ○=Ball ※=Sleeve ◐=1B1S ●=Hypro Bearing

	Frame size (mm)	Model No.	Bearing Type	Rated Voltage (VDC)	Current (A)	Power (W)	Rated Speed (RPM)	Maximum AirFlow (CMM)	Maximum AirFlow (CFM)	Maximum Pressure (InAq)	Maximum Pressure (mmAq)	*Noise Level (dB/A)	Weight (g)
AD8015(T)-9	80x80x15	AD0812UB-D90(T)	○※●	12	0.26	3.12	4500	1.27	45.02	0.25	6.30	48.0	63
	80x80x15	AD0824DB-D90(T)	○※●	24	0.04	0.96	2500	0.71	24.96	0.09	2.18	30.2	63
	80x80x15	AD0824LB-D90(T)	○※●	24	0.05	1.20	3000	0.84	29.58	0.12	2.97	36.0	63
	80x80x15	AD0824MB-D90(T)	○※●	24	0.06	1.44	3500	0.99	34.90	0.16	3.94	40.4	63
	80x80x15	AD0824HB-D90(T)	○※●	24	0.10	2.40	4000	1.14	40.11	0.20	4.95	44.5	63
	80x80x15	AD0824UB-D90(T)	○※●	24	0.14	3.36	4500	1.27	45.02	0.25	6.30	48.0	63
AD8020-7	80x80x20	AD0805MB-C71(N)	○※●	5	0.17	0.85	2440	0.63	22.27	0.10	2.49	28.1	68
	80x80x20	AD0805HB-C71(N)	○※●	5	0.24	1.20	3000	0.78	27.55	0.16	4.01	34.0	68
	80x80x20	AD0812MB-C71(N)	○※●	12	0.07	0.84	2440	0.63	22.27	0.10	2.49	28.1	68
	80x80x20	AD0812HB-C71(N)	○※●	12	0.13	1.56	3000	0.78	27.55	0.16	4.01	34.0	68
	80x80x20	AD0812UB-C71(N)	○※●	12	0.25	3.00	4200	1.10	38.89	0.27	6.93	43.5	68
	80x80x20	AD0824HB-C71(N)	○※●	24	0.07	1.68	3000	0.78	27.55	0.16	4.01	34.0	68
AD8020-7	80x80x20	AD0812LB-C7B	○※●	12	0.05	0.60	2000	0.51	17.91	0.07	1.80	22.9	69
	80x80x20	AD0812MB-C7B	○※●	12	0.07	0.84	2500	0.65	23.00	0.11	2.79	28.0	69
	80x80x20	AD0812HB-C7B	○※●	12	0.10	1.20	3000	0.78	27.72	0.16	3.99	32.2	69
	80x80x20	AD0812UB-C7B	○※●	12	0.14	1.68	3500	0.92	32.50	0.20	5.08	37.5	69
	80x80x20	AD0812XB-C7B	○※●	12	0.18	2.16	4000	1.05	37.17	0.26	6.55	41.0	69
	80x80x20	AD0812VB-C7B	○※●	12	0.20	2.40	4500	1.18	41.57	0.33	8.31	45.0	69
AD8020(T)-7	80x80x20	AD0812LB-C70(T)	○※●	12	0.06	0.72	2100	0.53	18.86	0.07	1.88	23.8	68
	80x80x20	AD0812MB-C70(T)	○※●	12	0.08	0.96	2500	0.66	23.35	0.09	2.31	27.4	68
	80x80x20	AD0812HB-C70(T)	○※●	12	0.13	1.56	3100	0.81	28.57	0.15	3.78	34.9	68
	80x80x20	AD0812UB-C70(T)	○※●	12	0.18	2.16	3750	1.00	35.17	0.22	5.54	40.1	68
	80x80x20	AD0824MB-C70(T)	○※●	24	0.04	0.96	2500	0.66	23.35	0.09	2.31	27.4	68
	80x80x20	AD0824HB-C70(T)	○※●	24	0.06	1.44	3100	0.81	28.57	0.15	3.78	34.9	68
AD8020(T)-7	80x80x20	AD08012MX207000	※●	12	0.08	0.96	2500	0.79	27.72	0.12	3.12	26.9	75
	80x80x20	AD08012HX207000	※●	12	0.12	1.44	3000	0.97	34.13	0.18	4.60	33.1	75
	80x80x20	AD08012UX207000	※●	12	0.22	2.64	3600	1.15	40.70	0.26	6.50	38.3	75
AD8025GL-7	80x80x25	AD0812DB-A71GL(N)	○※●	12	0.04	0.48	1600	0.61	21.61	0.05	1.17	14.0	86
	80x80x25	AD0812LB-A71GL(N)	○※●	12	0.06	0.72	2000	0.76	26.80	0.08	1.98	21.6	86
	80x80x25	AD0812MB-A71GL(N)	○※●	12	0.09	1.08	2500	0.95	33.40	0.12	2.97	28.3	86
	80x80x25	AD0812HB-A71GL(N)	○※●	12	0.16	1.92	3000	1.14	40.26	0.15	3.91	33.4	86
	80x80x25	AD0812UB-A71GL(N)	○※●	12	0.30	3.60	3900	1.49	52.49	0.27	6.73	40.8	86
	80x80x25	AD0812XB-A71GL(N)	○※●	12	0.33	3.96	4200	1.61	56.77	0.30	7.70	43.4	86
	80x80x25	AD0824MB-A71GL(N)	○※●	24	0.06	1.44	2500	0.95	33.40	0.12	2.97	28.3	86
	80x80x25	AD0824HB-A71GL(N)	○※●	24	0.09	2.16	3000	1.14	40.26	0.15	3.91	33.4	86



40x40x56



120x120x38



60x60x25



140x140x51

\*:Noise is measured at the distance of 1 meter from the axis of intake.  
Specifications are subject to change without prior notice.

Bearing type: ●=Ball ※=Sleeve ○=1B1S ●=Hypro Bearing

	Frame size (mm)	Model No.	Bearing Type	Rated Voltage (VDC)	Current (A)	Power (W)	Rated Speed (RPM)	Maximum AirFlow (CMM) (CFM)	Maximum Pressure (InAq) (mmAq)	*Noise Level (dB/A)	Weight (g)
<b>AD8025GL-7</b>	80x80x25	AD0824UB-A71GL(N)	◎※●	24	0.15	3.60	3900	1.49 52.49	0.27 6.73	40.8	86
	80x80x25	AD0812LB-A70GL(TCA)	◎※○●	12	0.08	0.96	2100	0.80 28.39	0.08 1.91	22.1	86
<b>AD8025GL(T)-7</b>	80x80x25	AD0812MB-A70GL(TCA)	◎※○●	12	0.12	1.44	2500	0.95 33.40	0.12 2.97	28.3	86
	80x80x25	AD0812HB-A70GL(TCA)	◎※○●	12	0.21	2.52	3000	1.14 40.26	0.15 3.91	33.4	86
	80x80x25	AD0812UB-A70GL(TCA)	◎※○●	12	0.23	2.76	3400	1.31 46.13	0.20 5.11	38.5	86
<b>AD8025-7</b>	80x80x25	AD08012LB2576A0(OHT)	◎	12	0.08	0.96	2000	0.66 23.31	0.08 2.08	23.6	93.5
	80x80x25	AD08012MB2576A0(OHT)	◎	12	0.14	1.68	3000	1.03 36.29	0.18 4.45	32.9	93.5
	80x80x25	AD08012HB2576A0(OHT)	◎	12	0.21	2.52	3700	1.27 44.76	0.25 6.27	37.9	93.5
<b>AD8025GP-7</b>	80x80x25	AD0812HB-A73GP	◎	12	0.17	2.04	3500	1.41 49.70	0.20 5.08	38.5	95
	80x80x25	AD0812UB-A73GP	◎	12	0.27	3.24	4000	1.59 56.00	0.25 6.35	43.5	95
	80x80x25	AD0812XB-A73GP	◎	12	0.35	4.20	4500	1.90 67.00	0.30 7.62	46.0	95
	80x80x25	AD0812VB-A73GP	◎	12	0.53	6.36	5000	2.04 72.00	0.36 9.14	49.0	95
	80x80x25	AD0824HB-A73GP	◎	24	0.10	2.40	3500	1.41 49.70	0.20 5.08	38.5	95
	80x80x25	AD0824UB-A73GP	◎	24	0.13	3.12	4000	1.59 56.00	0.25 6.35	43.5	95
	80x80x25	AD0824XB-A73GP	◎	24	0.18	4.32	4500	1.90 67.00	0.30 7.62	46.0	95
	80x80x25	AD0824VB-A73GP	◎	24	0.26	6.24	5000	2.04 72.00	0.36 9.14	49.0	95
	80x80x25	AD0848HB-A73GP	◎	48	0.07	3.36	3500	1.41 49.70	0.20 5.08	38.5	95
	80x80x25	AD0848UB-A73GP	◎	48	0.10	4.80	4000	1.59 56.00	0.25 6.35	43.5	95
80x80x25	AD0848XB-A73GP	◎	48	0.12	5.76	4500	1.90 67.00	0.30 7.62	46.0	95	
80x80x25	AD0848VB-A73GP	◎	48	0.13	6.24	4500	2.04 72.00	0.36 9.14	49.0	95	
<b>AD8025(T)-7</b>	80x80x25	AD0812DB-A70GL(T)	◎※○●	12	0.05	0.60	1600	0.58 20.57	0.04 1.09	16.5	86
	80x80x25	AD0812LB-A70GL(T)	◎※○●	12	0.08	0.96	2100	0.77 27.02	0.07 1.83	22.3	86
	80x80x25	AD0812MB-A70GL(T)	◎※○●	12	0.12	1.44	2500	0.92 32.38	0.10 2.59	29.4	86
	80x80x25	AD0812HB-A70GL(T)	◎※○●	12	0.21	2.52	3000	1.09 38.65	0.14 3.61	35.2	86
	80x80x25	AD0812UB-A70GL(T)	◎※○●	12	0.23	2.76	3400	1.23 43.29	0.17 4.24	37.4	86
	80x80x25	AD0824LB-A70GL(T)	◎※○●	24	0.04	0.96	2100	0.77 27.02	0.07 1.83	22.3	86
	80x80x25	AD0824MB-A70GL(T)	◎※○●	24	0.07	1.68	2500	0.92 32.38	0.10 2.59	29.4	86
80x80x25	AD0824HB-A70GL(T)	◎※○●	24	0.10	2.40	3200	1.14 40.40	0.17 4.24	37.4	86	
<b>AG8025(T)-7</b>	80x80x25	AG08012DB257000	◎※●	12	0.05	0.60	1500	0.49 17.33	0.05 1.14	15.0	86
	80x80x25	AG08012LB257000	◎※●	12	0.06	0.72	2000	0.67 23.60	0.08 1.98	22.4	86
	80x80x25	AG08012MB257000	◎※●	12	0.09	1.08	2500	0.84 29.81	0.13 3.18	29.3	86
	80x80x25	AG08012HB257000	◎※●	12	0.15	1.80	3000	1.01 35.70	0.17 4.42	34.0	86
	80x80x25	AG08012UB257000	◎※●	12	0.24	2.88	3600	1.22 43.11	0.24 6.05	38.9	86
	80x80x25	AG08024DB257000	◎※●	24	0.02	0.48	1500	0.49 17.33	0.05 1.14	15.0	86
	80x80x25	AG08024LB257000	◎※●	24	0.03	0.72	2000	0.67 23.60	0.08 1.98	22.4	86

# DC Fan

- AD 15mm ~ 172mm / Thickness : min 06mm ~ max 51mm
- AS 40mm ~ 140mm / Thickness : min 28mm ~ max 76mm
- AG 20mm ~ 127mm / Thickness : min 10mm ~ max 38mm



80x80x76



40x40x28

Bearing type: ◎=Ball ※=Sleeve ○=1B1S ●=Hypro Bearing

	Frame size (mm)	Model No.	Bearing Type	Rated Voltage (VDC)	Current (A)	Power (W)	Rated Speed (RPM)	Maximum AirFlow (CMM) (CFM)	Maximum Pressure (InAq) (mmAq)	*Noise Level (dB/A)	Weight (g)
AG8025(T)-7	80x80x25	AG08024MB257000	◎※ ●	24	0.05	1.20	2500	0.84 29.81	0.13 3.18	29.3	86
	80x80x25	AG08024HB257000	◎※ ●	24	0.10	2.40	3000	1.01 35.70	0.17 4.42	34.0	86
	80x80x25	AG08024UB257000	◎※ ●	24	0.13	3.12	3600	1.22 43.11	0.24 6.05	38.9	86
AG8025-7	80x80x25	AG08012XB257100	◎	12	0.33	3.96	4500	1.53 54.06	0.38 9.65	45.0	86
AS8025-9	80x80x25	AS08012XB259B00	◎	12	0.48	5.76	4500	1.93 68.20	0.35 8.86	52.0	86
AD8032-5	80x80x32	AD0812LB-Y51(N)	◎	12	0.11	1.32	3000	1.12 39.58	0.19 4.75	35.5	108
	80x80x32	AD0812MB-Y51(N)	◎	12	0.16	1.92	3400	1.27 44.76	0.24 6.12	36.7	108
	80x80x32	AD0812HB-Y51(N)	◎	12	0.19	2.28	3800	1.39 49.00	0.29 7.42	42.4	108
	80x80x32	AD0812UB-Y51(NCU)	◎	12	0.23	2.76	4200	1.57 55.39	0.32 8.03	44.0	108
	80x80x32	AD0824LB-Y51(N)	◎	24	0.07	1.68	3000	1.12 39.58	0.19 4.75	35.5	108
	80x80x32	AD0824MB-Y51(N)	◎	24	0.10	2.40	3400	1.27 44.76	0.24 6.12	36.7	108
	80x80x32	AD0824HB-Y51(N)	◎	24	0.12	2.88	3800	1.39 49.00	0.29 7.42	42.4	108
	80x80x32	AD0824UB-Y51(NCU)	◎	24	0.15	3.60	4200	1.57 55.39	0.32 8.03	44.0	108
	80x80x32	AD0848LB-Y51	◎	48	0.06	2.88	3000	1.12 39.58	0.19 4.75	35.5	108
	80x80x32	AD0848MB-Y51	◎	48	0.07	3.36	3400	1.27 44.76	0.24 6.12	36.7	108
	80x80x32	AD0848HB-Y51	◎	48	0.08	3.84	3800	1.39 49.00	0.29 7.42	42.4	108
	80x80x32	AD0848UB-Y51(NCU)	◎	48	0.11	5.28	4200	1.57 55.39	0.32 8.03	44.0	108
AD8032-7	80x80x32	AD08012DB327B00	◎	12	0.13	1.56	3000	1.17 41.20	0.21 5.21	34.0	135
	80x80x32	AD08012LB327B00	◎	12	0.25	3.00	3800	1.48 52.20	0.32 8.13	40.4	135
	80x80x32	AD08012MB327B00	◎	12	0.35	4.20	4600	1.82 64.40	0.48 12.19	45.6	135
	80x80x32	AD08012HB327B00	◎	12	0.50	6.00	5400	2.12 74.80	0.64 16.26	50.2	135
	80x80x32	AD08012UB327B00	◎	12	0.76	9.12	6200	2.49 87.90	0.84 21.34	53.5	135
	80x80x32	AD08012XB327B00	◎	12	1.15	13.80	7000	2.75 97.00	1.04 26.42	58.0	135
	80x80x32	AD08024DB327B00	◎	24	0.10	2.40	3000	1.17 41.20	0.21 5.21	34.0	135
	80x80x32	AD08024LB327B00	◎	24	0.12	2.88	3800	1.48 52.20	0.32 8.13	40.4	135
	80x80x32	AD08024MB327B00	◎	24	0.18	4.32	4600	1.82 64.40	0.48 12.19	45.6	135
	80x80x32	AD08024HB327B00	◎	24	0.28	6.72	5400	2.12 74.80	0.64 16.26	50.2	135
	80x80x32	AD08024UB327B00	◎	24	0.44	10.56	6200	2.49 87.90	0.84 21.34	53.5	135
	80x80x32	AD08024XB327B00	◎	24	0.56	13.44	7000	2.75 97.00	1.04 26.42	58.0	135
AD8038-7	80x80x38	AD0812DB-F71(N)	◎	12	0.07	0.84	2000	0.87 30.66	0.09 2.21	25.5	120
	80x80x38	AD0812LB-F71(N)	◎	12	0.10	1.20	2500	1.10 38.73	0.13 3.35	32.3	120
	80x80x38	AD0812MB-F71(N)	◎	12	0.17	2.04	3000	1.30 46.06	0.17 4.24	36.0	120
	80x80x38	AD0812HB-F71(N)	◎	12	0.26	3.12	3500	1.51 53.31	0.22 5.64	39.9	120
	80x80x38	AD0812UB-F71(N)	◎	12	0.34	4.08	4000	1.76 62.16	0.32 8.10	43.7	120
	80x80x38	AD0824LB-F71(N)	◎	24	0.08	1.92	2500	1.10 38.73	0.13 3.35	32.3	120



40x40x56



120x120x38



60x60x25



140x140x51

\*:Noise is measured at the distance of 1 meter from the axis of intake.  
Specifications are subject to change without prior notice.

Bearing type: ◎=Ball ※=Sleeve ○=1B1S ●=Hypro Bearing

	Frame size (mm)	Model No.	Bearing Type	Rated Voltage (VDC)	Current (A)	Power (W)	Rated Speed (RPM)	Maximum AirFlow (CMM)	Maximum AirFlow (CFM)	Maximum Pressure (InAq)	Maximum Pressure (mmAq)	*Noise Level (dB/A)	Weight (g)
<b>AD8038-7</b>	80x80x38	AD0824MB-F71(N)	◎	24	0.10	2.40	3000	1.30	46.06	0.17	4.24	36.0	120
	80x80x38	AD0824HB-F71(N)	◎	24	0.14	3.36	3500	1.51	53.31	0.22	5.64	39.9	120
<b>AD8038DS-7</b>	80x80x38	AD0812HB-F7BDS	◎	12	0.54	6.48	4800	2.12	75.00	0.49	12.45	50.5	195
	80x80x38	AD0812UB-F7BDS	◎	12	0.86	10.32	5500	2.49	88.00	0.66	16.76	55.0	195
	80x80x38	AD0812XB-F7BDS	◎	12	1.25	15.00	6200	2.75	97.00	0.80	20.32	57.0	195
	80x80x38	AD0812VB-F7BDS	◎	12	2.05	24.60	7000	3.12	110.00	1.05	26.67	60.5	195
	80x80x38	AD0824HB-F7BDS	◎	24	0.30	7.20	4800	2.12	75.00	0.49	12.45	50.5	195
	80x80x38	AD0824UB-F7BDS	◎	24	0.44	10.56	5500	2.49	88.00	0.66	16.76	55.0	195
	80x80x38	AD0824XB-F7BDS	◎	24	0.54	12.96	6200	2.75	97.00	0.80	20.32	57.0	195
	80x80x38	AD0848HB-F7BDS	◎	48	0.15	7.20	4800	2.12	75.00	0.49	12.45	50.5	195
	80x80x38	AD0848UB-F7BDS	◎	48	0.23	11.04	5500	2.49	88.00	0.66	16.76	55.0	195
	80x80x38	AD0848XB-F7BDS	◎	48	0.30	14.40	6200	2.75	97.00	0.80	20.32	57.0	195
<b>AS8038-9</b>	80x80x38	AS08012DB389B00	◎	12	0.80	9.60	6000	2.33	82.23	0.90	22.96	55.0	212
	80x80x38	AS08012LB389B00	◎	12	1.25	15.00	7000	2.82	99.44	1.21	30.78	58.9	212
	80x80x38	AS08012MB389B00	◎	12	1.80	21.60	8000	3.23	114.01	1.62	41.02	61.9	212
	80x80x38	AS08012HB389B00	◎	12	2.50	30.00	9000	3.79	133.70	2.01	51.05	64.6	212
	80x80x38	AS08024DB389B00	◎	24	0.37	8.88	6000	2.33	82.23	0.90	22.96	55.0	212
	80x80x38	AS08024LB389B00	◎	24	0.59	14.16	7000	2.82	99.44	1.21	30.78	58.9	212
	80x80x38	AS08024MB389B00	◎	24	0.80	19.20	8000	3.23	114.01	1.62	41.02	61.9	212
	80x80x38	AS08024HB389B00	◎	24	1.12	26.88	9000	3.79	133.70	2.01	51.05	64.6	212
	80x80x38	AS08048DB389B00	◎	48	0.21	10.08	6000	2.33	82.23	0.90	22.96	55.0	212
	80x80x38	AS08048LB389B00	◎	48	0.32	15.36	7000	2.82	99.44	1.21	30.78	58.9	212
<b>AS8038-5</b>	80x80x38	AS08048MB389B00	◎	48	0.43	20.64	8000	3.23	114.01	1.62	41.02	61.9	212
	80x80x38	AS08048HB389B00	◎	48	0.57	27.36	9000	3.79	133.70	2.01	51.05	64.6	212
<b>AS8038-5</b>	80x80x38	AS08012LB385BB1	◎	12	1.15	13.80	12000	2.48	87.40	2.30	58.52	64.6	208
	80x80x38	AS08012MB385BB1	◎	12	1.70	20.40	14000	2.90	102.28	2.75	69.85	68.3	208
	80x80x38	AS08012HB385BB1	◎	12	2.34	28.08	16000	3.45	121.69	4.39	111.58	71.8	208
<b>AS8038-5</b>	80x80x38	AS08012LB385BB2	◎	12	1.45	17.40	9500	2.84	100.37	2.08	52.83	65.4	219
	80x80x38	AS08012MB385BB2	◎	12	2.30	27.60	11500	3.45	121.83	2.91	73.91	67.6	219
<b>AS8076-5</b>	80x80x76	AS08012DB765300	◎	12	1.40	16.80	in:5500/ out:5700	2.63	93.01	0.94	23.90	63.7	395
	80x80x76	AS08012LB765300	◎	12	1.90	22.80	in:6400/ out:7000	3.16	111.42	1.39	35.41	67.2	395

# DC Fan

- AD 15mm ~ 172mm / Thickness : min 06mm ~ max 51mm
- AS 40mm ~ 140mm / Thickness : min 28mm ~ max 76mm
- AG 20mm ~ 127mm / Thickness : min 10mm ~ max 38mm



80x80x76



40x40x28

Bearing type: ◎=Ball ※=Sleeve ○=1B1S ●=Hypro Bearing

	Frame size (mm)	Model No.	Bearing Type	Rated Voltage (VDC)	Current (A)	Power (W)	Rated Speed (RPM)	Maximum AirFlow (CMM) (CFM)	Maximum Pressure (InAq) (mmAq)	*Noise Level (dB/A)	Weight (g)
AS8076-5	80x80x76	AS08012MB765300	◎	12	3.10	37.20	in:7200/ out:8300	3.64 128.57	1.89 47.90	72.4	395
	80x80x76	AS08012HB765300	◎	12	4.60	55.20	in:8500/ out:10000	4.55 160.69	2.72 69.01	77.1	395
AD9220-7	92x92x20	AD0912MB-C71(N)	◎※●	12	0.09	1.08	2430	0.80 28.36	0.10 2.57	34.0	81
	92x92x20	AD0912HB-C71(N)	◎※●	12	0.11	1.32	2700	0.90 31.66	0.12 3.10	36.7	81
	92x92x20	AD0924MB-C71(N)	◎※●	24	0.07	1.68	2430	0.80 28.36	0.10 2.57	34.0	81
	92x92x20	AD0924HB-C71(N)	◎※●	24	0.09	2.16	2700	0.90 31.66	0.12 3.10	36.7	81
AD9220(T)-7	92x92x20	AD0912MB-C70(T)	◎※●	12	0.12	1.44	2430	0.80 28.36	0.10 2.57	34.0	81
	92x92x20	AD0912HB-C70(T)	◎※●	12	0.15	1.80	2700	0.90 31.66	0.12 3.10	36.7	81
	92x92x20	AD0924MB-C70(T)	◎※●	24	0.06	1.44	2430	0.80 28.36	0.10 2.57	34.0	81
	92x92x20	AD0924HB-C70(T)	◎※●	24	0.09	2.16	2700	0.90 31.66	0.12 3.10	36.7	81
AD9225GL-7	92x92x25	AD0912DB-A71GL(N)	◎※●	12	0.05	0.60	1600	0.86 30.30	0.03 0.86	19.1	92
	92x92x25	AD0912LB-A71GL(N)	◎※●	12	0.09	1.08	2300	1.25 43.99	0.09 2.36	30.0	92
	92x92x25	AD0912MB-A71GL(N)	◎※●	12	0.14	1.68	2600	1.40 49.36	0.12 3.15	34.5	92
	92x92x25	AD0912HB-A71GL(N)	◎※●	12	0.18	2.16	2900	1.59 56.07	0.15 3.71	37.5	92
	92x92x25	AD0912UB-A71GL(N)	◎※●	12	0.27	3.24	3300	1.75 61.93	0.19 4.75	42.2	92
	92x92x25	AD0924LB-A71GL(N)	◎※●	24	0.08	1.92	2300	1.25 43.99	0.09 2.36	30.0	92
	92x92x25	AD0924MB-A71GL(N)	◎※●	24	0.09	2.16	2600	1.40 49.36	0.12 3.15	34.5	92
	92x92x25	AD0924HB-A71GL(N)	◎※●	24	0.11	2.64	2900	1.59 56.07	0.15 3.71	37.5	92
	92x92x25	AD0924UB-A71GL(N)	◎※●	24	0.16	3.84	3300	1.75 61.93	0.19 4.75	42.2	92
	92x92x25	AD0948HB-A71GL	◎	48	0.11	5.28	2900	1.59 56.07	0.15 3.71	37.5	92
AD9225GL(T)-7	92x92x25	AD0912DB-A70GL(HT)	◎※●	12	0.06	0.72	1600	0.86 30.30	0.03 0.86	19.1	92
	92x92x25	AD0912LB-A70GL(HT)	◎※●	12	0.10	1.20	2100	1.15 40.69	0.08 2.06	29.2	92
	92x92x25	AD0912MB-A70GL(HT)	◎※●	12	0.15	1.80	2400	1.26 44.66	0.10 2.57	31.2	92
	92x92x25	AD0912HB-A70GL(HT)	◎※●	12	0.24	2.88	2900	1.59 56.07	0.15 3.71	37.5	92
	92x92x25	AD0912UB-A70GL(HT)	◎※●	12	0.28	3.36	3300	1.75 61.93	0.19 4.75	42.2	92
	92x92x25	AD0924LB-A70GL(HT)	◎※●	24	0.05	1.20	2100	1.15 40.69	0.08 2.06	29.2	92
	92x92x25	AD0924MB-A70GL(HT)	◎※●	24	0.08	1.92	2400	1.26 44.66	0.10 2.57	31.2	92
	92x92x25	AD0924HB-A70GL(HT)	◎※●	24	0.15	3.60	2900	1.59 56.07	0.15 3.71	37.5	92
AG9225-7	92x92x25	AG09212DB257000	◎※●	12	0.05	0.60	1500	0.78 27.70	0.06 1.40	26.0	108
	92x92x25	AG09212LB257000	◎※●	12	0.09	1.08	2000	1.05 37.00	0.09 2.36	31.2	108
	92x92x25	AG09212MB257000	◎※●	12	0.17	2.04	2500	1.30 45.80	0.14 3.48	37.5	108
	92x92x25	AG09212HB257000	◎※●	12	0.24	2.88	3000	1.56 55.00	0.20 5.08	43.3	108
	92x92x25	AG09212UB257000	◎※●	12	0.31	3.72	3300	1.72 60.70	0.24 5.97	46.0	108



40x40x56



120x120x38



60x60x25



140x140x51

\*:Noise is measured at the distance of 1 meter from the axis of intake.  
Specifications are subject to change without prior notice.

Bearing type: ○=Ball ※=Sleeve ◯=1B1S ●=Hypro Bearing

	Frame size (mm)	Model No.	Bearing Type	Rated Voltage (VDC)	Current (A)	Power (W)	Rated Speed (RPM)	Maximum AirFlow (CMM)	Maximum AirFlow (CFM)	Maximum Pressure (InAq)	Maximum Pressure (mmAq)	*Noise Level (dB/A)	Weight (g)
AG9225-7	92x92x25	AG09212XB257000	○	12	0.45	5.40	3800	2.00	70.56	0.30	7.62	50.0	108
	92x92x25	AG09224DB257000	○※●	24	0.03	0.72	1500	0.78	27.70	0.06	1.40	26.0	108
	92x92x25	AG09224LB257000	○※●	24	0.06	1.44	2000	1.05	37.00	0.09	2.36	31.2	108
	92x92x25	AG09224MB257000	○※●	24	0.11	2.64	2500	1.30	45.80	0.14	3.48	37.5	108
	92x92x25	AG09224HB257000	○※●	24	0.14	3.36	3000	1.56	55.00	0.20	5.08	43.3	108
	92x92x25	AG09224UB257000	○※●	24	0.18	4.32	3300	1.72	60.70	0.24	5.97	46.0	108
AD9225GP-7	92x92x25	AD0912HB-A73GP	○	12	0.19	2.28	3000	1.77	62.50	0.19	4.70	39.5	103
	92x92x25	AD0912UB-A73GP	○	12	0.37	4.44	3500	2.04	72.00	0.23	5.84	44.0	103
	92x92x25	AD0912XB-A73GP	○	12	0.47	5.64	4000	2.36	83.50	0.28	7.11	48.0	103
	92x92x25	AD0924HB-A73GP	○	24	0.12	2.88	3000	1.77	62.50	0.19	4.70	39.5	103
	92x92x25	AD0924UB-A73GP	○	24	0.18	4.32	3500	2.04	72.00	0.23	5.84	44.0	103
	92x92x25	AD0924XB-A73GP	○	24	0.24	5.76	4000	2.36	83.50	0.28	7.11	48.0	103
	92x92x25	AD0948HB-A73GP	○	48	0.08	3.84	3000	1.77	62.50	0.19	4.70	39.5	103
	92x92x25	AD0948UB-A73GP	○	48	0.12	5.76	3500	2.04	72.00	0.23	5.84	44.0	103
	92x92x25	AD0948XB-A73GP	○	48	0.17	8.16	4000	2.36	83.50	0.28	7.11	48.0	103
AG9225(T)-7	92x92x25	AG09212DB257010	○	12	0.13	1.56	2000	1.09	38.37	0.08	2.13	26.3	108
	92x92x25	AG09212LB257010	○	12	0.16	1.92	2500	1.37	48.23	0.13	3.25	32.1	108
	92x92x25	AG09212MB257010	○	12	0.22	2.64	3000	1.64	57.77	0.20	5.08	36.5	108
	92x92x25	AG09212HB257010	○	12	0.31	3.72	3300	1.83	64.56	0.24	6.05	39.2	108
	92x92x25	AG09212UB257010	○	12	0.35	4.20	3600	2.01	71.00	0.28	7.16	42.0	108
	92x92x25	AG09224DB257010	○	24	0.05	1.20	2000	1.09	38.37	0.08	2.13	26.3	108
	92x92x25	AG09224LB257010	○	24	0.09	2.16	2500	1.37	48.23	0.13	3.25	32.1	108
	92x92x25	AG09224MB257010	○	24	0.14	3.36	3000	1.64	57.77	0.20	5.08	36.5	108
	92x92x25	AG09224HB257010	○	24	0.17	4.08	3300	1.83	64.56	0.24	6.05	39.2	108
92x92x25	AG09224UB257010	○	24	0.18	4.32	3600	2.01	71.00	0.28	7.16	42.0	108	
AD9232GL-7	92x92x32	AD0912LB-Y71GL(N)	○	12	0.20	2.40	2500	1.36	48.05	0.14	3.61	34.7	140
	92x92x32	AD0912MB-Y71GL(N)	○	12	0.33	3.96	3000	1.67	58.97	0.19	4.80	39.5	140
	92x92x32	AD0912HB-Y71GL(N)	○	12	0.43	5.16	3500	1.95	68.95	0.28	7.21	44.0	140
	92x92x32	AD0912UB-Y71GL(N)	○	12	0.64	7.68	3900	2.19	77.19	0.37	9.42	50.0	140
	92x92x32	AD0924LB-Y71GL(N)	○	24	0.18	4.32	2500	1.36	48.05	0.14	3.61	34.7	140
	92x92x32	AD0924MB-Y71GL(N)	○	24	0.21	5.04	3000	1.67	58.97	0.19	4.80	39.5	140
	92x92x32	AD0924HB-Y71GL(N)	○	24	0.35	8.40	3500	1.95	68.95	0.28	7.21	44.0	140
	92x92x32	AD0948LB-Y72GL(N)	○	48	0.09	4.32	2500	1.36	48.05	0.14	3.61	34.7	140
92x92x32	AD0948MB-Y72GL(N)	○	48	0.12	5.76	3000	1.67	58.97	0.19	4.80	39.5	140	
AD9238DS-9	92x92x38	AD0912HB-F9BDS	○	12	0.75	9.00	4400	3.06	108.00	0.50	12.70	52.5	210

# DC Fan

- AD 15mm ~ 172mm / Thickness : min 06mm ~ max 51mm
- AS 40mm ~ 140mm / Thickness : min 28mm ~ max 76mm
- AG 20mm ~ 127mm / Thickness : min 10mm ~ max 38mm



80x80x76



40x40x28

Bearing type: ◎=Ball ※=Sleeve ○=1B1S ●=Hypro Bearing

	Frame size (mm)	Model No.	Bearing Type	Rated Voltage (VDC)	Current (A)	Power (W)	Rated Speed (RPM)	Maximum AirFlow (CMM)	Maximum AirFlow (CFM)	Maximum Pressure (InAq)	Maximum Pressure (mmAq)	*Noise Level (dB/A)	Weight (g)
AD9238DS-9	92x92x38	AD0912UB-F9BDS	◎	12	0.98	10.92	4800	3.34	118.00	0.59	14.99	55.0	210
	92x92x38	AD0912XB-F9BDS	◎	12	1.38	16.56	5400	3.82	135.00	0.74	18.80	58.5	210
	92x92x38	AD0912VB-F9BDS	◎	12	2.25	27.00	6000	4.22	149.00	0.93	23.62	62.0	210
	92x92x38	AD0924HB-F9BDS	◎	24	0.33	7.92	4400	3.06	108.00	0.50	12.70	52.5	210
	92x92x38	AD0924UB-F9BDS	◎	24	0.47	11.28	4800	3.34	118.00	0.59	14.99	55.0	210
	92x92x38	AD0924XB-F9BDS	◎	24	0.65	15.60	5400	3.82	135.00	0.74	18.80	58.5	210
	92x92x38	AD0948HB-F9BDS	◎	48	0.19	9.12	4400	3.06	108.00	0.50	12.70	52.5	210
	92x92x38	AD0948UB-F9BDS	◎	48	0.25	12.00	4800	3.34	118.00	0.59	14.99	55.0	210
	92x92x38	AD0948XB-F9BDS	◎	48	0.35	16.80	5400	3.82	135.00	0.74	18.80	58.5	210
AD9238GP-9	92x92x38	AD0912HB-F9BGP	◎	12	0.75	9.00	4400	2.97	105.00	0.45	11.43	53.0	210
	92x92x38	AD0912UB-F9BGP	◎	12	0.98	11.76	4800	3.26	115.00	0.53	13.46	56.5	210
	92x92x38	AD0912XB-F9BGP	◎	12	1.38	16.56	5400	3.68	130.00	0.67	17.02	59.5	210
	92x92x38	AD0912VB-F9BGP	◎	12	2.20	26.40	6000	4.19	148.00	0.85	21.59	63.0	210
	92x92x38	AD0924HB-F9BGP	◎	24	0.33	7.92	4400	2.97	105.00	0.45	11.43	53.0	210
	92x92x38	AD0924UB-F9BGP	◎	24	0.47	11.28	4800	3.26	115.00	0.53	13.46	56.5	210
	92x92x38	AD0924XB-F9BGP	◎	24	0.65	15.60	5400	3.68	130.00	0.67	17.02	59.5	210
	92x92x38	AD0948HB-F9BGP	◎	48	0.19	9.12	4400	2.97	105.00	0.45	11.43	53.0	210
	92x92x38	AD0948UB-F9BGP	◎	48	0.25	12.00	4800	3.26	115.00	0.53	13.46	56.5	210
92x92x38	AD0948XB-F9BGP	◎	48	0.35	16.80	5400	3.68	130.00	0.67	17.02	59.5	210	
AS9238-9	92x92x38	AS09212LB389BB0	◎	12	0.98	12.00	5000	3.00	106.00	0.64	16.33	55.0	255
	92x92x38	AS09212MB389BB0	◎	12	1.55	19.00	6000	3.60	127.00	0.93	23.52	61.0	255
	92x92x38	AS09212HB389BB0	◎	12	2.24	27.00	7000	4.28	151.00	1.31	33.22	64.0	255
	92x92x38	AS09212UB389BB0	◎	12	3.50	42.00	8000	4.93	174.00	1.71	43.38	68.0	255
	92x92x38	AS09224LB389BB0	◎	24	0.55	13.00	5000	3.00	106.00	0.64	16.33	55.0	255
	92x92x38	AS09224MB389BB0	◎	24	0.80	19.00	6000	3.60	127.00	0.93	23.52	61.0	255
	92x92x38	AS09224HB389BB0	◎	24	1.15	28.00	7000	4.28	151.00	1.31	33.22	64.0	255
	92x92x38	AS09224UB389BB0	◎	24	1.80	43.00	8000	4.93	174.00	1.71	43.38	68.0	255
	92x92x38	AS09248LB389BB0	◎	48	0.30	14.00	5000	3.00	106.00	0.64	16.33	55.0	255
	92x92x38	AS09248MB389BB0	◎	48	0.45	22.00	6000	3.60	127.00	0.93	23.52	61.0	255
	92x92x38	AS09248HB389BB0	◎	48	0.60	29.00	7000	4.28	151.00	1.31	33.22	64.0	255
	92x92x38	AS09248UB389BB0	◎	48	0.90	43.00	8000	4.93	174.00	1.71	43.38	68.0	255
AD12025GL-7	120x120x25	AD1212DB-A71GL	◎※ ●	12	0.11	1.32	1500	1.62	57.21	0.07	1.88	27.2	156
	120x120x25	AD1212LB-A71GL	◎※ ●	12	0.15	1.80	1800	2.03	71.81	0.09	2.36	34.4	156
	120x120x25	AD1212MB-A71GL	◎※ ●	12	0.16	1.92	2050	2.30	81.05	0.11	2.87	38.0	156
	120x120x25	AD1212HB-A71GL(N)	◎※ ●	12	0.29	3.48	2200	2.49	87.87	0.13	3.40	39.1	156



40x40x56



120x120x38



60x60x25



140x140x51

\*:Noise is measured at the distance of 1 meter from the axis of intake.  
Specifications are subject to change without prior notice.

Bearing type: ○=Ball ※=Sleeve ◯=1B1S ●=Hypro Bearing

	Frame size (mm)	Model No.	Bearing Type	Rated Voltage (VDC)	Current (A)	Power (W)	Rated Speed (RPM)	Maximum AirFlow (CMM)	Maximum AirFlow (CFM)	Maximum Pressure (InAq)	Maximum Pressure (mmAq)	*Noise Level (dB/A)	Weight (g)
AD12025GL-7	120x120x25	AD1212UB-A71GL(N)	○※●	12	0.39	4.68	2500	2.80	98.97	0.17	4.42	43.3	156
	120x120x25	AD1224DB-A71GL(N)	○※●	24	0.07	1.68	1500	1.62	57.21	0.07	1.88	27.2	156
	120x120x25	AD1224LB-A71GL(N)	○※●	24	0.10	2.40	1800	2.03	71.81	0.09	2.36	34.4	156
	120x120x25	AD1224MB-A71GL(N)	○※●	24	0.13	3.12	2050	2.30	81.05	0.11	2.87	38.0	156
	120x120x25	AD1224HB-A71GL(N)	○※●	24	0.13	3.12	2200	2.49	87.87	0.13	3.40	39.1	156
	120x120x25	AD1224UB-A71GL(N)	○※●	24	0.19	4.56	2500	2.80	98.97	0.17	4.42	43.3	156
	120x120x25	AD1248HB-A71GL(N)	○※●	48	0.10	4.80	2200	2.49	87.87	0.13	3.40	39.1	156
	120x120x25	AD1248UB-A71GL(N)	○※●	48	0.12	5.76	2500	2.80	98.97	0.17	4.42	43.3	156
AG12025-7	120x120x25	AG12012DB257100	○※●	12	0.12	1.44	1900	1.63	57.66	0.12	3.15	31.1	185
	120x120x25	AG12012LB257100	○※●	12	0.15	1.80	2200	1.90	67.02	0.17	4.29	34.6	185
	120x120x25	AG12012MB257100	○※●	12	0.21	2.52	2500	2.15	76.08	0.21	5.38	38.4	185
	120x120x25	AG12012HB257100	○※●	12	0.30	3.60	3100	2.68	94.69	0.31	7.87	44.8	185
	120x120x25	AG12012UB257100	○※●	12	0.48	5.76	3600	3.01	106.27	0.39	9.96	49.1	185
	120x120x25	AG12012XB257100	○※●	12	0.80	9.60	4100	3.48	122.92	0.48	12.19	52.0	185
	120x120x25	AG12024DB257100	○※●	24	0.07	1.68	1900	1.63	57.66	0.12	3.15	31.1	185
	120x120x25	AG12024LB257100	○※●	24	0.08	1.92	2200	1.90	67.02	0.17	4.29	34.6	185
	120x120x25	AG12024MB257100	○※●	24	0.11	2.64	2500	2.15	76.08	0.21	5.38	38.4	185
	120x120x25	AG12024HB257100	○※●	24	0.16	3.84	3100	2.68	94.69	0.31	7.87	44.8	185
	120x120x25	AG12024UB257100	○※●	24	0.25	6.00	3600	3.01	106.27	0.39	9.96	49.1	185
	120x120x25	AG12024XB257100	○※●	24	0.32	7.68	4100	3.48	122.92	0.48	12.19	52.0	185
	120x120x25	AG12048LB257100	○※●	48	0.05	2.40	2200	1.90	67.02	0.17	4.29	34.6	185
	120x120x25	AG12048MB257100	○※●	48	0.06	2.88	2500	2.15	76.08	0.21	5.38	38.4	185
	120x120x25	AG12048HB257100	○※●	48	0.11	5.28	3100	2.68	94.69	0.31	7.87	44.8	185
	120x120x25	AG12048UB257100	○※●	48	0.14	6.72	3600	3.01	106.27	0.39	9.96	49.1	185
AS12025-11	120x120x25	AS12012LB25A100	○	12	0.66	7.92	2900	3.56	125.82	0.28	7.04	51.0	220
	120x120x25	AS12012MB25A100	○	12	0.84	10.08	3400	4.27	150.77	0.39	9.83	54.7	220
	120x120x25	AS12012HB25A100	○	12	1.06	12.72	3700	4.57	161.51	0.44	11.25	57.8	220
	120x120x25	AS12012UB25A100	○	12	1.42	17.04	4000	4.98	175.90	0.52	13.28	58.6	220
	120x120x25	AS12024LB25A100	○	24	0.28	6.72	2900	3.56	125.82	0.28	7.04	51.0	220
	120x120x25	AS12024MB25A100	○	24	0.43	10.32	3400	4.27	150.77	0.39	9.83	54.7	220
	120x120x25	AS12024HB25A100	○	24	0.55	13.20	3700	4.57	161.51	0.44	11.25	57.8	220
	120x120x25	AS12024UB25A100	○	24	0.71	17.04	4000	4.98	175.90	0.52	13.28	58.6	220
	120x120x25	AS12048LB25A100	○	48	0.17	8.16	2900	3.56	125.82	0.28	7.04	51.0	220
	120x120x25	AS12048MB25A100	○	48	0.23	11.04	3400	4.27	150.77	0.39	9.83	54.7	220
	120x120x25	AS12048HB25A100	○	48	0.30	14.40	3700	4.57	161.51	0.44	11.25	57.8	220



# DC Fan

- AD 15mm ~ 172mm / Thickness : min 06mm ~ max 51mm
- AS 40mm ~ 140mm / Thickness : min 28mm ~ max 76mm
- AG 20mm ~ 127mm / Thickness : min 10mm ~ max 38mm



80x80x76



40x40x28

Bearing type: ◎=Ball ※=Sleeve ○=1B1S ●=Hypro Bearing

	Frame size (mm)	Model No.	Bearing Type	Rated Voltage (VDC)	Current (A)	Power (W)	Rated Speed (RPM)	Maximum AirFlow (CMM)	Maximum AirFlow (CFM)	Maximum Pressure (InAq)	Maximum Pressure (mmAq)	*Noise Level (dB/A)	Weight (g)
<b>AS12025-11</b>	120x120x25	AS12048UB25A100	◎	48	0.37	17.76	4000	4.98	175.90	0.52	13.28	58.6	220
	120x120x25	AD12012DB257000	◎	12	0.06	0.72	1500	1.47	52.08	0.07	1.80	27.4	156
	120x120x25	AD12012LB257000	◎	12	0.12	1.44	1800	1.79	63.05	0.10	2.59	33.0	156
<b>AD12025(T)-7</b>	120x120x25	AD12012MB257000	◎	12	0.15	1.80	2050	2.02	71.30	0.13	3.35	36.3	156
	120x120x25	AD12012HB257000	◎	12	0.19	2.28	2200	2.19	77.21	0.15	3.86	38.4	156
	120x120x25	AD12012UB257000	◎	12	0.29	3.48	2500	2.54	89.84	0.19	4.85	41.6	156
<b>AD12025-7</b>	120x120x25	AD12012DB2571Z0	◎	12	0.11	1.32	1500	1.62	57.21	0.07	1.88	27.2	156
	120x120x25	AD12012LB2571Z0	◎	12	0.15	1.80	1800	2.03	71.81	0.09	2.36	34.4	156
	120x120x25	AD12012MB2571Z0	◎	12	0.16	1.92	2050	2.29	81.05	0.11	2.87	38.0	156
	120x120x25	AD12012HB2571Z0	◎	12	0.29	3.48	2200	2.49	87.87	0.13	3.40	39.1	156
	120x120x25	AD12012UB2571Z0	◎	12	0.39	4.68	2500	2.80	98.97	0.17	4.42	43.3	156
<b>AD12032-5</b>	120x120x32	AD1212DB-Y51	◎※ ●	12	0.08	0.96	1450	1.68	59.46	0.08	1.91	26.9	213
	120x120x32	AD1212LB-Y51	◎※ ●	12	0.19	2.28	2000	2.35	82.98	0.12	3.12	36.2	213
	120x120x32	AD1212MB-Y51	◎※ ●	12	0.26	3.12	2400	2.81	99.07	0.17	4.24	41.1	213
	120x120x32	AD1212HB-Y51	◎※ ●	12	0.32	3.84	2750	3.16	111.71	0.24	6.12	43.3	213
	120x120x32	AD1212UB-Y51	◎※ ●	12	0.51	6.12	3200	3.78	133.44	0.32	8.05	48.4	213
	120x120x32	AD1224DB-Y51	◎※ ●	24	0.05	1.20	1450	1.68	59.46	0.08	1.91	26.9	213
	120x120x32	AD1224LB-Y51	◎※ ●	24	0.10	2.40	2000	2.35	82.98	0.12	3.12	36.2	213
	120x120x32	AD1224MB-Y51	◎※ ●	24	0.16	3.84	2400	2.81	99.07	0.17	4.24	41.1	213
	120x120x32	AD1224HB-Y51	◎※ ●	24	0.21	5.04	2750	3.16	111.71	0.24	6.12	43.3	213
	120x120x32	AD1224UB-Y51	◎※ ●	24	0.32	7.68	3200	3.78	133.44	0.32	8.05	48.4	213
	120x120x32	AD1248HB-Y51	◎※ ●	48	0.11	5.28	2750	3.16	111.71	0.24	6.12	43.3	213
	120x120x32	AD1248UB-Y51	◎※ ●	48	0.15	7.20	3200	3.78	133.44	0.32	8.05	48.4	213
<b>AD12032(T)-5</b>	120x120x32	AD12012DB325000	◎	12	0.06	0.72	1450	1.55	54.81	0.08	2.01	25.7	213
	120x120x32	AD12012LB325000	◎	12	0.12	1.44	2000	2.18	76.91	0.15	3.76	35.3	213
	120x120x32	AD12012MB325000	◎	12	0.20	2.40	2400	2.59	91.61	0.19	4.80	40.0	213
	120x120x32	AD12012HB325000	◎	12	0.33	3.96	2750	3.02	106.49	0.23	5.94	45.4	213
<b>AD12038-5</b>	120x120x38	AD1212DB-F51(N)	◎※ ●	12	0.12	1.44	1500	1.62	57.29	0.09	2.16	28.4	297
	120x120x38	AD1212LB-F51(N)	◎※ ●	12	0.22	2.64	1950	2.03	71.64	0.13	3.25	36.2	297
	120x120x38	AD1212MB-F51(N)	◎※ ●	12	0.34	4.08	2540	2.73	96.30	0.23	5.79	45.0	297
	120x120x38	AD1212HB-F51(N)	◎※ ●	12	0.39	4.68	2800	2.99	105.46	0.27	6.73	46.7	297
	120x120x38	AD1212UB-F51(N)	◎※ ●	12	0.62	7.44	3200	3.40	120.11	0.34	8.51	48.0	297
	120x120x38	AD1224DB-F51(N)	◎※ ●	24	0.07	1.68	1500	1.62	57.29	0.09	2.16	28.4	297
	120x120x38	AD1224LB-F51(N)	◎※ ●	24	0.10	2.40	1950	2.03	71.64	0.13	3.25	36.2	297
	120x120x38	AD1224MB-F51(N)	◎※ ●	24	0.20	4.80	2540	2.73	96.30	0.23	5.79	45.0	297



40x40x56



120x120x38



60x60x25



140x140x51

\*:Noise is measured at the distance of 1 meter from the axis of intake.  
Specifications are subject to change without prior notice.

Bearing type: ○=Ball ※=Sleeve ◯=1B1S ●=Hypro Bearing

	Frame size (mm)	Model No.	Bearing Type	Rated Voltage (VDC)	Current (A)	Power (W)	Rated Speed (RPM)	Maximum AirFlow (CMM)	Maximum AirFlow (CFM)	Maximum Pressure (InAq)	Maximum Pressure (mmAq)	*Noise Level (dB/A)	Weight (g)
AD12038-5	120x120x38	AD1224HB-F51(N)	○※●	24	0.26	6.24	2800	2.99	105.46	0.27	6.73	46.7	297
	120x120x38	AD1224UB-F51(N)	○※●	24	0.38	9.12	3200	3.40	120.11	0.34	8.51	48.0	297
	120x120x38	AD1248LB-F51(N)	○※●	48	0.09	4.32	1950	2.03	71.64	0.13	3.25	36.2	297
	120x120x38	AD1248MB-F51(N)	○※●	48	0.13	6.24	2540	2.73	96.30	0.23	5.79	45.0	297
	120x120x38	AD1248HB-F51(N)	○※●	48	0.18	8.64	2800	2.99	105.46	0.27	6.73	46.7	297
	120x120x38	AD1248UB-F51(N)	○※●	48	0.22	10.56	3200	3.40	120.11	0.34	8.51	48.0	297
AS12038-9	120x120x38	AS12012DB389B00	○	12	0.60	7.20	3000	3.44	121.62	0.41	10.46	49.1	375
	120x120x38	AS12012LB389B00	○	12	1.30	15.60	4000	4.59	162.05	0.68	17.35	56.9	375
	120x120x38	AS12012MB389B00	○	12	2.30	27.60	5000	5.87	207.23	1.04	26.37	62.6	375
	120x120x38	AS12012HB389B00	○	12	3.70	44.40	6000	7.08	250.02	1.48	37.59	68.6	375
	120x120x38	AS12024DB389B00	○	24	0.35	8.40	3000	3.44	121.62	0.41	10.46	49.1	375
	120x120x38	AS12024LB389B00	○	24	0.65	15.60	4000	4.59	162.05	0.68	17.35	56.9	375
	120x120x38	AS12024MB389B00	○	24	1.05	25.20	5000	5.87	207.23	1.04	26.37	62.6	375
	120x120x38	AS12024HB389B00	○	24	1.75	42.00	6000	7.08	250.02	1.48	37.59	68.6	375
	120x120x38	AS12048DB389B00	○	48	0.20	9.60	3000	3.44	121.62	0.41	10.46	49.1	375
	120x120x38	AS12048LB389B00	○	48	0.35	16.80	4000	4.59	162.05	0.68	17.35	56.9	375
	120x120x38	AS12048MB389B00	○	48	0.55	26.40	5000	5.87	207.23	1.04	26.37	62.6	375
	120x120x38	AS12048HB389B00	○	48	0.85	40.80	6000	7.08	250.02	1.48	37.59	68.6	375
AD12038GP-9	120x120x38	AD1212DB-F91GP(F)	○	12	0.49	5.88	2800	3.70	130.54	0.30	7.49	48.5	335
	120x120x38	AD1212LB-F91GP(FCU)	○	12	0.70	8.40	3200	4.25	150.12	0.38	9.73	52.5	335
	120x120x38	AD1212MB-F91GP(FCU)	○	12	0.96	11.52	3800	5.14	181.60	0.53	13.46	57.5	335
	120x120x38	AD1212HB-F91GP(FM)	○	12	1.62	19.44	4300	5.66	199.73	0.63	15.88	61.0	335
	120x120x38	AD1224DB-F91GP(F)	○	24	0.23	5.52	2800	3.70	130.54	0.30	7.49	48.5	335
	120x120x38	AD1224LB-F91GP(FCU)	○	24	0.36	8.64	3200	4.25	150.12	0.38	9.73	52.5	335
	120x120x38	AD1224MB-F91GP(FCU)	○	24	0.58	13.92	3800	5.14	181.60	0.53	13.46	57.5	335
	120x120x38	AD1224HB-F91GP(FM)	○	24	0.80	19.20	4300	5.66	199.73	0.63	15.88	61.0	335
	120x120x38	AD1224UB-F91GP(FM)	○	24	1.15	27.60	4700	6.27	221.40	0.75	18.97	63.0	335
	120x120x38	AD1248DB-F91GP(F)	○	48	0.16	7.68	2800	3.70	130.54	0.30	7.49	48.5	335
	120x120x38	AD1248LB-F91GP(FCU)	○	48	0.18	8.64	3200	4.25	150.12	0.38	9.73	52.5	335
	120x120x38	AD1248MB-F91GP(FCU)	○	48	0.28	13.44	3800	5.14	181.60	0.53	13.46	57.5	335
	120x120x38	AD1248HB-F91GP(FM)	○	48	0.44	21.12	4300	5.66	199.73	0.63	15.88	61.0	335
	120x120x38	AD1248UB-F91GP(FM)	○	48	0.58	27.84	4700	6.27	221.40	0.75	18.97	63.0	335
AD12038(T)-5	120x120x38	AD12012DB385000(OF)	○	12	0.08	0.96	1500	1.52	53.68	0.09	2.18	28.0	235/ Plastic
	120x120x38	AD12012LB385000(OF)	○	12	0.15	1.80	1950	1.93	68.28	0.14	3.66	36.7	
	120x120x38	AD12012MB385000(OF)	○	12	0.33	3.96	2540	2.58	91.23	0.23	5.77	44.4	

# DC Fan

- AD 15mm ~ 172mm / Thickness : min 06mm ~ max 51mm
- AS 40mm ~ 140mm / Thickness : min 28mm ~ max 76mm
- AG 20mm ~ 127mm / Thickness : min 10mm ~ max 38mm



80x80x76



40x40x28

Bearing type: ◎=Ball ※=Sleeve ○=1B1S ●=Hypro Bearing

	Frame size (mm)	Model No.	Bearing Type	Rated Voltage (VDC)	Current (A)	Power (W)	Rated Speed (RPM)	Maximum AirFlow (CMM)	Maximum AirFlow (CFM)	Maximum Pressure (InAq)	Maximum Pressure (mmAq)	Noise Level (dB/A)	Weight (g)
<b>AD12038(T)-5</b>	120x120x38	AD12012HB385000(0F)	◎	12	0.48	5.76	2800	2.85	100.80	0.26	6.65	46.5	235/ Plastic
	127x127x38	AD1312LB-F51	◎	12	0.25	3.00	2000	3.04	107.49	0.16	4.11	41.0	370
	127x127x38	AD1312MB-F51	◎	12	0.38	4.56	2500	3.79	133.66	0.24	6.07	47.5	370
	127x127x38	AD1312HB-F51	◎	12	0.65	7.80	2950	4.56	161.17	0.35	8.89	53.0	370
	127x127x38	AD1312UB-F51(CU)	◎	12	1.06	12.72	3500	5.48	193.37	0.46	11.73	56.0	370
	127x127x38	AD1312XB-F51(M)	◎	12	1.95	23.40	4100	6.42	226.63	0.56	14.15	62.0	370
	127x127x38	AD1324LB-F51	◎	24	0.15	3.60	2000	3.04	107.49	0.16	4.11	41.0	370
	127x127x38	AD1324MB-F51	◎	24	0.22	5.28	2500	3.79	133.66	0.24	6.07	47.5	370
<b>AD12738-5</b>	127x127x38	AD1324HB-F51	◎	24	0.36	8.64	2950	4.56	161.17	0.35	8.89	53.0	370
	127x127x38	AD1324UB-F51(CU)	◎	24	0.50	12.00	3500	5.48	193.37	0.46	11.73	56.0	370
	127x127x38	AD1324XB-F51(M)	◎	24	0.94	22.56	4100	6.42	226.63	0.56	14.15	62.0	370
	127x127x38	AD1324VB-F51(M)	◎	24	1.10	26.40	4500	6.86	242.15	0.63	16.00	64.5	370
	127x127x38	AD1348LB-F51	◎	48	0.11	5.28	2000	3.04	107.49	0.16	4.11	41.0	370
	127x127x38	AD1348MB-F51	◎	48	0.15	7.20	2500	3.79	133.66	0.24	6.07	47.5	370
	127x127x38	AD1348HB-F51	◎	48	0.21	10.08	2950	4.56	161.17	0.35	8.89	53.0	370
	127x127x38	AD1348UB-F51(CU)	◎	48	0.31	14.88	3500	5.48	193.37	0.46	11.73	56.0	370
<b>AG12738-5</b>	127x127x38	AD1348XB-F51(M)	◎	48	0.50	24.00	4100	6.42	226.63	0.57	14.37	62.0	370
	127x127x38	AD1348VB-F51(M)	◎	48	0.64	30.72	4500	6.86	242.15	0.63	16.00	64.5	370
	127x127x38	AG12712LB385B00(0CU)	◎	12	0.29	3.48	3000	3.02	106.57	0.49	12.52	46.0	360
	127x127x38	AG12712MB385B00(0M)	◎	12	0.63	7.56	4000	4.06	143.42	0.77	19.66	53.9	360
	127x127x38	AG12712HB385B00(0M)	◎	12	0.83	9.96	4500	4.56	161.10	0.93	23.62	57.0	360
	127x127x38	AG12712UB385B00(0M)	◎	12	1.16	13.92	5000	5.02	177.38	1.09	27.64	59.4	360
	127x127x38	AG12724LB385B00(0CU)	◎	24	0.15	3.60	3000	3.02	106.57	0.49	12.52	46.0	360
	127x127x38	AG12724MB385B00(0M)	◎	24	0.30	7.20	4000	4.06	143.42	0.77	19.66	53.9	360
	127x127x38	AG12724HB385B00(0M)	◎	24	0.43	10.32	4500	4.56	161.10	0.93	23.62	57.0	360
	127x127x38	AG12724UB385B00(0M)	◎	24	0.55	13.20	5000	5.02	177.38	1.09	27.64	59.4	360
	127x127x38	AG12724XB385B00(0M)	◎	24	0.73	17.52	5500	5.63	198.81	1.27	32.33	62.0	360
	127x127x38	AG12748LB385B00(0CU)	◎	48	0.09	4.32	3000	3.02	106.57	0.49	12.52	46.0	360
	127x127x38	AG12748MB385B00(0M)	◎	48	0.17	8.16	4000	4.06	143.42	0.77	19.66	53.9	360
	127x127x38	AG12748HB385B00(0M)	◎	48	0.23	11.04	4500	4.56	161.10	0.93	23.62	57.0	360
	127x127x38	AG12748UB385B00(0M)	◎	48	0.29	13.92	5000	5.02	177.38	1.09	27.64	59.4	360
	127x127x38	AG12748XB385B00(0M)	◎	48	0.38	18.24	5500	5.63	198.81	1.27	32.33	62.0	360
<b>AD13525-9</b>	135x135x25	ADN512DB-A91	◎	12	0.12	1.44	1500	1.85	65.34	0.08	2.03	28.5	220
	135x135x25	ADN512LB-A91	◎	12	0.18	2.16	1800	2.21	77.95	0.11	2.72	33.6	220



40x40x56



120x120x38



60x60x25



140x140x51

\*:Noise is measured at the distance of 1 meter from the axis of intake.  
Specifications are subject to change without prior notice.

Bearing type: ○=Ball ※=Sleeve ◐=1B1S ●=Hypro Bearing

	Frame size (mm)	Model No.	Bearing Type	Rated Voltage (VDC)	Current (A)	Power (W)	Rated Speed (RPM)	Maximum AirFlow (CMM)	Maximum AirFlow (CFM)	Maximum Pressure (InAq)	Maximum Pressure (mmAq)	*Noise Level (dB/A)	Weight (g)
<b>AD13525-9</b>	135x135x25	ADN512MB-A91	○	12	0.20	2.40	2050	2.55	90.15	0.14	3.51	37.8	220
	135x135x25	ADN512HB-A91	○	12	0.28	3.36	2200	2.70	95.37	0.19	4.83	39.0	220
	135x135x25	ADN512UB-A91	○	12	0.31	3.72	2500	3.08	108.63	0.23	5.92	42.5	220
	135x135x25	ADN512XB-A91	○	12	0.47	5.64	3100	3.82	134.85	0.32	8.00	49.7	220
<b>AD13525(T)-9</b>	135x135x25	AD13512DB259000	○	12	0.07	0.84	1500	1.66	58.50	0.09	2.34	28.0	220
	135x135x25	AD13512LB259000	○	12	0.12	1.44	1800	2.01	70.83	0.13	3.20	33.9	220
	135x135x25	AD13512MB259000	○	12	0.16	1.92	2050	2.35	83.04	0.17	4.22	37.9	220
	135x135x25	AD13512HB259000	○	12	0.18	2.16	2200	2.46	86.85	0.18	4.55	39.6	220
	135x135x25	AD13512UB259000	○	12	0.29	3.48	2500	2.82	99.74	0.22	5.66	42.8	220
<b>AS14038-7</b>	140x140x38	AS014012LB387BB0(0L6)	○	12	0.80	9.60	3600	4.19	148.00	0.68	17.15	56.7	551
	140x140x38	AS014012MB387BB0(0L6)	○	12	1.26	15.12	4200	4.93	174.00	0.87	22.00	57.8	551
	140x140x38	AS014012HB387BB0(0L6)	○	12	1.75	21.00	4800	5.66	200.00	1.10	27.99	61.4	551
	140x140x38	AS014012UB387BB0(0L6)	○	12	2.20	26.40	5400	6.37	225.00	1.40	35.48	66.3	551
	140x140x38	AS014012XB387BB0(0L6)	○	12	3.20	38.40	6000	7.08	250.00	1.69	42.98	68.2	551
	140x140x38	AS014012XB387BB0	○	12	4.00	48.00	6600	7.69	271.50	2.02	51.18	70.2	551
	140x140x38	AS014024LB387BB0	○	24	0.60	14.40	4200	4.93	174.00	0.87	22.00	57.8	551
	140x140x38	AS014024MB387BB0	○	24	0.80	19.20	4800	5.66	200.00	1.10	27.99	61.4	551
	140x140x38	AS014024HB387BB0	○	24	1.10	26.40	5400	6.37	225.00	1.40	35.48	66.3	551
	140x140x38	AS014024UB387BB0	○	24	1.50	36.00	6000	7.08	250.00	1.69	42.98	68.2	551
<b>AS14051-9</b>	140x140x51	AS14012LB519B00	○	12	1.80	21.60	2800	6.73	237.50	0.52	13.08	56.0	710
	140x140x51	AS14012MB519B00	○	12	2.80	33.60	3200	7.84	276.80	0.67	16.99	60.0	710
	140x140x51	AS14012HB519B00	○	12	3.20	38.40	3600	8.97	316.90	0.83	21.18	64.0	710
	140x140x51	AS14024LB519B00	○	24	0.80	19.20	2800	6.73	237.50	0.52	13.08	56.0	710
	140x140x51	AS14024MB519B00	○	24	1.10	26.40	3200	7.84	276.80	0.67	16.99	60.0	710
	140x140x51	AS14024HB519B00	○	24	1.50	36.00	3600	8.97	316.90	0.83	21.18	64.0	710
	140x140x51	AS14048LB519B00	○	48	0.36	17.28	2800	6.73	237.50	0.52	13.08	56.0	710
	140x140x51	AS14048MB519B00	○	48	0.51	24.48	3200	7.84	276.80	0.67	16.99	60.0	710
	140x140x51	AS14048HB519B00	○	48	0.73	35.04	3600	8.97	316.90	0.83	21.18	64.0	710
	140x140x51	AS14048UB519B00	○	48	1.10	52.80	4300	10.36	366.00	1.16	29.49	66.5	710
<b>AD17251-5</b>	172x150x51	AD17212DB5151M0(OCW)	○	12	1.65	19.80	3500	7.50	265.00	0.75	19.05	58.8	762
	172x150x51	AD17212LB5151M0(OCW)	○	12	2.30	27.60	3900	8.35	295.00	0.89	22.61	60.6	762
	172x150x51	AD17224DB5151M0(OCW)	○	24	0.83	19.92	3500	7.50	265.00	0.75	19.05	58.8	762
	172x150x51	AD17224LB5151M0(OCW)	○	24	1.10	26.40	3900	8.35	295.00	0.89	22.61	60.6	762
	172x150x51	AD17224MB5151M0(OCW)	○	24	1.45	34.80	4300	9.26	327.00	1.07	27.18	64.0	762

# DC Fan

- AD 15mm ~ 172mm / Thickness : min 06mm ~ max 51mm
- AS 40mm ~ 140mm / Thickness : min 28mm ~ max 76mm
- AG 20mm ~ 127mm / Thickness : min 10mm ~ max 38mm



80x80x76



40x40x28

\*:Noise is measured at the distance of 1 meter from the axis of intake.  
Specifications are subject to change without prior notice.

Bearing type: ◎=Ball ※=Sleeve ○=1B1S ●=Hypro Bearing

Frame size (mm)	Model No.	Bearing Type	Rated Voltage (VDC)	Current (A)	Power (W)	Rated Speed (RPM)	Maximum AirFlow (CMM) (CFM)		Maximum Pressure (InAq) (mmAq)		*Noise Level (dB/A)	Weight (g)
172x150x51	AD17224HB5151M0(OCW)	◎	24	1.95	46.80	4800	10.25	362.00	1.33	33.78	65.7	762
172x150x51	AD17224UB5151M0(OCW)	◎	24	2.56	61.44	5300	11.81	417.00	1.69	42.93	67.9	762
172x150x51	AD17248DB5151M0(OCW)	◎	48	0.43	20.64	3500	7.50	265.00	0.75	19.05	58.8	762
<b>AD17251-5</b> 172x150x51	AD17248LB5151M0(OCW)	◎	48	0.57	27.36	3900	8.35	295.00	0.89	22.61	60.6	762
172x150x51	AD17248MB5151M0(OCW)	◎	48	0.77	36.96	4300	9.26	327.00	1.07	27.18	64.0	762
172x150x51	AD17248HB5151M0(OCW)	◎	48	1.05	50.40	4800	10.25	362.00	1.33	33.78	65.7	762
172x150x51	AD17248UB5151M0(OCW)	◎	48	1.25	60.00	5300	11.81	417.00	1.69	42.93	67.9	762

# DC Fan **Signal Control Models**

**FG 3A**

Output of locked signal  
 \*Output type.....Open collector type  
 \*Electrical specification:

\*Transistor Q1 at "ON" position  
 Collector current..... $I_c=10\text{mA Max}$   
 Saturation Voltage..... $V_{ce}=1.0\text{V Max}$   
 (Between Collector and Emitter at  $I_c=10\text{mA}$ )  
 \*Transistor Q1 at "OFF" position  
 Release Voltage..... $V_{ce}=30\text{V Max}$

\*Output waveform

**FG 3B**

Output of locked signal  
 \*Output type.....Open collector type  
 \*Electrical specification:

\*Transistor Q1 at "ON" position  
 Collector current..... $I_c=10\text{mA Max}$   
 Saturation Voltage..... $V_{ce}=1.0\text{V Max}$   
 (Between Collector and Emitter at  $I_c=10\text{mA}$ )  
 \*Transistor Q1 at "OFF" position  
 Release Voltage..... $V_{ce}=30\text{V Max}$

\*Output waveform

**FG 3C**

Output of locked signal  
 \*Output type.....Open Drain type  
 \*Electrical specification:

\*Mosfet Q1 at "ON" position  
 Drain current..... $I_d=10\text{mA Max}$   
 Saturation Voltage..... $V_{ds}=0.5\text{V Max}$

\*Mosfet Q1 at "OFF" position  
 Release Voltage..... $V_{ds}=6\text{V Max}$   
 \*Fan supply Voltage..... $V_{cc}=6\text{V Max}$

\*Output waveform

**FG 3D**

Output of locked signal  
 \*Output type.....Open collector type  
 \*Electrical specification:

\*Transistor Q1 at "ON" position  
 Collector current..... $I_c=10\text{mA Max}$   
 Saturation Voltage..... $V_{ce}=1.0\text{V Max}$   
 (Between Collector and Emitter at  $I_c=10\text{mA}$ )  
 \*Transistor Q1 at "OFF" position  
 Release Voltage..... $V_{ce}=30\text{V Max}$

\*Output waveform

**FG 3E**

Output of locked signal  
 \*Output type.....Open collector type  
 \*Electrical design suggestion:

\*Transistor Q1 at "ON" position  
 Collector current..... $I_c=10\text{mA Max}$   
 Saturation Voltage..... $V_{ce}=1.0\text{V Max}$   
 (Between Collector and Emitter at  $I_c=10\text{mA}$ )  
 \*Transistor Q1 at "OFF" position  
 Release Voltage..... $V_{ce}=30\text{V Max}$

\*Output waveform

**FG 6A**

Output of locked signal  
 \*Output type.....Open collector type  
 \*Electrical design suggestion:

\*Transistor Q1 at "ON" position  
 Collector current..... $I_c=10\text{mA Max}$   
 Saturation Voltage..... $V_{ce}=1.0\text{V Max}$   
 (Between Collector and Emitter at  $I_c=10\text{mA}$ )  
 \*Transistor Q1 at "OFF" position  
 Release Voltage..... $V_{ce}=30\text{V Max}$

\*Output waveform

**FG 6B**

Output of locked signal  
 \*Output type.....Open collector type  
 \*Electrical specification:

\*Mosfet Q1 at "ON" position  
 Drain current..... $I_d=10\text{mA Max}$   
 Saturation Voltage..... $V_{ds}=0.5\text{V Max}$   
 \*Mosfet Q1 at "OFF" position  
 Release Voltage..... $V_{ds}=30\text{V Max}$

\*Output waveform

**RD 2A**

Output of locked signal  
 \*Output type.....Open collector type  
 \*Electrical specification:

\*Transistor Q1 at "ON" position  
 Collector current..... $I_c=10\text{mA Max}$   
 Saturation Voltage..... $V_{ce}=1.0\text{V Max}$   
 (Between Collector and Emitter at  $I_c=10\text{mA}$ )  
 \*Transistor Q1 at "OFF" position  
 Release Voltage..... $V_{ce}=30\text{V Max}$

\*Output waveform

**RD 2B**

Output of locked signal  
 \*Output type.....Open collector type  
 \*Electrical specification:

\*Transistor Q1 at "ON" position  
 Collector current..... $I_c=10\text{mA Max}$   
 Saturation Voltage..... $V_{ce}=1.0\text{V Max}$   
 (Between Collector and Emitter at  $I_c=10\text{mA}$ )  
 \*Transistor Q1 at "OFF" position  
 Release Voltage..... $V_{ce}=30\text{V Max}$

\*Output waveform

# DC Fan Signal Control Models

### RD 2C

Output of locked signal  
 \*Output type.....Open collector type  
 \*Electrical specification:

\*Transistor Q1 at "ON" position  
 Collector current..... $I_c=10\text{mA Max}$   
 Saturation Voltage..... $V_{ce}=1.0\text{V Max}$   
 (Between Collector and Emitter at  $I_c=10\text{mA}$ )  
 \*Transistor Q1 at "OFF" position  
 Release Voltage..... $V_{oh}=30\text{V Max}$

\*Output waveform

### RD 2D

Output of locked signal  
 \*Output type.....Open collector type  
 \*Electrical specification:

\*Transistor Q1 at "ON" position  
 Collector current..... $I_c=10\text{mA Max}$   
 Saturation Voltage..... $V_{ce}=1.0\text{V Max}$   
 (Between Collector and Emitter at  $I_c=10\text{mA}$ )  
 \*Transistor Q1 at "OFF" position  
 Release Voltage..... $V_{oh}=30\text{V Max}$

\*Output waveform

### Version 4(VS)

Variable Speed by Thermistor  
 For example, AD0812HX-A74  
 Diagram:

\*Variable degree

### Version 7(TS)

Two speed control  
 \*For example, AD0812HX-C77  
 \*Diagram:

\*Constant level

### PWM 9A

PROVISION OF DIGITAL PWM SPEED CONTROL

\*DIGITAL PWM SPEED CONTROL POSITION

PWM INPUT VOLTAGE HIGH..... $V_{in}=5.5\text{V MAX}$   
 PWM INPUT VOLTAGE LOW..... $V_{in}=0.5\text{V MAX}$   
 \*PWM INPUT FREQUENCY..... $f_{PWM}=18\text{KHZ}\sim 30\text{KHZ}$

### PWM BA

PROVISION OF DIGITAL PWM SPEED CONTROL & LOCKED SIGNAL(F.G)

\*DIGITAL PWM SPEED CONTROL POSITION

PWM INPUT VOLTAGE HIGH..... $V_{in}=5.5\text{V MAX}$   
 PWM INPUT VOLTAGE LOW..... $V_{in}=0.5\text{V MAX}$   
 \*PWM INPUT FREQUENCY..... $f_{PWM}=18\text{KHZ}\sim 30\text{KHZ}$

### PWM BB

PROVISION OF DIGITAL PWM SPEED CONTROL & LOCKED SIGNAL(F.G)

\*TRANSISTOR Q1 AT "ON" POSITION  
 COLLECTOR CURRENT..... $I_c=10\text{mA MAX}$   
 SATURATION VOLTAGE..... $V_{ce}=1\text{V MAX}$   
 \*TRANSISTOR Q1 AT "OFF" POSITION  
 RELEASE VOLTAGE..... $V_{oh}=15\text{V MAX}$   
 \*DIGITAL PWM SPEED CONTROL POSITION  
 PWM INPUT VOLTAGE HIGH..... $V_{in}=5.5\text{V MAX}$   
 PWM INPUT VOLTAGE LOW..... $V_{in}=0.5\text{V MAX}$   
 \*PWM INPUT FREQUENCY..... $f_{PWM}=18\text{KHZ}\sim 30\text{KHZ}$

## DC FAN GENERAL SPECIFICATION

<b>DIELECTRIC STRENGTH</b> ...1MA MAX AT 500VAC FOR 1 MIN BETWEEN LEAD WIRE AND FRAME	<b>STORAGE TEMPERATURE</b> ...-40 TO +70 DEGREE C(-40 TO+158 DEGREE F)
<b>INSULATION RESISTANCE</b> .....10M OHM BETWEEN LEAD WIRE AND FRAME(DC 500V)	<b>PROTECTION</b> ...MOTOR PROTECTION AND POLARITY PROTECTION
<b>LIFE EXPECTANCY(BALL BEARING)</b> ...70,000HRS MIN AT +40 DEGREE C/L10 RELATIVE HUMIDITY 65%+-20%	<b>LEAD WIRE</b> .....UL1571AWG28,30
<b>LIFE EXPECTANCY(HYPO BEARING)</b> ...>40,000HRS MIN AT +40 DEGREE C/L10 RELATIVE HUMIDITY 65%+-20%	.....UL1007AWG24,26
<b>LIFE EXPECTANCY (FDB)</b> ...>60,000HRS MIN AT +40 DEGREE C/L10 RELATIVE HUMIDITY 65%+-20%	.....UL1061AWG26
<b>OPERATION TEMPERATURE</b> .....-10 TO +70 DRGREE C(+14 TO+158 DEGREE F),STANDARD .....-10 TO +90 DEGREE C(+14 TO+194 DEGREE F),SPECIFIC	<b>PLASTIC MATERIAL</b> .....BLACK PBT(UL 94V-0) WITH GLASS FIBER

The technical characteristics given in this catalogue are standard plastic version, 12VDC unless specified.

# Blower

■ AB 30mm ~ 120mm / Thickness : min 07mm ~ max 33mm



51x51x15



97x97x33

\*:Noise is measured at the distance of 1 meter from the axis of intake.  
Specifications are subject to change without prior notice.

Bearing type: ◎=Ball ※=Sleeve ○=1B1S ●=Hypro Bearing

	Frame size (mm)	Model No.	Bearing Type	Rated Voltage (VDC)	Current (A)	Power (W)	Rated Speed (RPM)	Maximum AirFlow (CMM) (CFM)	Maximum Pressure (InAq) (mmAq)	*Noise Level (dB/A)	Weight (g)
AB3010	30x30x10	AB0305MB-GA0	◎ ●	5	0.08	0.42	7500	0.03 0.99	0.17 4.42	29.8	12
	30x30x10	AB0312MB-GA0	◎ ●	12	0.07	0.78	7500	0.03 0.99	0.17 4.42	29.8	12
	30x30x10	AB0312HB-GA0	◎ ●	12	0.09	1.04	9000	0.03 1.10	0.22 5.59	34.0	12
AB3507	35x35x07	AB3505LX-QB0	○●	5	0.10	0.52	5500	0.03 0.90	0.13 3.20	20.0	13
	35x35x07	AB3505MX-QB0	○●	5	0.14	0.70	6500	0.03 1.00	0.17 4.42	25.5	13
	35x35x07	AB3512MX-QB0	○●	12	0.10	1.14	6500	0.03 1.00	0.17 4.42	25.5	13
AB3510	35x35x10	AB3505LB-GA0	◎ ●	5	0.08	0.38	5000	0.03 1.00	0.11 2.79	23.8	16
	35x35x10	AB3505MB-GA0	◎ ●	5	0.09	0.45	6000	0.03 1.22	0.16 3.96	29.7	16
	35x35x10	AB3505HB-GA0	◎ ●	5	0.15	0.73	7000	0.04 1.45	0.22 5.49	30.5	16
	35x35x10	AB3512MB-GA0	◎ ●	12	0.06	0.74	6000	0.03 1.22	0.16 3.96	29.7	16
	35x35x10	AB3512HB-GA0	◎ ●	12	0.07	0.89	7000	0.04 1.45	0.22 5.49	35.0	16
AB4507	45x45x07	AB4505LB-QA0(S)	○●	5	0.07	0.35	4700	0.04 1.42	0.21 5.21	26.4	23
	45x45x07	AB4505MB-QA0(S)	○●	5	0.08	0.40	5500	0.05 1.60	0.26 6.68	31.0	23
	45x45x07	AB4505HB-QA0(S)	○●	5	0.12	0.60	6200	0.05 1.82	0.31 7.87	34.2	23
	45x45x07	AB4512LB-QA0(S)	○	12	0.04	0.48	4700	0.04 1.42	0.21 5.21	26.4	23
	45x45x07	AB4512MB-QA0(S)	○	12	0.06	0.72	5500	0.05 1.60	0.26 6.68	31.0	23
	45x45x07	AB4512HB-QA0(S)	○	12	0.07	0.84	6200	0.05 1.82	0.31 7.87	34.2	23
AB4510	45x45x10	AB4505LB-GD1(B)	◎※ ●	5	0.07	0.35	4000	0.05 1.79	0.16 4.06	26.7	26
	45x45x10	AB4505MB-GD1(B)	◎※ ●	5	0.09	0.45	5000	0.07 2.30	0.25 6.35	31.1	26
	45x45x10	AB4512LB-GD0(B)	◎※ ●	12	0.06	0.72	4000	0.05 1.79	0.16 4.06	26.7	26
	45x45x10	AB4512MB-GD0(B)	◎※ ●	12	0.07	0.84	5000	0.07 2.30	0.25 6.35	31.1	26
	45x45x10	AB4512HB-GD0(B)	◎※ ●	12	0.09	1.08	5800	0.08 2.70	0.34 8.64	37.0	26
AB5009	50x50x09	AB0505LB-RB1	◎※ ●	5	0.06	0.30	4000	0.06 2.09	0.17 4.32	26.5	28
	50x50x09	AB0505MB-RB1	◎※ ●	5	0.10	0.50	5000	0.07 2.37	0.31 7.87	34.0	28
AB5015	50x50x15	AB05012MX150100	●	12	0.13	1.56	5500	0.14 4.88	0.43 10.92	38.8	27
AB5020	50x50x20	AB5012LB-C01	◎※ ●	12	0.06	0.72	4000	0.09 3.29	0.21 5.33	26.4	28
	50x50x20	AB5012MB-C01	◎※ ●	12	0.09	1.08	5000	0.12 4.28	0.36 9.12	32.5	28
	50x50x20	AB5012HB-C01	◎※ ●	12	0.14	1.68	6000	0.15 5.20	0.51 12.90	37.0	28
AB5020	50x50x20	AB05012DB200300	◎	12	0.08	0.96	3700	0.13 4.63	0.34 8.64	25.6	30
	50x50x20	AB05012LB200300	◎	12	0.12	1.44	4200	0.15 5.23	0.45 11.43	30.1	30
	50x50x20	AB05012MB200300	◎	12	0.16	1.92	4700	0.16 5.79	0.54 13.72	33.5	30
	50x50x20	AB05012HB200300	◎	12	0.19	2.28	5200	0.18 6.43	0.73 18.54	36.4	30
	50x50x20	AB05012UB200300	◎	12	0.25	3.00	5700	0.20 7.20	0.89 22.61	39.5	30
AB5115	51x51x15	AB05105LB150300	◎	5	0.08	0.40	3500	0.07 2.38	0.20 5.08	31.6	26
	51x51x15	AB05105MB150300	◎	5	0.14	0.70	4500	0.09 3.33	0.35 8.89	37.1	26



# Blower

■ AB 30mm ~ 120mm / Thickness : min 07mm ~ max 33mm



51x51x15



97x97x33

Bearing type: ◎=Ball ※=Sleeve ○=1B1S ●=Hypro Bearing

	Frame size (mm)	Model No.	Bearing Type	Rated Voltage (VDC)	Current (A)	Power (W)	Rated Speed (RPM)	Maximum AirFlow (CMM) (CFM)	Maximum Pressure (InAq) (mmAq)	*Noise Level (dB/A)	Weight (g)
AB5115	51x51x15	AB05105HB150300	◎	5	0.20	1.00	5500	0.12 4.17	0.50 12.70	38.0	26
	51x51x15	AB05105UB150300	◎	5	0.40	2.00	6500	0.14 5.07	0.93 23.62	43.0	26
	51x51x15	AB05112LB150300	◎	12	0.05	0.60	3500	0.07 2.38	0.20 5.08	31.6	26
	51x51x15	AB05112MB150300	◎	12	0.08	0.96	4500	0.09 3.33	0.35 8.89	37.1	26
	51x51x15	AB05112HB150300	◎	12	0.12	1.44	5500	0.12 4.17	0.50 12.70	38.0	26
	51x51x15	AB05112UB150300	◎	12	0.18	2.16	6500	0.14 5.07	0.93 23.62	43.0	26
	51x51x15	AB05124HB150300	◎	24	0.10	2.40	5500	0.12 4.17	0.50 12.70	38.0	26
	51x51x15	AB05124UB150300	◎	24	0.12	2.88	6500	0.14 5.07	0.93 23.62	43.0	26
AB6015	60x60x15	AB0612UB-D03	◎	12	0.26	3.12	5000	0.23 8.26	0.91 23.09	47.2	1.9
AB6025	60x60x25	AB06012DB250300	◎	12	0.05	0.60	2300	0.12 4.30	0.16 4.06	21.5	45.6
	60x60x25	AB06012LB250300	◎	12	0.09	1.03	2800	0.15 5.30	0.29 7.37	28.5	45.6
	60x60x25	AB06012MB250300	◎	12	0.13	1.50	3300	0.18 6.30	0.38 9.65	34.5	45.6
AB7012	70x70x12	AB7012LB-E01	◎	12	0.06	0.72	2900	0.14 4.77	0.16 4.06	24.0	35
	70x70x12	AB7012HB-E01	◎	12	0.15	1.80	3800	0.19 6.68	0.44 11.07	34.0	35
AB7025	70x70x25	AB07012LB250300	◎ ●	12	0.06	0.72	2000	0.15 5.40	0.18 4.45	22.0	62
	70x70x25	AB07012MB250300	◎ ●	12	0.09	1.08	2600	0.20 7.20	0.35 8.76	26.5	62
	70x70x25	AB07012HB250300	◎ ●	12	0.18	2.16	3200	0.25 8.90	0.59 14.86	33.5	62
	70x70x25	AB07012UB250300	◎ ●	12	0.28	3.36	3800	0.30 10.50	0.95 24.13	39.0	62
AB7530	75x75x30	AB7512DB-W01	◎ ●	12	0.10	1.16	2200	0.25 8.90	0.20 5.08	28.7	80
	75x75x30	AB7512LB-W01	◎ ●	12	0.18	2.16	2800	0.32 11.40	0.35 8.89	37.6	80
	75x75x30	AB7512MB-W01	◎ ●	12	0.25	3.00	3400	0.39 13.80	0.56 14.22	41.7	80
	75x75x30	AB7512HB-W01	◎ ●	12	0.32	3.84	3900	0.45 15.90	0.77 19.56	45.4	80
	75x75x30	AB7512UB-W01	◎ ●	12	0.48	5.76	4500	0.52 18.50	1.02 25.91	49.1	80
AD7530	75x75x30	AD7512LB	◎※ ●	12	0.08	0.96	2200	0.20 6.90	0.19 4.83	29.0	80
	75x75x30	AD7512MB	◎※ ●	12	0.11	1.32	2600	0.22 7.78	0.23 5.84	34.9	80
	75x75x30	AD7512HB	◎※ ●	12	0.22	2.64	3000	0.29 10.29	0.35 8.89	38.5	80
	75x75x30	AD7512UB	◎※ ●	12	0.50	6.00	4200	0.37 13.08	0.82 20.83	44.7	80
	75x75x30	AD7524LB	◎※ ●	24	0.07	1.68	2200	0.20 6.89	0.19 4.83	29.0	80
	75x75x30	AD7524MB	◎※ ●	24	0.10	2.40	2600	0.22 7.78	0.23 5.84	34.9	80
	75x75x30	AD7524HB	◎※ ●	24	0.14	3.36	3000	0.29 10.29	0.35 8.89	38.5	80
	75x75x30	AD7524UB	◎※ ●	24	0.25	6.00	4200	0.37 13.08	0.82 20.83	44.7	80
AB9433	94x94x33	AB0912DB-Z01(N)	◎	12	0.32	3.84	2800	0.64 22.58	0.47 11.96	44.0	157
	94x94x33	AB0912LB-Z01(N)	◎	12	0.48	5.76	3200	0.76 26.70	0.74 18.80	48.4	157
	94x94x33	AB0912MB-Z01(N)	◎	12	0.67	8.04	3600	0.83 29.23	0.87 22.12	52.2	157
	94x94x33	AB0912HB-Z01(N)	◎	12	0.78	9.36	4000	0.93 32.83	1.12 28.32	56.3	157



\*:Noise is measured at the distance of 1 meter from the axis of intake.  
Specifications are subject to change without prior notice.

Bearing type: ○=Ball ※=Sleeve ◐=1B1S ●=Hypro Bearing

	Frame size (mm)	Model No.	Bearing Type	Rated Voltage (VDC)	Current (A)	Power (W)	Rated Speed (RPM)	Maximum AirFlow (CMM)	Maximum AirFlow (CFM)	Maximum Pressure (InAq)	Maximum Pressure (mmAq)	*Noise Level (dB/A)	Weight (g)
<b>AB9433</b>	94x94x33	AB0912UB-Z01(N)	○	12	1.80	21.60	4500	1.04	36.62	1.73	43.92	56.3	157
	94x94x33	AB0924LB-Z01(N)	○	24	0.23	5.52	3200	0.76	26.70	0.74	18.80	48.4	157
	94x94x33	AB0924MB-Z01(N)	○	24	0.27	6.48	3600	0.83	29.23	0.87	22.12	52.2	157
	94x94x33	AB0924HB-Z01(N)	○	24	0.35	8.40	4000	0.93	32.83	1.12	28.32	56.3	157
	94x94x34	AB0948HB-Z01(N)	○	48	0.32	15.36	4500	1.07	37.75	1.52	38.53	56.2	157
<b>AB12032</b>	120x120x32	AB1212DB-Y01	○※●	12	0.26	3.12	1800	0.60	21.09	0.42	10.62	46.6	251
	120x120x32	AB1212LB-Y01	○※●	12	0.41	4.92	2100	0.71	25.20	0.62	15.85	48.0	251
	120x120x32	AB1212MB-Y01	○※●	12	0.53	6.36	2300	0.80	28.20	0.89	22.58	49.0	251
	120x120x32	AB1212HB-Y01	○※●	12	0.79	9.48	2600	0.88	31.21	1.22	31.01	55.0	251
	120x120x32	AB1212UB-Y01	○※●	12	0.94	11.28	2800	0.95	33.62	1.45	36.78	53.3	251
	120x120x32	AB1212XB-Y01	○	12	1.12	13.44	3100	1.03	36.32	1.60	40.69	57.0	251
	120x120x32	AB1224DB-Y01	○※●	24	0.19	4.56	1800	0.60	21.09	0.42	10.62	46.6	251
	120x120x32	AB1224LB-Y01	○※●	24	0.25	6.00	2100	0.71	25.20	0.62	15.85	48.0	251
	120x120x32	AB1224MB-Y01	○※●	24	0.36	8.64	2300	0.80	28.20	0.89	22.58	49.0	251
	120x120x32	AB1224HB-Y01	○※●	24	0.43	10.32	2600	0.88	31.21	1.22	31.01	55.0	251
	120x120x32	AB1224UB-Y01	○※●	24	0.50	12.00	2800	0.95	33.62	1.45	36.78	53.3	251
	120x120x32	AB1224XB-Y01	○	24	0.68	16.32	3100	1.03	36.32	1.60	40.69	57.0	251
	120x120x32	AB1248DB-Y01	○※●	48	0.09	4.32	1800	0.60	21.09	0.42	10.62	46.6	251
	120x120x32	AB1248LB-Y01	○※●	48	0.16	7.68	2100	0.71	25.20	0.62	15.85	48.0	251
	120x120x32	AB1248MB-Y01	○※●	48	0.18	8.64	2300	0.80	28.20	0.89	22.58	49.0	251
	120x120x32	AB1248HB-Y01	○※●	48	0.22	10.56	2600	0.88	31.21	1.22	31.01	55.0	251
	120x120x32	AB1248UB-Y01	○※●	48	0.29	13.92	2800	0.95	33.62	1.45	36.78	53.3	251

# DC Chip cooler

■ AP 35mm ~ 52mm  
Thickness : min 08mm ~ max 12mm



45x45x10



40x40x08

\*:Noise is measured at the distance of 1 meter from the axis of intake.  
Specifications are subject to change without prior notice.

Bearing type: ◎=Ball ※=Sleeve ○=1B1S ●=Hypro Bearing

	Frame size (mm)	Model No.	Bearing Type	Rated Voltage (VDC)	Current (A)	Power (W)	Rated Speed (RPM)	Maximum AirFlow (CMM) (CFM)	Maximum Pressure (InAq) (mmAq)	*Noise Level (dB/A)	Weight (g)
AP3508-7	35x35x08	AP3505LB-J70	○●	5	0.07	0.35	7500	0.07 2.50	0.08 2.08	20.0	6
	35x35x08	AP3505MB-J70	○●	5	0.11	0.55	9000	0.09 3.30	0.14 3.51	27.9	6
	35x35x08	AP3505HB-J70	○●	5	0.13	0.65	10500	0.12 4.10	0.15 3.84	32.0	6
	35x35x08	AP3512MB-J70	○●	12	0.06	0.72	9000	0.09 3.30	0.14 3.51	27.9	6
	35x35x08	AP3512HB-J70	○●	12	0.09	1.08	10500	0.12 4.10	0.15 3.84	32.0	6
AP4008-7	40x40x08	AP0405MX-J70	○●	5	0.10	0.50	7000	0.13 4.70	0.11 2.82	28.0	15
	40x40x08	AP0412MX-J70	○●	12	0.06	0.72	7000	0.13 4.70	0.11 2.82	28.0	15
AP4010-7	40x40x10	AP0405MX-G70	●	5	0.13	0.65	8000	0.13 4.70	0.11 2.82	28.0	19.2
	40x40x10	AP0412LX-G70	○●	12	0.05	0.60	6500	0.10 3.50	0.06 1.60	19.0	19.2
	40x40x10	AP0412MX-G70	○●	12	0.07	0.84	8000	0.13 4.70	0.11 2.82	28.0	19.2
AP4508-9	45x45x08	AP4505LB-J90(S)	○●	5	0.04	0.20	4500	0.12 4.20	0.04 1.12	19.5	18
	45x45x08	AP4505MB-J90(S)	○●	5	0.07	0.35	5500	0.15 5.20	0.06 1.63	23.8	18
	45x45x08	AP4505HB-J90(S)	○●	5	0.09	0.45	6200	0.17 6.00	0.09 2.29	30.0	18
	45x45x08	AP4512LB-J90(S)	○●	12	0.04	0.48	4500	0.12 4.20	0.04 1.12	19.5	18
	45x45x08	AP4512MB-J90(S)	○●	12	0.05	0.60	5500	0.15 5.20	0.06 1.63	23.8	18
	45x45x08	AP4512HB-J90(S)	○●	12	0.05	0.60	6200	0.17 6.00	0.09 2.29	30.0	18
AP4510-9	45x45x10	AP4505LB-G90(S)	●	5	0.05	0.25	4800	0.13 4.50	0.05 1.30	19.9	18
	45x45x10	AP4505MB-G90(S)	●	5	0.08	0.40	5800	0.16 5.50	0.07 1.70	25.0	18
	45x45x10	AP4505HB-G90(S)	●	5	0.09	0.45	6500	0.17 6.00	0.09 2.29	30.0	18
	45x45x10	AP4512LB-G90(S)	●	12	0.04	0.48	4800	0.13 4.50	0.05 1.30	19.9	18
	45x45x10	AP4512MB-G90(S)	●	12	0.05	0.60	5800	0.16 5.50	0.07 1.70	25.0	18
	45x45x10	AP4512HB-G90(S)	●	12	0.05	0.60	6500	0.17 6.00	0.09 2.29	30.0	18
AP5008-9	50x50x08	AP0505LX-J90	○●	5	0.05	0.25	4300	0.18 6.20	0.06 1.42	23.0	24
	50x50x08	AP0505MX-J90	○●	5	0.08	0.40	5000	0.20 7.10	0.07 1.88	25.5	24
	50x50x08	AP0505HX-J90	○●	5	0.08	0.40	6300	0.26 9.20	0.10 2.62	32.6	24
	50x50x08	AP0512LX-J90	○●	12	0.05	0.60	4300	0.18 6.20	0.06 1.42	23.0	24
	50x50x08	AP0512MX-J90	○●	12	0.05	0.60	5000	0.20 7.10	0.07 1.88	25.5	24
	50x50x08	AP0512HX-J90	○●	12	0.08	0.96	6300	0.26 9.20	0.10 2.62	32.6	24
AP5212-7	52x52x12	AP5212MX-E70(8)	◎ ○●	12	0.06	0.72	4300	0.26 9.30	0.07 1.78	20.8	25
	52x52x12	AP5212HX-E70(8)	◎ ○●	12	0.08	0.96	5200	0.33 11.80	0.13 3.30	27.0	25

# Water Dust & proof

■ AQ 60mm ~ 120mm

Thickness : min 25mm ~ max 38mm



60x60x25



70x70x25

\*:Noise is measured at the distance of 1 meter from the axis of intake.  
Specifications are subject to change without prior notice.

Bearing type: ◎=Ball ※=Sleeve ○=1B1S ●=Hypro Bearing

	Frame size (mm)	Model No.	Bearing Type	Rated Voltage (VDC)	Current (A)	Power (W)	Rated Speed (RPM)	Maximum AirFlow (CMM)	Maximum AirFlow (CFM)	Maximum Pressure (InAq)	Maximum Pressure (mmAq)	*Noise Level (dB/A)	Weight (g)
AQ6025GL(T)-7	60x60x25	AQ0612LB-A70GL(T)	◎	12	0.07	0.84	2500	0.37	13.20	0.06	1.60	18.1	68
	60x60x25	AQ0612MB-A71GL(T)	◎	12	0.10	1.20	3500	0.51	18.18	0.12	3.10	28.6	68
	60x60x25	AQ0612HB-A71GL(T)	◎	12	0.16	1.92	4500	0.69	24.48	0.20	5.08	35.2	68
	60x60x25	AQ0612UB-A71GL(T)	◎	12	0.19	2.28	5000	0.76	27.00	0.23	5.84	40.0	68
	60x60x25	AQ0624HB-A70GL(T)	◎	24	0.12	2.88	4500	0.69	24.48	0.20	5.08	35.2	68
	60x60x25	AQ0624UB-A71GL(T)	◎	24	0.14	3.36	5000	0.76	27.00	0.23	5.84	40.0	68
AQ7025GL(T)-7	70x70x25	AQ0712LB-A70GL(T)	◎	12	0.10	1.20	3300	0.80	28.20	0.15	3.81	31.6	61
	70x70x25	AQ0712MB-A70GL(T)	◎	12	0.12	1.44	3800	0.91	32.30	0.18	4.47	33.6	61
	70x70x25	AQ0712HB-A70GL(T)	◎	12	0.18	2.16	4200	1.01	35.50	0.22	5.51	38.0	61
AQ8025GL(T)-7	80x80x25	AQ0812LB-A70GL(T)	◎	12	0.08	0.96	2100	0.77	27.02	0.07	1.78	22.3	86
	80x80x25	AQ0812MB-A70GL(T)	◎	12	0.12	1.44	2500	0.92	32.38	0.10	2.54	29.4	86
	80x80x25	AQ0824LB-A70GL(T)	◎	24	0.04	0.96	2100	0.77	27.02	0.07	1.78	22.3	86
	80x80x25	AQ0824MB-A70GL(T)	◎	24	0.07	1.68	2500	0.92	32.38	0.10	2.54	29.4	86
AQ9225GL(T)-7	92x92x25	AQ0912LB-A70GL(T)	◎	12	0.10	1.20	2100	1.15	40.69	0.08	2.06	29.2	92
	92x92x25	AQ0912MB-A70GL(T)	◎	12	0.15	1.80	2400	1.26	44.66	0.10	2.57	31.2	92
AQ12025GL-5	120x120x25	AQ1212DB-A71GL(N)	◎	12	0.11	1.32	1500	1.62	57.21	0.07	1.88	27.2	156
	120x120x25	AQ1212LB-A71GL(N)	◎	12	0.15	1.80	1800	2.03	71.81	0.09	2.36	34.3	156
	120x120x25	AQ1212MB-A71GL(N)	◎	12	0.16	1.92	2050	2.30	81.05	0.11	2.87	38.0	156
	120x120x25	AQ1212HB-A71GL(N)	◎	12	0.29	3.48	2200	2.49	87.87	0.13	3.40	39.1	156
	120x120x25	AQ1224DB-A71GL(N)	◎	24	0.06	1.44	1500	1.62	57.21	0.07	1.88	27.2	156
	120x120x25	AQ1224LB-A71GL(N)	◎	24	0.08	1.92	1800	2.03	71.81	0.09	2.36	34.3	156
	120x120x25	AQ1224MB-A71GL(N)	◎	24	0.11	2.64	2050	2.30	81.05	0.11	2.87	38.0	156
	120x120x25	AQ1224HB-A71GL(N)	◎	24	0.13	3.12	2200	2.49	87.87	0.13	3.40	39.1	156
AQ12038-5	120x120x38	AQ1212DB-F51(FN)	◎	12	0.11	1.32	1500	1.62	57.29	0.09	2.16	28.4	290
	120x120x38	AQ1212LB-F51(FN)	◎	12	0.19	2.28	1950	2.03	71.64	0.13	3.25	36.2	290
	120x120x38	AQ1212MB-F51(FN)	◎	12	0.33	3.96	2540	2.73	96.30	0.23	5.79	45.0	290
	120x120x38	AQ1212HB-F51(FN)	◎	12	0.45	5.40	2800	2.99	105.46	0.27	6.73	46.7	290
	120x120x38	AQ1224DB-F51(FN)	◎	24	0.08	1.92	1500	1.62	57.29	0.09	2.16	28.4	290
	120x120x38	AQ1224LB-F51(FN)	◎	24	0.12	2.88	1950	2.03	71.64	0.13	3.25	36.2	290
	120x120x38	AQ1224MB-F51(FN)	◎	24	0.19	4.56	2540	2.73	96.30	0.23	5.79	45.0	290
	120x120x38	AQ1224HB-F51(FN)	◎	24	0.24	5.76	2800	2.99	105.46	0.27	6.73	46.7	290
	120x120x38	AQ1248LB-F51(FN)	◎	48	0.06	2.88	1950	2.03	71.64	0.13	3.25	36.2	290
	120x120x38	AQ1248MB-F51(FN)	◎	48	0.10	4.80	2540	2.73	96.30	0.23	5.79	45.0	290
	120x120x38	AQ1248HB-F51(FN)	◎	48	0.18	8.64	2800	2.99	105.46	0.27	6.73	46.7	290

# AC fan

AA|128|1|M|B -|A|W

① ② ③ ④ ⑤ ⑥ ⑦

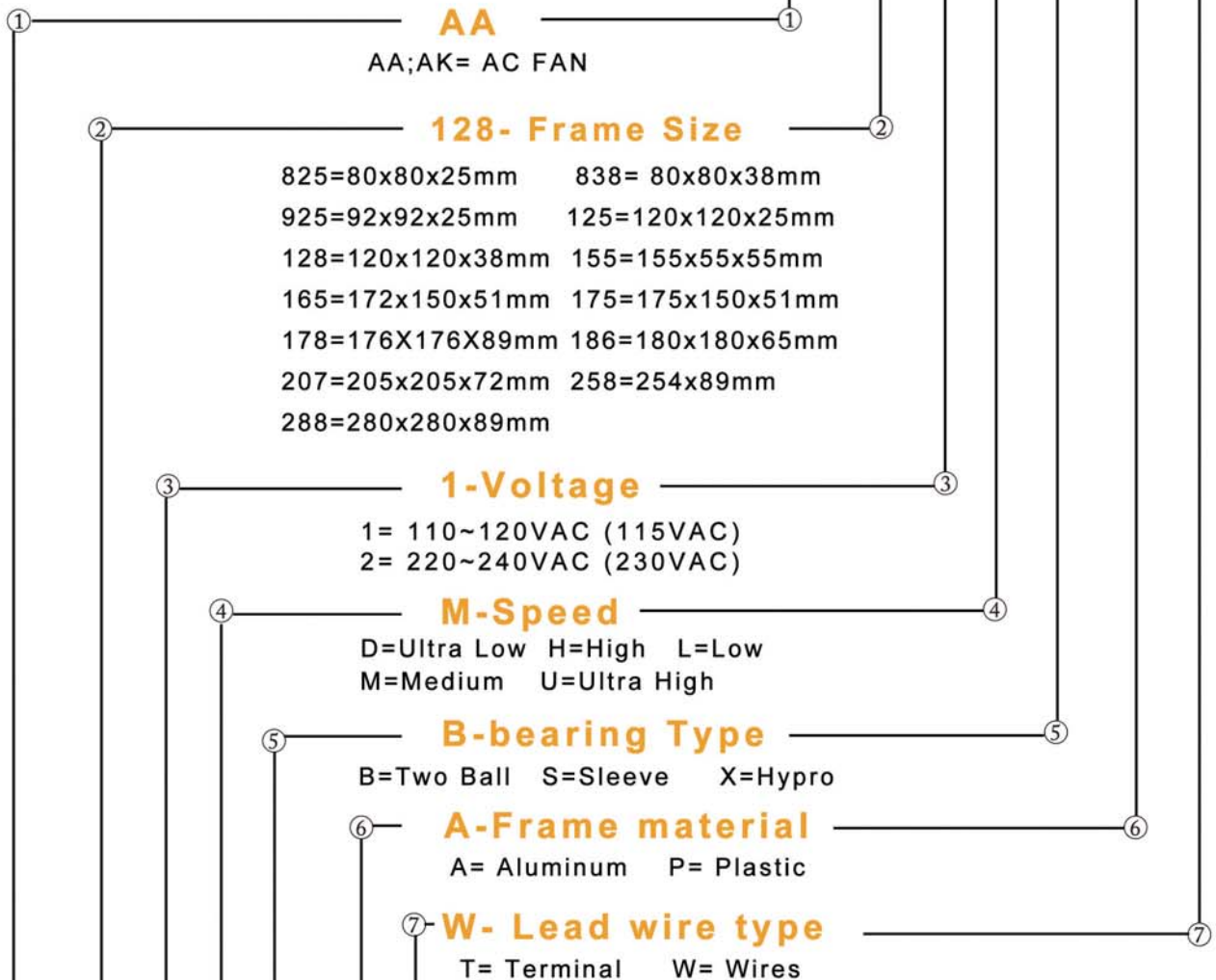

AK|258|1|M|B |(A|W)

① ② ③ ④ ⑤ ⑥ ⑦

## AC FAN GENERAL SPECIFICATION

2013

- ELECTRIC STRENGTH : 1500VAC for 1 minute to base on UL507
- INSULATION RESISTANCE : 100M ohm between lead wire and frame (DC 500V)
- LIFE EXPECTANCY (BALL BEARING) : 50,000hrs min at 40 °C/ L10 relative humidity 20%~85%
- LIFE EXPECTANCY (HYPRO BEARING) : 30,000hrs min at 40 °C/ L10 relative humidity 20%~85%
- OPERATION TEMPERATURE : -10 to + 70 °C (+14 to 176 °F)
- STORAGE TEMPERATURE : -40 to + 70 °C (-40 to +167)°F
- PLASTIC MATERIAL : Black PBT (UL 94v-0) with glass fiber
- ALUMINUM MATERIAL : High quality aluminum die-casting frame flatted with black paint

# AC Fan

- AK 172mm ~ 280mm / Thickness : min 51mm ~ max 89mm
- AA 80mm ~ 172mm / Thickness : min 25mm ~ max 51mm



\*:Noise is measured at the distance of 1 meter from the axis of intake.  
Specifications are subject to change without prior notice.

Bearing type: ○=Ball ※=Sleeve ◯=1B1S ●=Hypro Bearing

	Frame size (mm)	Model No.	Bearing Type	Volt Freq. (VAC/Hz)	Current (A)	Power (W)	Rated Speed (RPM)	Maximum AirFlow (CMM) (CFM)	Maximum Pressure (InAq) (mmAq)	*Noise Level (dB/A)	Weight (g)
AA8025	80x80x25	AA8251MB-AT	○※	115/50	0.13	13.90	1900	0.42 15.00	0.08 1.90	18.3	210
	80x80x25	AA8251MB-AT	○※	115/60	0.12	11.80	2500	0.54 19.00	0.12 3.00	24.0	210
	80x80x25	AA8251HB-AT	○※	115/50	0.08	7.40	2300	0.48 17.00	0.10 2.52	21.2	210
	80x80x25	AA8251HB-AT	○※	115/60	0.07	5.80	2800	0.59 21.00	0.13 3.18	27.8	210
	80x80x25	AA8252MB-AT	○※	230/50	0.08	16.10	1900	0.42 15.00	0.08 1.90	18.3	210
	80x80x25	AA8252MB-AT	○※	230/60	0.07	14.20	2500	0.54 19.00	0.12 3.00	24.0	210
	80x80x25	AA8252HB-AT	○※	230/50	0.07	15.18	2300	0.48 17.00	0.10 2.52	21.2	210
	80x80x25	AA8252HB-AT	○※	230/60	0.06	13.11	2800	0.59 21.00	0.13 3.18	27.8	210
AA8038	80x80x38	AA8381MB-AT	○※ ●	115/50	0.07	7.60	2300	0.62 22.00	0.11 2.72	25.3	320
	80x80x38	AA8381MB-AT	○※ ●	115/60	0.06	6.50	2400	0.68 24.00	0.11 2.79	26.2	320
	80x80x38	AA8381HB-AT	○※ ●	115/50	0.14	10.90	2400	0.68 24.00	0.11 2.79	26.2	320
	80x80x38	AA8381HB-AT	○※ ●	115/60	0.11	8.10	2800	0.84 29.60	0.17 4.22	31.6	320
	80x80x38	AA8382MB-AT	○※ ●	230/50	0.06	10.60	2300	0.62 22.00	0.11 2.72	25.3	320
	80x80x38	AA8382MB-AT	○※ ●	230/60	0.05	8.60	2400	0.68 24.00	0.11 2.79	26.2	320
	80x80x38	AA8382HB-AT	○※ ●	230/50	0.07	13.60	2400	0.68 24.00	0.11 2.79	26.2	320
	80x80x38	AA8382HB-AT	○※ ●	230/60	0.06	10.10	2800	0.84 29.60	0.17 4.22	31.6	320
AA9225	92x92x25	AA9251MB-AT	○※	115/50	0.12	14.90	1800	0.71 25.00	0.06 1.61	21.1	230
	92x92x25	AA9251MB-AT	○※	115/60	0.10	12.90	2200	0.86 30.50	0.08 1.96	26.8	230
	92x92x25	AA9251HB-AT	○※	115/50	0.08	7.40	2000	0.79 28.00	0.08 1.93	24.1	230
	92x92x25	AA9251HB-AT	○※	115/60	0.07	6.00	2400	0.96 34.00	0.12 2.95	30.1	230
	92x92x25	AA9252MB-AT	○※	230/50	0.07	14.90	1800	0.71 25.00	0.06 1.61	21.1	230
	92x92x25	AA9252MB-AT	○※	230/60	0.06	12.90	2200	0.86 30.50	0.08 1.96	26.8	230
	92x92x25	AA9252HB-AT	○※	230/50	0.07	13.40	2000	0.79 28.00	0.08 1.93	24.1	230
	92x92x25	AA9252HB-AT	○※	230/60	0.06	11.00	2400	0.96 34.00	0.12 2.95	30.1	230
AA12025	120x120x25	AA1251MB-AT	○※	115/50	0.24	22.30	2200	1.84 65.00	0.13 3.30	38.7	340
	120x120x25	AA1251MB-AT	○※	115/60	0.20	18.80	2300	2.01 71.00	0.16 3.96	44.1	340
	120x120x25	AA1252MB-AT	○※	230/50	0.10	21.60	2200	1.84 65.00	0.13 3.30	38.7	340
	120x120x25	AA1252MB-AT	○※	230/60	0.10	19.40	2300	2.01 71.00	0.16 3.96	44.1	340
AA12038	120x120x38	AA1281DB-AT(CF)	○※ ●	115/50	0.08	7.00	2300	1.98 70.00	0.13 3.30	39.2	550
	120x120x38	AA1281DB-AT(CF)	○※ ●	115/60	0.08	6.60	1700	1.52 53.50	0.06 1.52	30.5	550
	120x120x38	AA1281LB-AT(CF)	○※ ●	115/50	0.12	9.00	2400	2.15 76.00	0.18 4.57	40.1	550
	120x120x38	AA1281LB-AT(CF)	○※ ●	115/60	0.11	8.70	2200	2.02 71.50	0.10 2.54	37.9	550
	120x120x38	AA1281MB-AT(CF)	○※ ●	115/50	0.18	13.80	2600	2.31 81.50	0.24 6.20	41.0	550
	120x120x38	AA1281MB-AT(CF)	○※ ●	115/60	0.15	12.40	2800	2.46 87.00	0.21 5.33	42.0	550
	120x120x38	AA1281HB-AT(CF)	○※ ●	115/50	0.24	17.00	2600	2.41 85.00	0.31 7.90	42.2	550

# AC Fan

- AK 172mm ~ 280mm / Thickness : min 51mm ~ max 89mm
- AA 80mm ~ 172mm / Thickness : min 25mm ~ max 51mm



Bearing type: ●=Ball ※=Sleeve ○=1B1S ●=Hypro Bearing

	Frame size (mm)	Model No.	Bearing Type	Volt Freq. (VAC/Hz)	Current (A)	Power (W)	Rated Speed (RPM)	Maximum AirFlow (CMM) (CFM)	Maximum Pressure (InAq) (mmAq)	*Noise Level (dB/A)	Weight (g)
AA12038	120x120x38	AA1281HB-AT(CF)	◎※●	115/60	0.19	14.00	2900	2.75 97.00	0.35 8.87	44.5	550
	120x120x38	AA1282DB-AT(CF)	◎※●	230/50	0.04	8.10	2300	1.98 70.00	0.13 3.30	39.2	550
	120x120x38	AA1282DB-AT(CF)	◎※●	230/60	0.04	7.70	1700	1.52 53.50	0.06 1.52	30.5	550
	120x120x38	AA1282LB-AT(CF)	◎※●	230/50	0.06	9.80	2400	2.15 76.00	0.18 4.57	40.1	550
	120x120x38	AA1282LB-AT(CF)	◎※●	230/60	0.05	9.40	2200	2.02 71.50	0.10 2.54	37.9	550
	120x120x38	AA1282MB-AT(CF)	◎※●	230/50	0.08	13.80	2600	2.31 81.50	0.24 6.20	41.0	550
	120x120x38	AA1282MB-AT(CF)	◎※●	230/60	0.07	12.50	2800	2.46 87.00	0.21 5.33	42.0	550
	120x120x38	AA1282HB-AT(CF)	◎※●	230/50	0.11	17.10	2600	2.41 85.00	0.31 7.90	42.2	550
AA12038(UB)	120x120x38	AA1281UB-AT(CF)	◎※●	115/50	0.28	21.20	2400	2.72 96.00	0.24 6.10	46.4	550
	120x120x38	AA1281UB-AT(CF)	◎※●	115/60	0.24	19.20	2600	3.03 107.00	0.25 6.35	48.1	550
	120x120x38	AA1282UB-AT(CF)	◎※●	230/50	0.14	17.50	2400	2.72 96.00	0.24 6.10	46.4	550
	120x120x38	AA1282UB-AT(CF)	◎※●	230/60	0.12	19.80	2600	3.03 107.00	0.25 6.35	48.1	550
AA12038(A1)	120x120x38	AA1281HB-AT(A1CF)	◎※●	115/50	0.27	20.40	2700	2.41 91.20	0.31 8.17	42.6	550
	120x120x38	AA1281HB-AT(A1CF)	◎※●	115/60	0.22	17.20	3100	2.75 103.50	0.35 9.07	47.0	550
	120x120x38	AA1282HB-AT(A1CF)	◎※●	230/50	0.13	20.80	2700	2.41 91.20	0.31 8.17	42.6	550
AA12038(T)	120x120x38	AA1282HB-AT(A1CF)	◎※●	230/60	0.11	17.60	3100	2.75 103.50	0.35 9.07	47.0	550
	120x120x38	AA1281HB-AWR2T(5E)	◎	115/50	0.15-0.19	10~16.5	1700-2500	2.51 88.50	0.29 7.47	43.0	570
AA12038(T)	120x120x38	AA1281HB-AWR2T(5N)	◎	115/50	0.15-0.19	10~16.5	1700-2500	2.51 88.50	0.29 7.47	43.0	570
	120x120x38	AA1281HB-AWR2T(6E)	◎	115/60	0.14-0.19	9~16.5	1500-2650	2.69 95.00	0.20 5.08	43.6	570
AA12038(T)	120x120x38	AA1281HB-AWR2T(6N)	◎	115/60	0.14-0.19	9~16.5	1500-2650	2.69 95.00	0.20 5.08	43.6	570
	120x120x38	AA1282HB-AWR2T(5E)	◎	230/50	0.06-0.12	8~19.5	1500-2600	2.51 88.50	0.29 7.47	43.0	570
AA12038(T)	120x120x38	AA1282HB-AWR2T(5N)	◎	230/50	0.06-0.12	8~19.5	1500-2600	2.51 88.50	0.29 7.47	43.0	570
	120x120x38	AA1282HB-AWR2T(6E)	◎	230/60	0.07-0.12	8~19.5	1450-2800	2.69 95.00	0.31 7.75	43.6	570
AA12038(T)	120x120x38	AA1282HB-AWR2T(6N)	◎	230/60	0.07-0.12	8~19.5	1450-2800	2.69 95.00	0.31 7.75	43.6	570
	172x150x51	AA1751HB-AT	◎	115/50	0.52	40.90	2500	5.55 196.00	0.43 10.80	52.3	930
AA17251	172x150x51	AA1751HB-AT	◎	115/60	0.47	36.70	2800	5.95 210.00	0.27 6.76	53.0	930
	172x150x51	AA1752HB-AT	◎	230/50	0.26	41.90	2500	5.55 196.00	0.43 10.80	52.3	930
AK17251(165)	172x150x51	AA1752HB-AT	◎	230/60	0.22	37.60	2800	5.95 210.00	0.27 6.76	53.0	930
	172x150x51	AK1651MB	◎	115/50	0.33	36.80	2400	4.53 160.00	0.34 8.64	53.0	1050
	172x150x51	AK1651MB	◎	115/60	0.31	34.50	2300	3.96 140.00	0.18 4.57	50.3	1050
	172x150x51	AK1651HB	◎	115/50	0.55	62.10	2600	4.87 172.00	0.43 11.00	55.5	1050
	172x150x51	AK1651HB	◎	115/60	0.46	51.80	2700	5.35 189.00	0.41 10.36	57.7	1050
	172x150x51	AK1652MB	◎	230/50	0.17	36.80	2400	4.53 160.00	0.34 8.64	53.0	1050
	172x150x51	AK1652MB	◎	230/60	0.17	36.80	2300	3.96 140.00	0.18 4.57	50.3	1050

# AC Fan



92x25



172x150x51



280x89



120x38  
AC in water

\*:Noise is measured at the distance of 1 meter from the axis of intake.  
Specifications are subject to change without prior notice.

Bearing type: ◎=Ball ※=Sleeve ○=1B1S ●=Hypro Bearing

	Frame size (mm)	Model No.	Bearing Type	Volt Freq. (VAC/Hz)	Current (A)	Power (W)	Rated Speed (RPM)	Maximum AirFlow (CMM) (CFM)	Maximum Pressure (InAq) (mmAq)	*Noise Level (dB/A)	Weight (g)	
AK17251(165)	172x150x51	AK1652HB	◎	230/50	0.27	59.80	2600	4.87 172.00	0.43 11.00	55.5	1050	
	172x150x51	AK1652HB	◎	230/60	0.23	50.60	2700	5.35 189.00	0.41 10.36	57.7	1050	
AK17251(175)	172x150x51	AK1751MB	◎	115/50	0.15	16.10	2500	4.25 150.00	0.41 10.44	56.0	1050	
	172x150x51	AK1751MB	◎	115/60	0.19	20.70	2500	4.25 150.00	0.36 9.19	56.0	1050	
	172x150x51	AK1751HB	◎	115/50	0.25	27.60	2700	5.10 180.00	0.53 13.54	63.0	1050	
	172x150x51	AK1751HB	◎	115/60	0.24	26.50	3100	5.95 210.00	0.70 17.78	65.0	1050	
	172x150x51	AK1752MB	◎	230/50	0.08	16.10	2500	4.25 150.00	0.41 10.44	56.0	1050	
	172x150x51	AK1752MB	◎	230/60	0.10	20.70	2500	4.25 150.00	0.36 9.19	56.0	1050	
	172x150x51	AK1752HB	◎	230/50	0.11	23.00	2700	5.10 180.00	0.53 13.54	63.0	1050	
	172x150x51	AK1752HB	◎	230/60	0.13	27.60	3100	5.95 210.00	0.70 17.78	65.0	1050	
	AK17689	176x176x89	AK1781HB	◎	115/50	0.57	64.40	2800	9.35 330.00	0.64 16.26	66.4	1800
		176x176x89	AK1781HB	◎	115/60	0.48	52.00	3200	10.76 380.00	0.81 20.57	70.0	1800
176x176x89		AK1782HB	◎	230/50	0.21	40.90	2800	9.35 330.00	0.64 16.26	66.4	1800	
176x176x89		AK1782HB	◎	230/60	0.23	49.50	3200	10.76 380.00	0.81 20.57	70.0	1800	
AK18065	180x180x65	AK1861HB	◎	115/50	0.53	59.80	2800	9.91 350.00	0.70 17.78	70.0	1800	
	180x180x65	AK1861HB	◎	115/60	0.50	55.20	3200	11.61 410.00	0.85 21.59	72.0	1800	
	180x180x65	AK1862HB	◎	230/50	0.23	46.50	2800	9.91 350.00	0.70 17.78	70.0	1800	
	180x180x65	AK1862HB	◎	230/60	0.24	51.10	3200	11.61 410.00	0.85 21.59	72.0	1800	
AK20572	205x205x72	AK2071HB	◎	115/50	0.60	67.90	2800	16.99 600.00	0.93 23.62	72.0	2100	
	205x205x72	AK2071HB	◎	115/60	0.88	100.00	3200	18.83 665.00	0.50 12.70	75.4	2100	
	205x205x72	AK2072HB	◎	230/50	0.32	63.20	2800	16.99 600.00	0.93 23.62	72.0	2100	
	205x205x72	AK2072HB	◎	230/60	0.47	95.20	3200	18.83 665.00	0.50 12.70	75.4	2100	
AK25489	254x89	AK2581MB	◎	115/50	0.22	24.20	1350	12.74 450.00	0.26 6.65	55.6	2000	
	254x89	AK2581MB	◎	115/60	0.24	26.50	1600	15.01 530.00	0.32 8.18	57.0	2000	
	254x89	AK2581HB	◎	115/50	0.55	56.00	2100	19.26 680.00	0.35 8.79	66.0	2000	
	254x89	AK2581HB	◎	115/60	0.62	67.80	2000	17.84 630.00	0.28 7.01	62.0	2000	
	254x89	AK2582MB	◎	230/50	0.16	32.20	1350	12.74 450.00	0.26 6.65	55.6	2000	
	254x89	AK2582MB	◎	230/60	0.14	28.80	1600	15.01 530.00	0.32 8.18	57.0	2000	
	254x89	AK2582HB	◎	230/50	0.26	55.40	2100	19.26 680.00	0.35 8.79	66.0	2000	
	254x89	AK2582HB	◎	230/60	0.30	62.80	2000	17.84 630.00	0.28 7.01	62.0	2000	
AK28089	280x89	AK2881HB	◎	115/50	1.80	180.00	2800	33.96 1200.00	1.26 32.00	75.0	4240	
	280x89	AK2881HB	◎	115/60	2.60	260.00	3200	39.62 1400.00	1.11 28.19	78.0	4240	
	280x89	AK2882HB	◎	230/50	0.78	177.10	2800	33.96 1200.00	1.26 32.00	75.0	4240	
	280x89	AK2882HB	◎	230/60	1.22	260.00	3200	39.62 1400.00	1.11 28.19	78.0	4240	



# Metal Finger Guard

MFG 4cm-9cm, 12cm, 17cm

Welded, Nickel-Chrome Plated Steel

SIZE:40X40MM

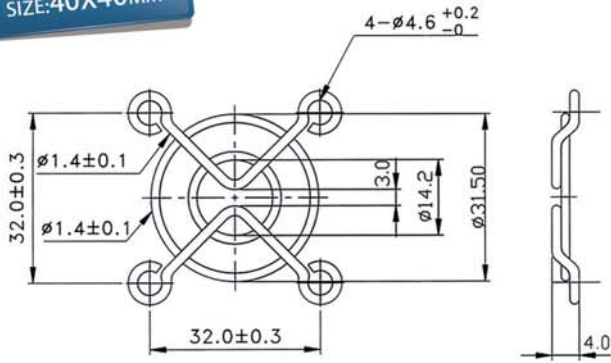

SIZE:80X80MM

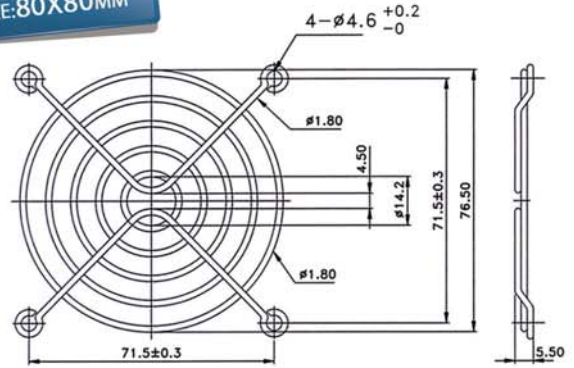

SIZE:50X50MM

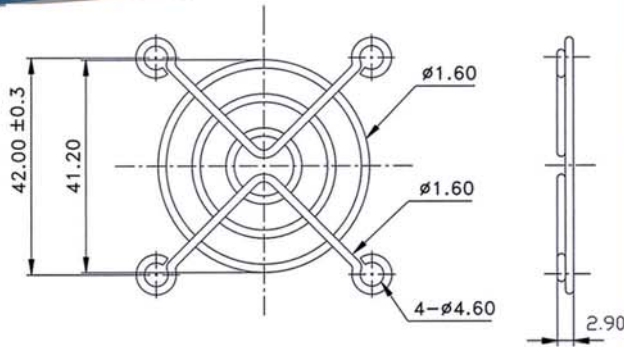

SIZE:90X90MM

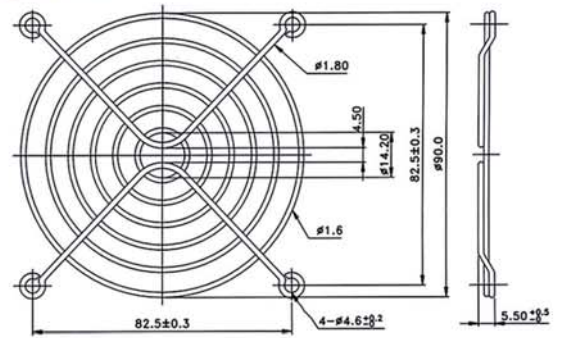

SIZE:60X60MM

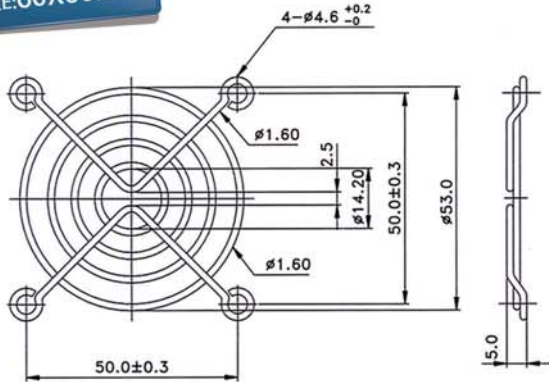

SIZE:120X120MM

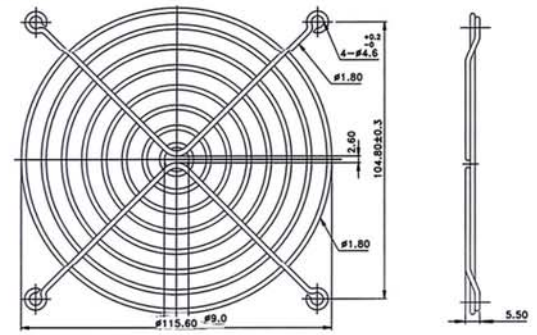

SIZE:70X70MM

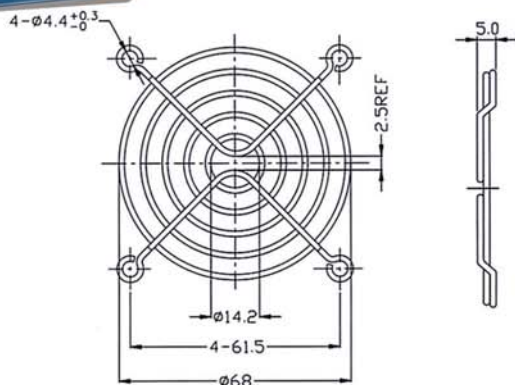

SIZE:170X170MM

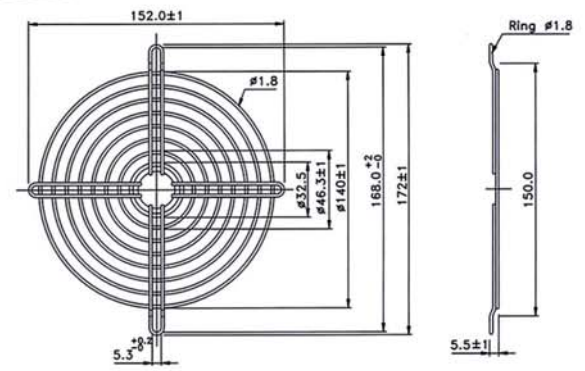

# Plastic Filters

Consist of three parts

- Finger guard
- Filter media
- Filter cover



## Dimension(unit in m/m)

P/N.	FAN SIZE	Dim.A	Dim.B	Dim.C	Dim.D	Dim.E	Mounting Hole Dia.
GRM-040	40mm	45.1	8.3	32.0	5.0	41.9	φ 3.8
GRM-060	60mm	65.1	9.5	50.0	5.0	61.9	φ 3.8
GRM-080	80mm	85.3	12.3	71.5	6.0	81.0	φ 3.8
GRM-090	92mm	95.8	12.3	82.5	6.0	92.5	φ 3.8
GRM-120	120mm	125.7	12.3	104.8	6.0	121.4	φ 5.1

Plastic material:ABS 94v-0,Flame Retardant.  
Color:Standard = Black.Other colors can be specified.

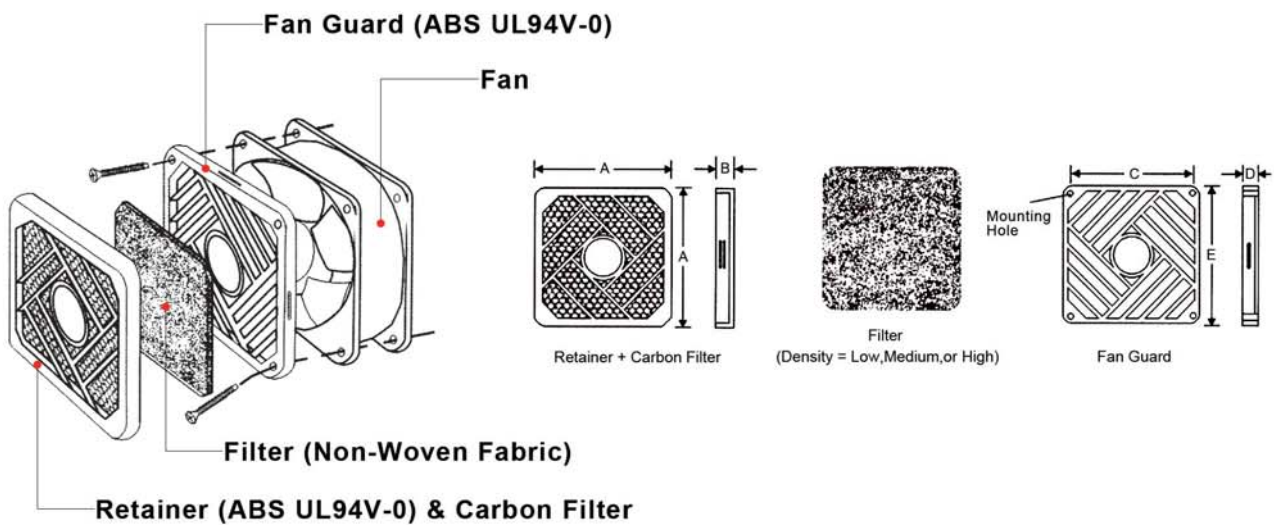

# Plugs & Cables

\*Made of UL/CAS approved material.

\*Four configurations available.

\*The standard cord lengths.



## 45°

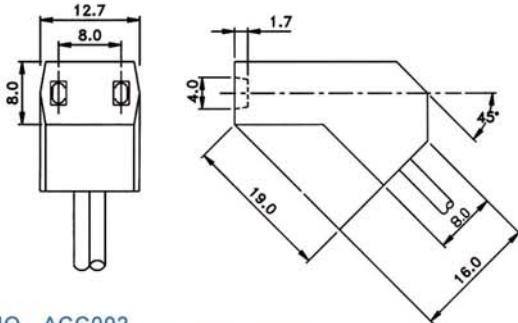

MODEL NO. ACC002  
 DESCRIPTION : PIUG = PVC UL 105 °C  
 MATERIAL : LEAD WIRE = SPT-1 18 AWG 105°  
 FINISH : TERMINAL= JISC5120 PBS  
 TOLERANCE LINEAR +/- 50 MM  
 ANGULAR +/- 0.5 DEG.

ITEM	SIZE	PART NO.
01	12 inches (304.8 mm)	MEP1549718510
02	24 inches (609.6 mm)	MEP1549718520
03	36 inches (914.4 mm)	MEP1549718530
04	40 inches (1016.0 mm)	MEP1549718540
05	50 inches (1270.0 mm)	MEP1549718550
06	60 inches (1524.0 mm)	MEP1549718560
07	80 inches (2032.0 mm)	MEP1549718570
08	314.961 inches (8000.0 mm)	MEP1549718580

## 90°

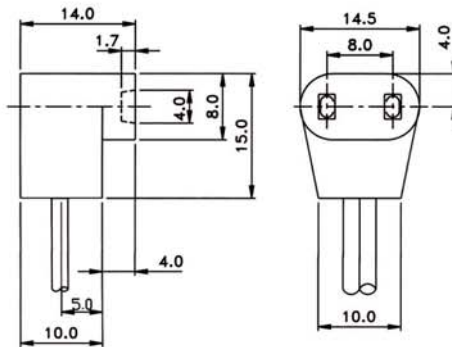

MODEL NO. ACC003  
 DESCRIPTION : PIUG = PVC UL 105 °C  
 MATERIAL : LEAD WIRE = SPT-1 18 AWG 105°  
 FINISH : TERMINAL= JISC5120 PBS  
 TOLERANCE LINEAR +/- 20 MM  
 ANGULAR +/- 0.5 DEG.

ITEM	SIZE	PART NO.
01	12 inches (304.8 mm)	MEP1549718610
02	24 inches (609.6 mm)	MEP1549718620
03	36 inches (914.4 mm)	MEP1549718630
04	40 inches (1016.0 mm)	MEP1549718640
05	50 inches (1270.0 mm)	MEP1549718650
06	60 inches (1524.0 mm)	MEP1549718660
07	80 inches (2032.0 mm)	MEP1549718670

## 180°

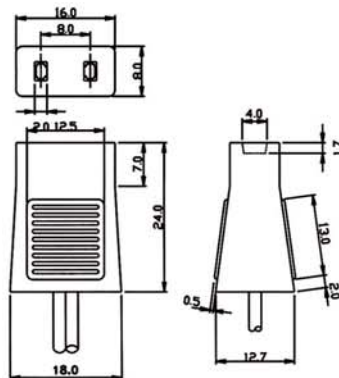

MODEL NO. ACC001  
 DESCRIPTION : PIUG = PVC UL 105 °C  
 MATERIAL : LEAD WIRE = SPT-1 18 AWG 105°  
 FINISH : TERMINAL= JISC5120 PBS  
 TOLERANCE LINEAR +/- 20 MM  
 ANGULAR +/- 0.5 DEG.

ITEM	SIZE	PART NO.	AWG#
01	12 inches (304.8 mm)	MEP1549718410	18/105 °C
02	24 inches (609.6 mm)	MEP1549718420	18/105 °C
03	36 inches (914.4 mm)	MEP1549718430	18/105 °C
04	40 inches (1016.0 mm)	MEP1549718440	18/105 °C
05	50 inches (1270.0 mm)	MEP1549718450	18/105 °C
06	60 inches (1524.0 mm)	MEP1549718460	18/105 °C
07	80 inches (2032.0 mm)	MEP1549718470	18/105 °C
08	40 inches (1016.0 mm)	MEP1549718480	18/180 °C
09	314.961 inches (8000.0 mm)	MEP1549718490	18/180 °C

## TAIPEI

### Taipei Fan Domestic Sales Office

22175,9FL-6, No.81,Sec.1, Hsin-Tai 5th Road ,  
Sijhih District, New TaipeiCity, Taiwan (R.O.C)  
Tel:886-2-2698-0277  
Fax:886-2-2698-0295  
E-mail: adda@adda.com.tw

### Taipei Fan Domestic RD Office

22175,10F-7, No.77, Sec.1, Hsin-Tai 5th Road ,  
Sijhih District, New TaipeiCity, Taiwan (R.O.C)  
Tel:886-2-8698-4160  
Fax:886-2-8698-4222  
E-mail: adda@adda.com.tw

### Taipei Thermal Department

22175,10F-7, No.77, Sec.1, Hsin-Tai 5th Road,  
Sijhih District, New Taipei City, Taiwan (R.O.C)  
Tel:886-2-8698-4160  
Fax:886-2-8698-4222  
E-mail: adda@adda.com.tw

## CHINA-SHENZHEN

### Warburg Branch Trade (ShenZhen) Co., Ltd

(ShenZhen China) Rm 1101-1102, Xing Ji  
Building XinSha Road Shajing Town Bao An  
District, Shenzhen, China  
Tel:86-755-29883085  
Fax:86-755-29883055  
E-mail: swsd335@adda.com.cn  
Website: www.addachina.com

## HONG KONG

### ADDA Corporation (Hong Kong)

Unit 1017, Nan fung Centre, 264 Castle Peak  
Road, Tsuen Wan, HongKong  
Tel:852-24158608  
Fax:852-24023078  
E-mail: service@addacorp.com.hk

## NORTH AMERICA

### ADDA USA, INC

1502 WEST YALE AVE, ORANGE, CA 92867, USA  
Tel:1-714-674-7920  
Fax:1-714-257-7486  
E-mail: sales@addausa.com

## KAOHSIUNG

### Group Administration & Fan International Sales Office

80247,35F, No.38, Singuang Road,Ling  
Ya District,Kaohsing City,Taiwan(R.O.C)  
Tel:886-7-269-5166  
Fax:886-7-269-5366  
E-mail: adda@adda.com.tw

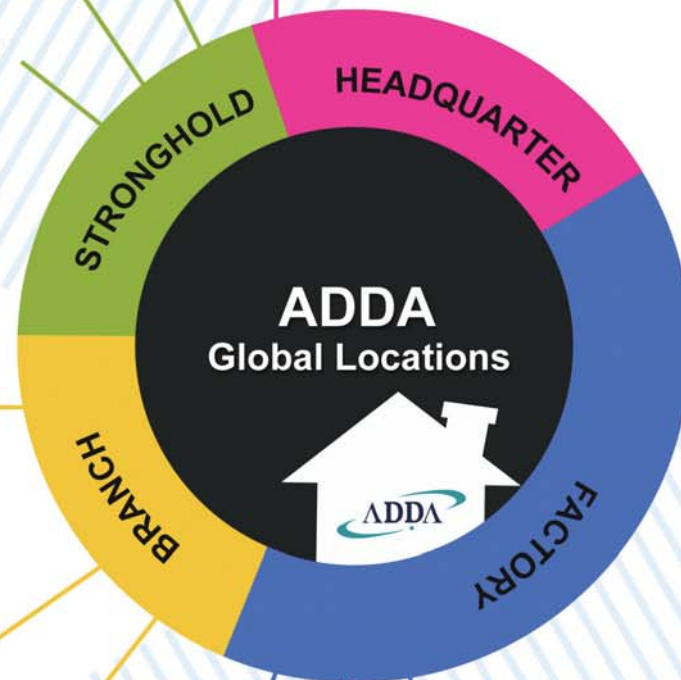

## PING TUNG

### FACTORY (PingTung,Taiwan)

90049,No.6, East Section Industrial 6th  
Road, PingTung City, PingTung County,  
Taiwan (R.O.C)  
Tel:886-8-755-0579  
Fax:886-8-753-2815  
E-mail: adda@adda.com.tw

## CHINA-KUN SHAN

### ADDA Electric Machinery Technology (Kun Shan) Co., Ltd.

No.88 JiangFeng Road, Zhang-Pu Town, KunShan City,  
JiangSu Province, China  
Tel:86-512-57451127  
Fax:86-512-57451146  
E-mail: addaks@adda.com.cn

### ADDA CORPORATION Kun Shan ADD Green Electric Co.,Ltd.

No.88 JiangFeng Road, Zhang-Pu Town, KunShan City,  
JiangSuProvince, China  
Tel:86-512-57451127  
Fax:86-512-57273831  
E-mail: addaks@adda.com.cn

## CHINA-SHENZHEN

### Gao Xing Wang Electrical (ShenZhen) Co., Ltd

(Fan -Shenzhen , China)1~3F, building 1.2.3 From  
North To South),Da zhong gang Industrial District,  
Wanfeng, Shajing, Baoan, Shenzhen,China  
Tel:86-755-27230759  
Fax:86-755-27230641  
E-mail: addasw@adda.com.cn

### ADDA Gao Jing Electrical (ShenZhen) Co. Ltd

(Thermal, ShenZhen China) Ninety-Eight Industrial City,  
Wanfeng Shajing, Baoan District, Shenzhen, China  
Tel:86-755-29851308  
Fax:86-755-29851108  
E-mail: addagv@adda.com.cn

# Honors & Certifications

## AWARDS

1995	Taiwan Excellence
1996	Elite Award
	Taiwan Excellence for two items
1997	Taiwan Excellence
1998	Rising Star Award
	Taiwan Excellence for three items
1999	Taiwan Excellence for five items
2000	Taiwan Excellence for three items
	Gold Award of National Symbol of Excellence
2001~2003	Taiwan Excellence for eleven items
2004	Taiwan Excellence for three items
2005	Taiwan Excellence for three items
2006	Taiwan Excellence for three items
2007~2008	Taiwan Excellence for three items
2009	Taiwan Excellence
2010	Taiwan Excellence for two items
2011	Taiwan Gold Medal Quality Product
2012	Taiwan Excellence for three items
	OSmart AC Fan award the Computex Taipei@Best Choice Award - Green ICT
	Dust Fan award the Taitronics Taipei @ Technology Innovation Awards



## Safety Approvals



## Patents number by COUNTRY



## Patents number by YEAR





Be ur **FANs!!**

[www.adda.com.tw](http://www.adda.com.tw)



Scan QR code  
>> Surf ADDA website.

Copyright 2013 ADDA Corporation. All Rights Reserved.