



**Model 22HHP-10
(Bushingmount)**

**Model 22HHPS-10
(Servomount)**

● **Standard Dimensions**

■ **Bushingmount type**

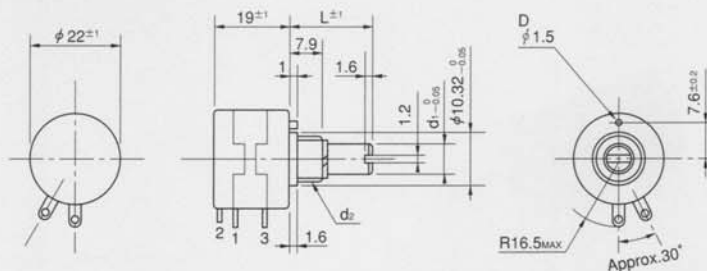

Note: Dimensions of shaft and bushing are equal to those of model 22HP series with wirewound resistive element and please refer to those dimensions and notes.

■ **Servomount type (bronze bearing incorporated)**

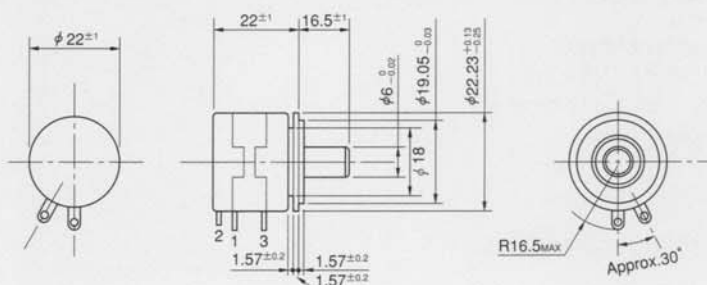

● **Standard Model Nos.**

Bushingmount type:

- 5-turn models: 22HHP-5 22HHP-5M
- 22HHP-5E 22HHP-5N
- 10-turn models: 22HHP-10 22HHP-10M
- 22HHP-10E 22HHP-10N

Servomount type:

- 5-turn models: 22HHPS-5
- 10-turn models: 22HHPS-10

● **General Specifications**

Standard Resistance

Values: 1k,2k,5k,10k,20k,50k (Ω) (5-turn)
2k,5k,10k,20k,50k,100k (Ω) (10-turn)

Total Resistance

Tolerance: Standard Class ±10% (K)
Precision Class ±5% (J)

Independent Linearity

Tolerance:

	5-turn	10-turn
Standard Class	±0.35%	±0.25%
Precision Class	±0.2%	±0.1%

Resolution:

Output Smoothness: Essentially infinite
Below 0.05% against input voltage (5-turn)
Below 0.015% against input voltage (10-turn)

Contact Resistance

Variation: Below 5% C.R.V. (5-turn)
Below 3% C.R.V. (10-turn)

Power Rating:

1.0W (5-turn)
2.0W (10-turn)

Electrical Travel:

360° × n ±5° (n: No. of turns)

Mechanical Travel:

360° × n +10°₀ (n: No. of turns)

Insulation Resistance:

Over 100MΩ at 1,000V.D.C.

Dielectric Strength:

1 minute at 1,000V.A.C.

Starting Torque:

Below 5mN·m (50gf·cm)

Stopper Strength:

Approx. 0.9N·m (9kgf·cm)

Max. Working Voltage:

500V

Resistance Temperature Coefficient:

±100p.p.m./°C

Max. Torque exerted on fastening the mounting nut to the bushing:

Below 1.0N·m (10kgf·cm)
(In case of panel thickness with over 2.5mm., the rotating torque may become heavier.)

Mass:

Approx. 20g (Bushingmount)
Approx. 30g (Servomount)
(Both 5-turn and 10-turn)

● **Special Specifications Available**

Shaft with front and rear extension (Rear shaft with 6mm dia. and 15mm length), 3-turn type, Multi-ganged (Available up to 10 gangs), With high torque, Special shaft dia. (φ 3mm, φ 3.175mm, φ 4mm, φ 6.35mm), Special machining on the shaft, With plastic shaft, Metal bushing type (22HHPM with anti-rotation pin), Simple sealed housing, Extra taps (Available up to 1 tap only for 10-turn), Slipping-clutch incorporated type.