

Standard Model Nos.

Bushingmount type:

With lug terminals:

12HP-5 (5-turn)

12HP-10 (10-turn)

With pin terminals for p.c. board:

12HP-5P (5-turn)

12HP-10P (10-turn)

Servomount type:

12HPS-5 (5-turn)

12HPS-10 (10-turn)

Standard Dimensions

Bushingmount type

With lug terminals

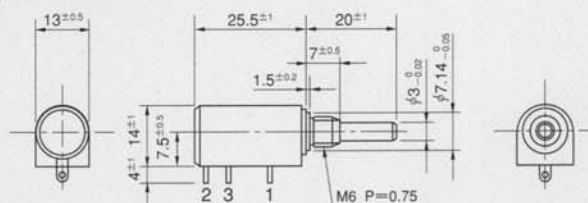

With pin terminals for p.c. board

Terminal Holes Layout

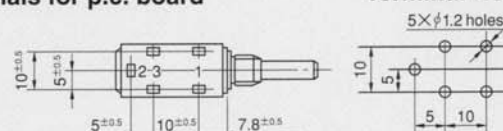

Note: 1. pc. each inner teeth washer and hex nut are attached.
2. Please process the mounting hole on the panel to be mounted with this potentiometer by the diameter of $7.14\text{mm}^{+0.05}_0$.

Servomount type

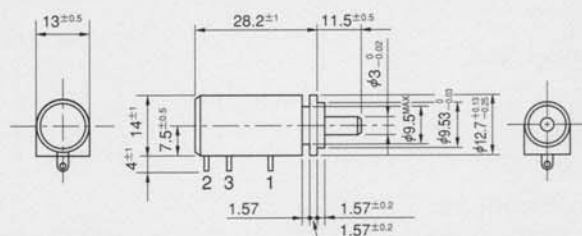

Note: 1. Outer dimensions of 5-turn version are same as those of 10-turn.
2. Servomount type with pin terminals for p.c. board is also available.

General Specifications

Standard Resistance

Range: 100 Ω to 50k Ω (5-turn)
100 Ω to 100k Ω (10-turn)

Max. Practical

Resistance Value: 70k Ω (5-turn)
150k Ω (10-turn)

Total Resistance

Tolerance: Standard Class $\pm 3\%$ (H)
Precision Class $\pm 1\%$ (F)

Independent Linearity

Tolerance: 5-turn 10-turn
Standard Class $\pm 0.35\%$ $\pm 0.25\%$
Precision Class $\pm 0.2\%$ $\pm 0.1\%$
(Below 5k Ω) ($\pm 0.25\%$) ($\pm 0.15\%$)

Power Rating:

0.75W (5-turn)

1.5W (10-turn)

Noise:

Below 100 Ω E.N.R.

Electrical Travel:

$360^\circ \times n \pm 5^\circ$ (n: No. of turns)

Mechanical Travel:

$360^\circ \times n + 15^\circ$ (n: No. of turns)

Insulation Resistance:

Over 1,000M Ω at 500V.D.C.

Dielectric Strength:

1 minute at 1,000V.A.C.

Starting Torque:

Below 3mN \cdot m (30gf \cdot cm)

(Bushingmount type)

Below 2mN \cdot m (20gf \cdot cm)

(Servomount type)

Approx. 0.15N \cdot m (1.5kgf \cdot cm)

Stopper Strength:

Max. Torque exerted

on fastening the

mounting nut to

the bushing:

Below 0.8N \cdot m (8kgf \cdot cm)

Max. Working

Voltage:

450V

Resist. Temperature

Coefficient of Wire:

$\pm 20\text{p.p.m./}^\circ\text{C}$

Mass:

Approx. 10g

(Both 5-turn and 10-turn)

Standard Resistance Values ■ No. of Wire Turns ■ Resistance Wire Used

Resist. Value (Ω)	100	200	500	1k	2k	5k	10k	20k	50k	100k
12HP-5	920	1,190	1,250	1,510	1,790	2,380	3,120	3,800	5,430	—
12HP-10	1,690	1,850	2,560	2,500	3,030	4,170	4,760	6,250	8,330	10,870
Resist. Wire Used	Cu-Ni System			Ni-Cr System						

Special Specifications Available

3-turn type (S12HP-3), Lower resistance values (20 Ω , 50 Ω), Shaft with front and rear extension (Rear shaft with 0.8mm dia. and 10mm length), Special machining on the shaft, Simple sealed housing (in case of servomount type, the housing length becomes longer by 1.5mm).