

● Standard Model Nos.

**Bushingmount type:**

With lug terminals:

12HHP-10E

With pin terminals for p.c. board:

12HHP-10EP

**Servomount type:**

12HHP-10E

● General Specifications

**Standard Resistance**

**Values:** 1k, 2k, 5k, 10k, 20k, 50k ( $\Omega$ )

**Max. Practical Resistance Value:** 100k  $\Omega$

**Total Resistance**

**Tolerance:** Standard Class  $\pm 10\%$  (K)  
Precision Class  $\pm 5\%$  (J)

**Independent Linearity**

**Tolerance:** Standard Class  $\pm 0.4\%$   
Precision Class  $\pm 0.1\%$   
( $\pm 0.2\%$  in case of below 5k  $\Omega$ )

**Resolution:**

**Output Smoothness:** Essentially infinite

**Contact Resistance**

**Variation:** Below 5% C.R.V.

**Power Rating:** 1.0W

**Electrical Travel:**  $3,600^\circ \pm 5^\circ$

**Mechanical Travel:**  $3,600^\circ \pm 15^\circ$

**Insulation Resistance:** Over 1,000M $\Omega$  at 500V.D.C.

**Dielectric Strength:** 1 minute at 1,000V.A.C.

**Starting Torque:** Below 3mN $\cdot$ m (30gf $\cdot$ cm)

(Bushingmount type)

Below 2mN $\cdot$ m (20gf $\cdot$ cm)

(Servomount type)

Approx. 0.15N $\cdot$ m (1.5kgf $\cdot$ cm)

**Stopper Strength:**

**Max. Torque exerted**

**on fastening the**

**mounting nut to the**

**bushing:**

Below 0.8mN $\cdot$ m (8kgf $\cdot$ cm)

**Max. Working Voltage:** 450V

**Resistance**

**Temperature**

**Coefficient:**

$\pm 100$ p.p.m./ $^\circ$ C

**Mass:**

Approx. 10g

● Standard Dimensions

■ Bushingmount type

● With lug terminals

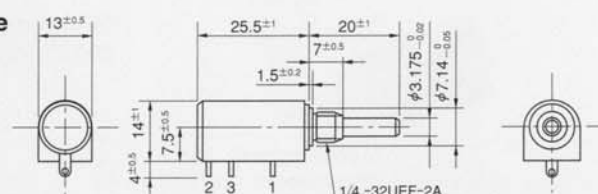

● With pin terminals for p.c. board

Terminal Holes Layout

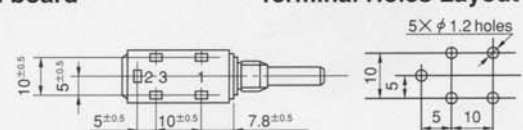

Note: 1. 1 pc. each inner teeth washer and hex nut are attached.

2. Please process the mounting hole on the panel to be mounted with this potentiometer by the diameter of 7.14mm  $+0.05$ .

■ Servomount type

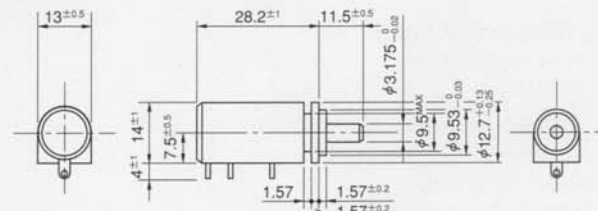

Note: Servomount type with pin terminals for p.c. board is also available.

● Special Specifications Available

5-turn type (S12HHP-5E), Shaft with front and rear extension (Rear shaft with 0.8mm dia. and 10mm length), Special machining on the shaft, Simple sealed housing (in case of servomount type, the housing length becomes longer by 1.5mm.).

**The World's Newest Snapping-in Construction in Model 22HP series**

(PAT.)



By using most modern plastic engineering technology as well as our patented designs, number of parts can be reduced steeply by about 50% almost without any degradation in all performances and by that means, the total cost-down by 30 to 50% is achieved in comparison with similar multi-turn potentiometers of the same diameter.