

Multi-axis controller V14



The multi-axis controller V14 is a robust switching device for remote control and electro-hydraulic applications. The modular design enables the switching device to be used universally. The V14 is resistant to oil, maritime conditions e.g. offshore / vessels, UV radiation typically from the sun.

Technical data

Mechanical life V14	6 million operating cycles
Operation temperature	-40°C to +85°C
Degree of protection	up to IP65



	V14L	S8	P	T	Example				
					-01 Z C	+03 R	-A05 C61	+A110	-X
Basic unit	V14L 2-axis left								
Control-handle extended	Standard 60 mm**								
S8	+20 mm								
<i>*Only available in combination with handle!</i>									
Gate									
P	Cross gate								
Grip / Palm grip									
T	Dead man								
Axis 1 (direction 1-2)									
01	2 contacts (2A 250 V AC15)								
Z	Spring return								
C	Mechanical encoder								
Axis 2 (direction 3-4)									
03	6 contacts (2A 250 V AC15)								
R	Friction brake								
Description axis 1 (direction 1-2)									
A05	Arrangement MSP21								
C61	Mechanical encoder MEC 1-2								
Description axis 2 (direction 3-4)									
A110	Arrangement MS24-0								
Special model									
X	Special / customer specified								

V14L S8 P T - 01 Z C + 03 R - A05 C61 + A110 - X

Z Spring return *(included in basic unit!)*

R Friction brake

C Mechanical encoder

C61	MEC 1-2	
	EA/02-10	I max. 1 mA
	Potentiometer track	2 x 10 kOhm
	Direction track	Arrangement MS26-0
C62	MEC 1-7	
	EA/10-10	I max. 1 mA
	Potentiometer track	2 x 5 kOhm
	Direction track	Arrangement MS26-0-1
C66	MEC 1-10	
	EA/17-10	I max. 10 mA
	Potentiometer track	2 x 1,5 kOhm
	Direction track	Arrangement MS21-0+MS21
C63	MEC 1-6	
	EA/09-10	
	6 Bit Gray Code	
C64	MEC 1-6-5	
	ER/36-10	Us=18-30 V
	Current output 20...4...20 mA	
C65	MEC 1-6-8	
	ER/36-12	Us=18-30 V
	Current output 20...0...20 mA	
C67	MEC 1-6-9	
	ER/36-11	Us=18-30 V
	Voltage output 10...0...10 V	

H Hall-Potentiometer

E14811

0,5...2,5...4,5 V / 4,5...2,5...0,5 V

V14L S8 P T - 01 Z C + 03 R - A05 C61 + A110 - X

Axis 2: direction 3-4 left / direction 7-8 right

(not applied for V14.1L and V14.1R)

See description axis 1!

Special model

X Special / customer specified

1

1

T = Dead man's button
H = Signal button
M = Latch for mechanical zero interlock

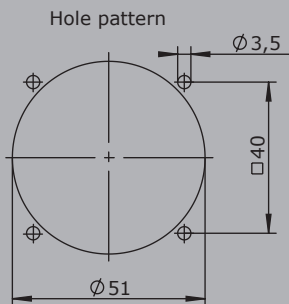
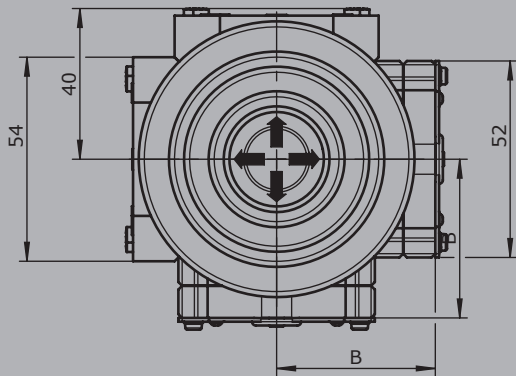
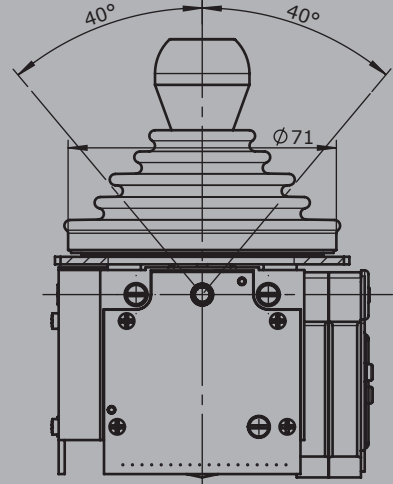
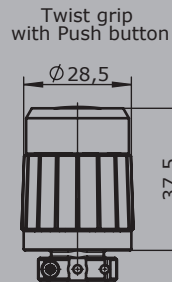
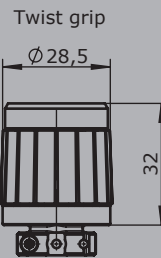
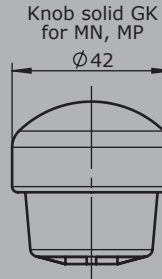
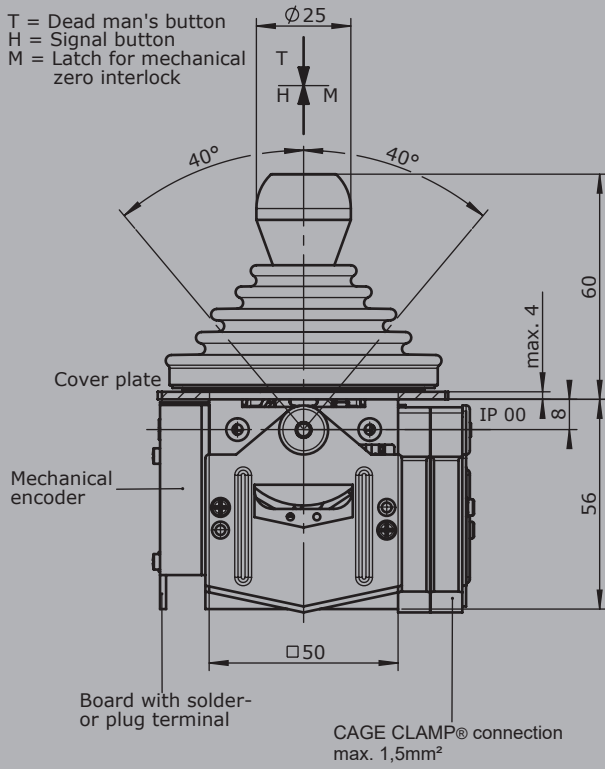

Type	No. of contacts	Dim.
01	2	36
02	4	45
03	6	54