

PLCC-SMD Socket 1,27 mm

Series **082**

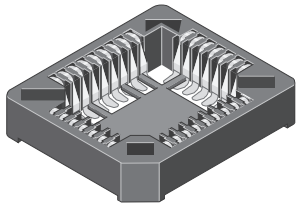

Rated current	1,0 A
Rated voltage	100 V _{RMS} / V _{DC}
Withstand voltage	600 V _{RMS} for 1 minute
Material contact	Phosphor bronze
Material insulator	High temp. thermoplast UL94V-0
Operating temperature	-40°C to +85°C
Max. processing temper.	260°C for 10 seconds

pitch	1,27
termination	
max. pincount	084

All dimensions in mm.

Variation

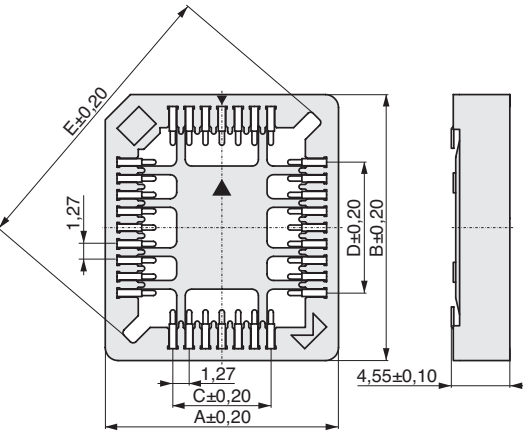

1

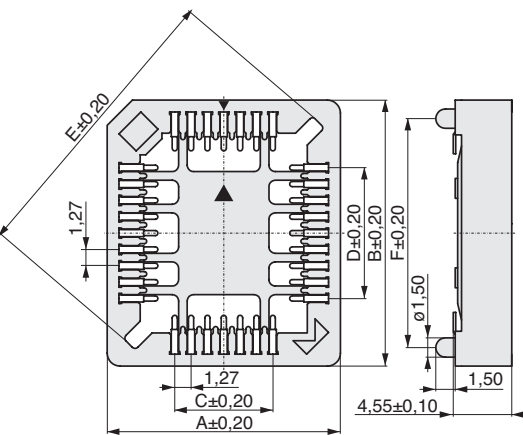

2

Low profile

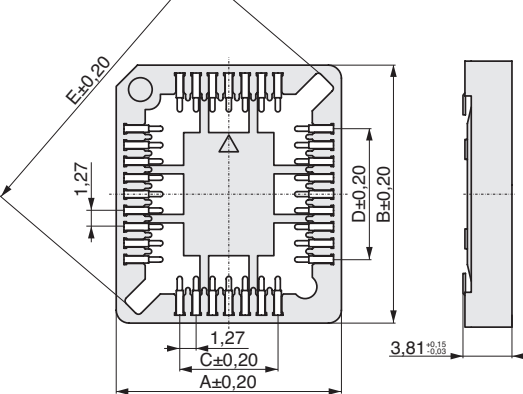

3

Removal Tool

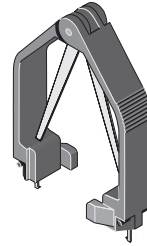

086

PCB Layout

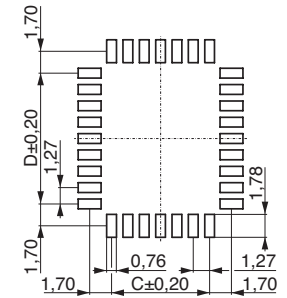

086-1-00

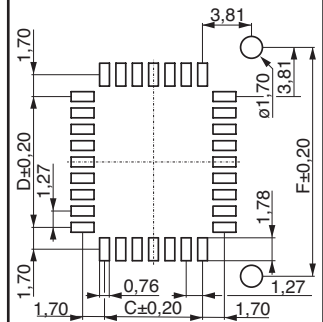

n	no. of contacts						available in variation
	A	B	C	D	E	F	
020	15,56	15,56	5,08	5,08	18,20	12,70	1 2
028	18,10	18,10	7,62	7,62	21,70	15,24	1 2
032	18,10	20,64	7,62	10,16	23,65	17,78	1 2
032	16,95	19,50	7,62	10,16	22,35	-	3
044	23,18	23,18	12,70	12,70	28,80	20,32	1 2
052	25,72	25,72	15,24	15,24	32,50	22,86	1 2
068	30,80	30,80	20,32	20,32	40,00	27,94	1 2
084	35,88	35,88	25,40	25,40	47,15	33,02	1 2

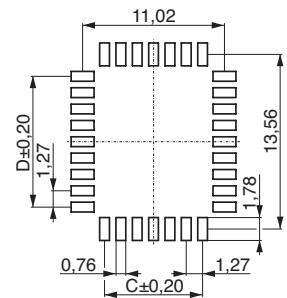

Colour:
0 = Black
7 = Brown

Packaging:
R = Reel
T = Tube

Variation (1,2,3)

No. of contacts

Colour

Packaging (R,T)



www.mpe-connector.de

Order code:

082-?-?-??-?-X?0

Product group
10