

REFERENCE: MPCL 98 CAT. P76

REVISION

GENERAL DESCRIPTION:

MODEL LP-xxxFZ IS A SEALED, CONDUCTIVE PLASTIC LINEAR POTENTIOMETER DESIGNED FOR HARSH OUTDOOR APPLICATIONS. ITS SEALED CONSTRUCTION, STURDY ALUMINUM CASE AND $\phi 12$ mm (0.47" DIA.) SHAFT ALLOW THE POTENTIOMETER TO ENDURE OPERATIONS IN SEVERE OUTDOOR AMBIENT AS WELL AS IN OILY, DUSTY MACHINERY APPLICATIONS.

C.O.N	SYM	DESCRIPTION	DATE	DRAWN	APPR'D
	A	1) RESISTANCE VALUE, 0.5k AND 30k REMOVED AND 20k WAS STD. 2) SEAL COMPLIANCE ADDED.	08/14/03	T.TSUGAWA	

CAUTION:
DO NOT EXPOSE THESE AREAS TO ANY LIQUID TO PREVENT THE LIQUID FROM PENETRATING THROUGH THE WIRES INTO INTERIOR OF THE CASE.

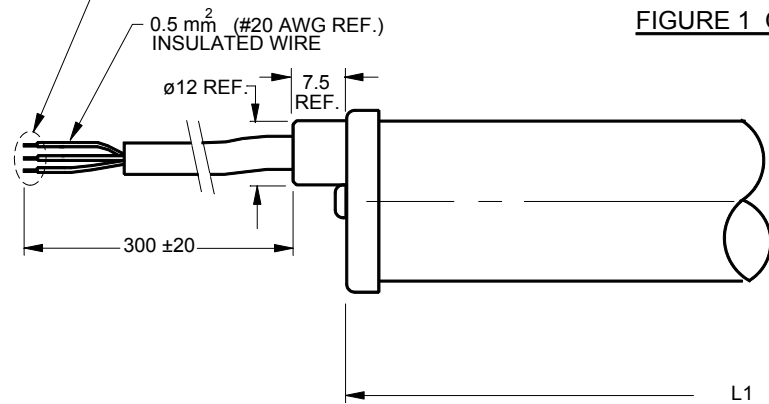

FIGURE 1 OUTLINE DIMENSION

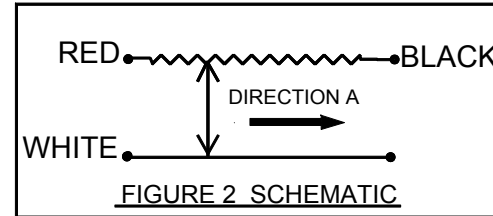
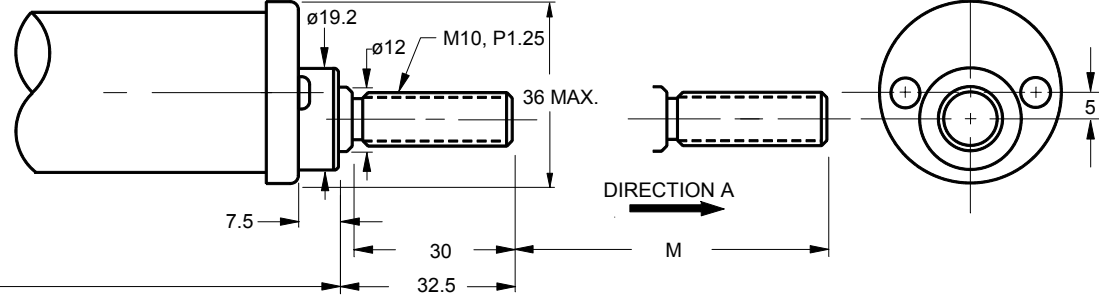

FIGURE 2 SCHEMATIC



SPECIFICATIONS

MODEL NO.:	LP-50FZ	LP-100FZ	LP-150FZ	LP-200FZ	LP-250FZ	LP-300FZ	LP-400F
ELECTRICAL STROKE:	50 mm	100 mm	150 mm	200 mm	250 mm	300 mm	400 mm
MECH. STROKE (M):	53±1 mm	103±1 mm	153±1 mm	203±1 mm	253±1 mm	303±1 mm	403±1 mm
^(A) RESISTANCE in k Ω ($\pm 20\%$):	1, 2, 5	1, 2, 5, 10	1, 2, 5, 10	1, 2, 5, 10 (20 AVAILABLE)	2, 5, 10 (20 AVAILABLE)	2, 5, 10 (20 AVAILABLE)	5, 10
POWER RATING :	1.5 W @ 70°C	2.5 W @ 70°C	3 W @ 70°C	4 W @ 70°C	4 W @ 70°C	4 W @ 70°C	4.5 W @ 70°C
HOUSING LENGTH (L1):	100 ±1 mm	150 ±1 mm	200 ±1 mm	250 ±1 mm	300 ±1 mm	350 ±1 mm	400 ±1 mm
INDEPENDENT LINEARITY:	±0.5% (±0.2% AVAILABLE)	±0.3% (±0.1% AVAILABLE)	±0.3% (±0.1% AVAILABLE)	±0.3% (±0.1% AVAILABLE)	±0.3% (±0.1% AVAILABLE)	±0.3% (±0.1% AVAILABLE)	±0.1%
WEIGHT:	APPROX. 260g	APPROX. 340g	APPROX. 430 g	APPROX. 510g	APPROX. 590g	APPROX. 680g	APPROX. 850g

OUTPUT SMOOTHNESS: 0.1% MAX.
 INSULATION RESISTANCE: 100 meg OHMS MIN. @ 500 Vdc
 DIELECTRIC STRENGTH: 500 Vrms @ 50/60 Hz for 1 MINUTE
 OPERATING TEMPERATURE: -40°C to +125°C
 TEMPERATURE COEFFICIENT: ±400 ppm/°C MAX.
 FRICTION: 2 kgf MAX.
^(A2) SEAL COMPLIANCE: IP64

UNLESS OTHERWISE SPECIFIED, DIMENSIONS ARE IN mm(in).
 TOLERANCES:
 ANGLES: ±1.5°
 <10 mm: ±0.25
 <100 mm: ±0.5
 >100 mm: ±1

DRAWN	T. TSUGAWA	DATE	06/16/98
CHECKED		DATE	
APPROVED		DATE	
APPROVED		DATE	
SCALE:			

SPECIFICATION DWG
 FOR
MODEL LP-xxxFZ
 LINEAR POTENTIOMETER
 WATER-PROOF CONSTRUCTION
 FILE: LP-xxxFZ

Midori America Corporation
 FULLERTON, CA
B-MAC-B20 A
 1 OF 1