



The multi-axis controller V 3 is a rugged switching device according IEC 947-5-1 EN 60947 DIN VDE 0660-200 for hoisting applications. The modular design enables the switching device to be used universally. The V 3 is resistant to oil, maritime climate ozone and UV radiation.

**Contact complement 4 A 250 V AC 15 res. 1 A 24 V DC 13**

Mechanical life 6 million (operating cycles)  
Permissible ambient temperature Operation -40° C to + 60° C  
Storage -50° C to + 80° C

Climate resistance  
Damp heat constant DIN IEC 68 part 2-3  
Damp heat cyclic DIN IEC 68 part 2-30  
Degree of protection front IP 54 IEC 529 DIN 40050  
Technical data look catalog 5/100  
Description data look catalog 5/002

Spindle block with schematic representation of the master controller installation and deflection directions. Version shown for Left-hand side installation (right-hand side installation is mirror image).

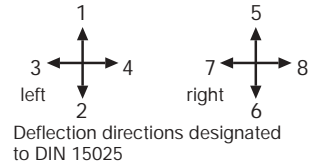

Pos.	V 31	V 3	Type	Weight gramm	Price EURO
1			V 31	940	
2					
3			V 3	1000	
4					
5					
10	Gate cross-shaped	(prohibits diagonal shifting)	P	100	
11	Gate special-shaped	(for e. H-gate)	P	110	
12	Spring return in 0-position	(for each direction)	Z	110	
13	Friktion brake	(for each direction)	R	50	
14					
20	Control-handle with knob solid		M	50	
21	Control-handle with latch for mechanical zero interlock		T	100	
22	Control-handle with dead man's button 1 NO		H	100	
23	Control-handle with signal button 1 NO		D	110	
24	Control-handle with push button 1 NO		DV	110	
25	Control-handle with flat push button 1 NO		B 1	40	
26	Control handle with palm grip B 1		B 1T	60	
27	Control handle with palm grip B 1 with push button top 1 NO				
28	Control handle long or short 200, 160 mm				
29	More knobs, grips and T-grips with and without signal devices look catalog 1/280...				
30	Masterswitch switching sequence 4-0-4	No. of contacts 2	01	290	
31		4	02	350	
32	Direction 1-2 and 3-4 each 1 masterswitch	6	03	410	
33	Switching program according contact-arrangement MS... look catalog 5/001	8	04	470	
34	or to your contact-arrangement	10	05	530	
35		12	06	590	
36	Switching sequence 5-0-5				
40	Potentiometer e.t.c. each masterswitch with mounted Wire-wound potentiometer T 130, with centre tap linear Life 10 <sup>7</sup> switching cycle resistance 2 x 0,5/1/2/5/10 kOhm, 1,5 Watt wiper current max. 10 mA		P	70	
41	Prepared for mounting potentiometer shaft 6 mm adjusting-angle 2 x 150°		(P)		
42	Prepared for mounting potentiometer e.t.c. adjusting-angle variable.		(P)		
43	more Potentiometer e.t.c. look catalog 1/240...				
50	Steel sheet housing B 200 masterswitch max. size 04		B	1300	
51	Steel sheet housing B 230 masterswitch max. size 06		B	1400	
52	More housing look catalog 1/250				
60	Indicating labels not engraved with 2 or 4 arrows				
61	Engraved each 10 characters				
62					
70	Command and indicating devices look catalog 1/260				



T = dead man's button  
H = signal button  
M = latch for mechanical zero interlock

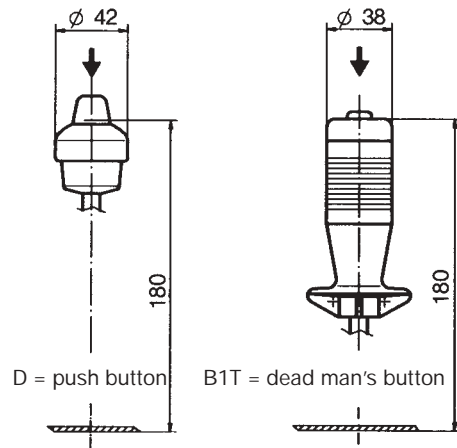
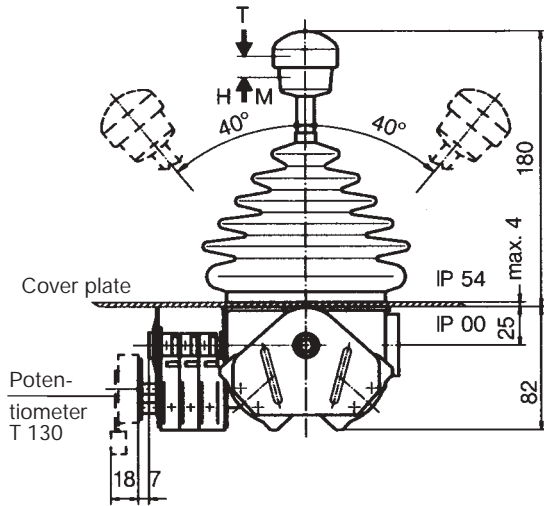

Type	No. of contacts	Dimension B
01	2	77
02	4	89
03	6	102
04	8	114
05	10	127
06	12	139

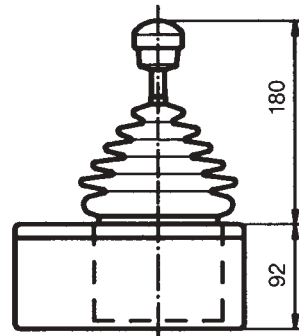
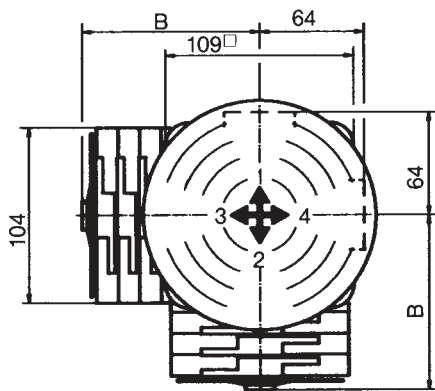

Steel sheet housing

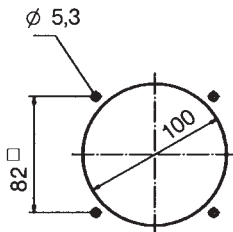

Hole pattern

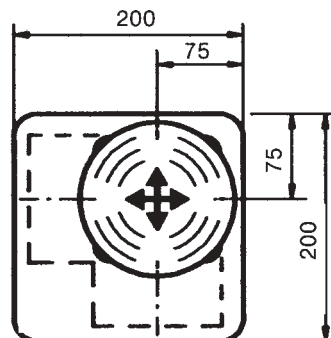

Example for type-sign

Steel sheet housing

Multi-axis controller

Gate

Dead man's button

Masterswitch direction 1-2

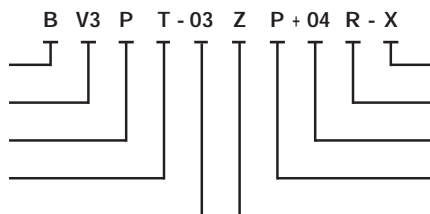

Special please to describe

Friction brake direction 3-4

Masterswitch direction 3-4

Potentiometer e.t.c. direction 1-2

Spring return direction 1-2