

Multi-axis controller V6 / VV6



The multi-axis controller V6 / VV6 is available in either single-axis or multi-axis options and is a robust controller used commonly in electro-hydraulic applications. The modular design and many possibilities of combination with our handles enables the switching device to be used universally. The V6 / VV6 is resistant to oil, maritime conditions e.g. offshore / vessels, UV radiation typically from the sun.

Technical data

Mechanical life V6	10 million operating cycles
Mechanical life VV6	20 million operating cycles
Operation temperature	-40°C til +60°C
Degree of protection	IP54 front



1

	V62L	S5	P	T	Example				
					- 01 Z P	+ 03A R C	- A05 P134	+ A110 C01	- X
Basic unit	[Shaded]								
V62L 2-axis left	[Shaded]								
Control-handle extended	[Shaded]								
S5 -20mm	[Shaded]								
Gate	[Shaded]								
P Cross gate	[Shaded]								
Grip / palm grip	[Shaded]								
T Dead man	[Shaded]								
Axis 1 (direction 1-2)	[Shaded]								
01 2 Contacts (2A 250V AC15)	[Shaded]								
Z Spring return	[Shaded]								
P Potentiometer	[Shaded]								
Axis 2 (direction 3-4)	[Shaded]								
03A 6 Contacts (4A 250V AC15)	[Shaded]								
R Friction brake	[Shaded]								
C Opto-electronical encoder	[Shaded]								
Description axis 1 (direction 1-2)	[Shaded]								
A05 Arrangement MS21	[Shaded]								
P134 Potentiometer T396 2x5kOhm	[Shaded]								
Description axis 2 (direction 3-4)	[Shaded]								
A110 Arrangement MS24-0	[Shaded]								
C01 OEC 2-1-1	[Shaded]								
Special model	[Shaded]								
X Special / customer-specific	[Shaded]								

Combination possibilities with our handles



V62L S5 P T - 01 Z P + 03A R C - A05 P134 + A110 C01 - X

Basic unit

- V61L 1-axis left
- V61R 1-axis right
- V61.1 1-axis
- V64.1 1-axis
- V62L 2-axis left
- V62R 2-axis right
- V64 2-axis

reinforced version

- VV61L 1-axis left
- VV61R 1-axis right
- VV61.1 1-axis
- VV64.1 1-axis
- VV62L 2-axis left
- VV62R 2-axis right
- VV64 2 axis

Control-handle extended*

Standard 180mm

- S3 -40mm
- S5 -20mm
- S8 +20mm

**Only available in combination with handle!*

Gate

- P Cross gate
- P X Special gate

Grip / palm grip

Knob (included in basic unit!)

- M Mechanical zero interlock
- MN Mechanical zero interlock (push down)
- T Dead man
- MT* Mechanical zero interlock + dead man
- H Signal button
- MH Mechanical zero interlock + signal button
- D Push button
- MD* Mechanical zero interlock + push button
- DV Flush push button
- MDV* Mechanical zero interlock + flush push button

**Only possible with VV6!*

B... Palm grip B... (see Palm grip page 129)

Attention! When using some handles reduces the deflection angle to 28 degrees!

Identification of the installation variants with switching directions:

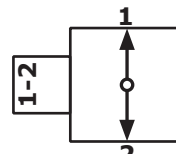

V61L/VV61L

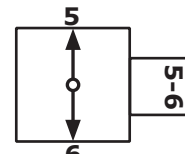

V61R/VV61R

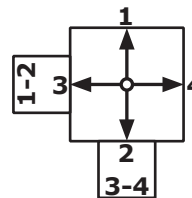

V62L/VV62L

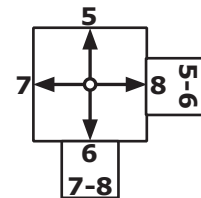

V62R/VV62R

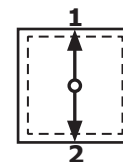

V64.1/VV64.1

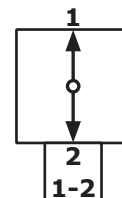

V61.1/VV61.1

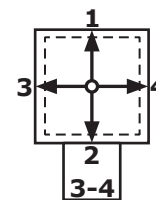

V64/VV64

V62L S5 P T - 01 Z P + 03A R C - A05 P134 + A110 C01 - X

Axis 1: direction 1-2 left / direction 5-6 right

(Standard contacts gold-plated 2A 250V AC15)

01	<input type="checkbox"/>	2 contacts	Standard contact - arrangement see page 112	
02	<input type="checkbox"/>	4 contacts	z.B.	
03	<input type="checkbox"/>	6 contacts	A980	MS00
04	<input type="checkbox"/>	8 contacts	A05	MS21
05	<input type="checkbox"/>	10 contacts	A0500	MS21-00
06	<input type="checkbox"/>	12 contacts	A110	MS24-0
		A = silver contacts (4A 250V AC15)	A99 contact - arrangement according customer request	

Z Spring return

R Friction brake

(P) Possibility of mounting potentiometer and encoder (Gessmann-types)

P	Potentiometer	P131	T396 2x0,5kOhm	I max. 1mA
		P132	T396 2x1kOhm	I max. 1mA
		P133	T396 2x2kOhm	I max. 1mA
		P134	T396 2x5kOhm	I max. 1mA
		P135	T396 2x10kOhm	I max. 1mA
		<i>More potentiometer on request!</i>		

C Encoder C... Encoder see page 119

If both axis identical, it's enough to describe one axis!

Beispiel A05P134 + A05P134 => A05P134

V62L S5 P T - 01 Z P + 03A R C - A05 P134 + A110 C01 - X

Axis 2: direction 3-4 left / Direction 7-8 right

(not applied for V/VV61, V/VV61.1, V/VV64.1)

(Standard contacts gold-plated 2A 250V AC15)

01	<input type="checkbox"/>	2 contacts	Standard contact - arrangement see page 112	
02	<input type="checkbox"/>	4 contacts	z.B.	
03	<input type="checkbox"/>	6 contacts	A980	MS00
04	<input type="checkbox"/>	8 contacts	A05	MS21
05	<input type="checkbox"/>	10 contacts	A0500	MS21-00
06	<input type="checkbox"/>	12 contacts	A110	MS24-0
		A = Silver contacts (4A 250V AC15)	A99 contact - arrangement according customer request	

Z Spring return

R Friction brake

(P) Possibility of mounting potentiometer and encoder (Gessmann-types)

P	Potentiometer	P131	T396 2x0,5kOhm	I max. 1mA
		P132	T396 2x1kOhm	I max. 1mA
		P133	T396 2x2kOhm	I max. 1mA
		P134	T396 2x5kOhm	I max. 1mA
		P135	T396 2x10kOhm	I max. 1mA
		<i>More potentiometer on request!</i>		

C Encoder C... Encoder see page 119



V62L S5 P T - 01 Z P + 03A R C - A05 P134 + A110 C01 - X

Special model

X Special / customer-specific

Attachments

Indicating labels

Indicating labels with engraving

1

Multi-axis controller

V6 / VV6

T = Dead man's button
 H = Signal button
 M = Latch for mechanical zero interlock

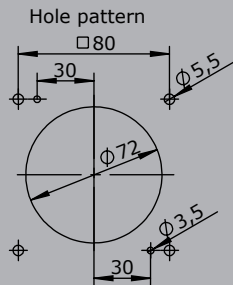
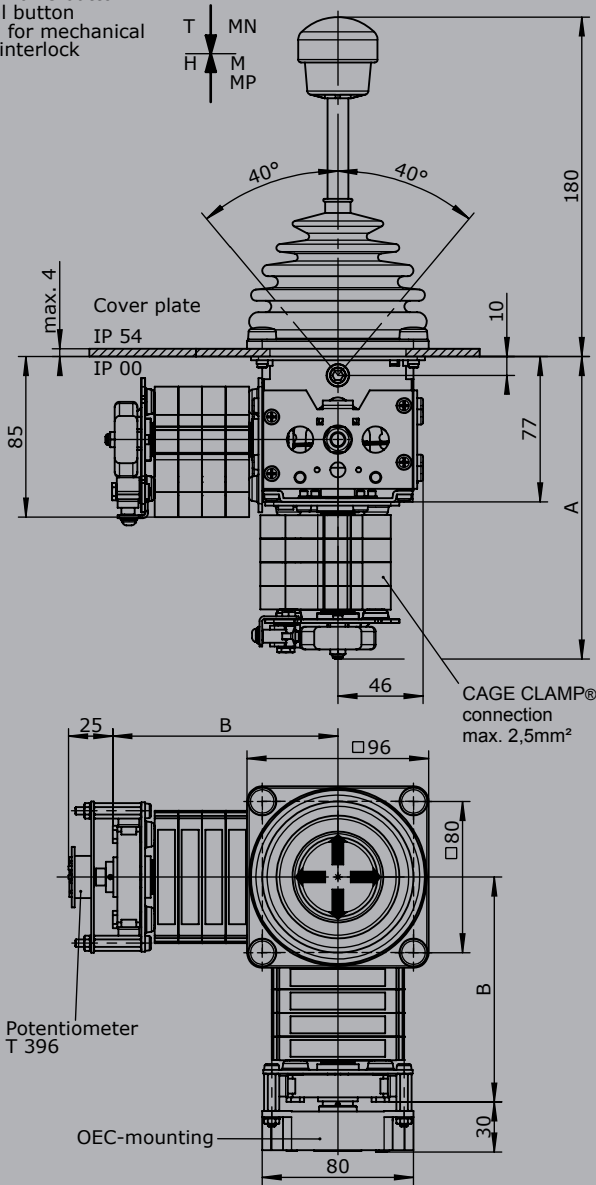

Knob solid
 D= Push button

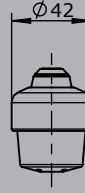

Palm grip B3

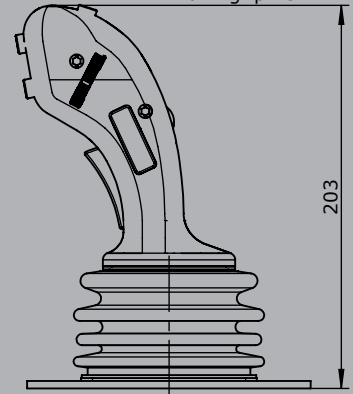

$\phi 38$ Palm grip B1
 B1 T= Dead man's button

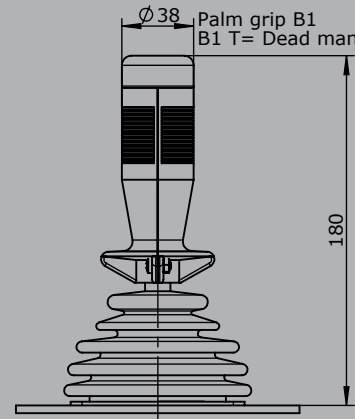

Palm grip B5

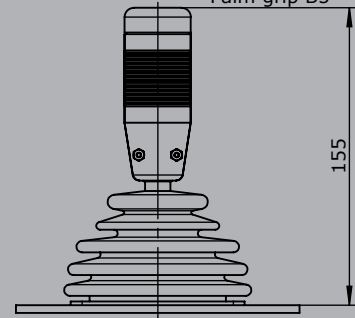

Type	No. of contacts	Dim. A	Dim. B
01	2	119	82
02	4	131	94
03	6	144	107
04	8	156	119
05	10	169	132
06	12	181	144