

## Built for fingertip precision

The Caldaro C03B are made for customers who requires precision and quality.

All components, rubber cover, shaft, electronics, etc, are designed to last and work in perfect harmony.

### Features

- Very small-sized, joystick controller for industrial use, which accomplished long life-expectancy, high reliability, and robustness.
- This model can be assembled from both above and under the panel.
- Possible to be integrated in our Viper and Cobra grips.
- 3 types of knobs are available. One of them with an integrated distinct push button.

Other knob design on request



With A type knob

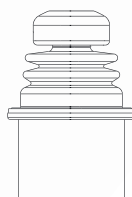

With B type knob

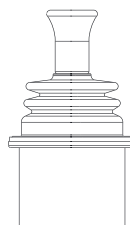

With push button type knob

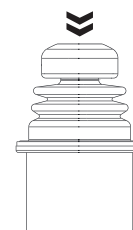

# » C03B

## Standard dimensions

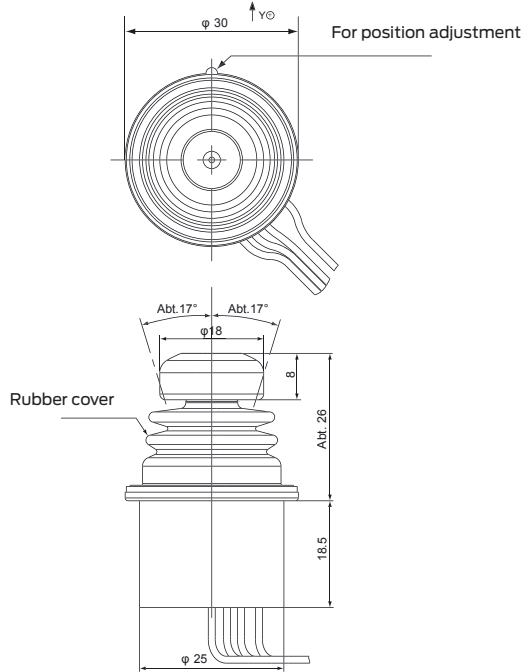

## Panel arrangement

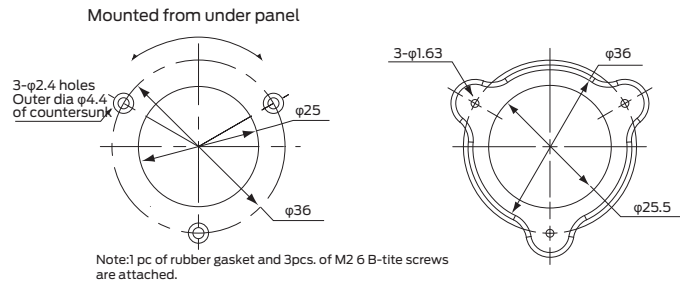

## Output characteristics

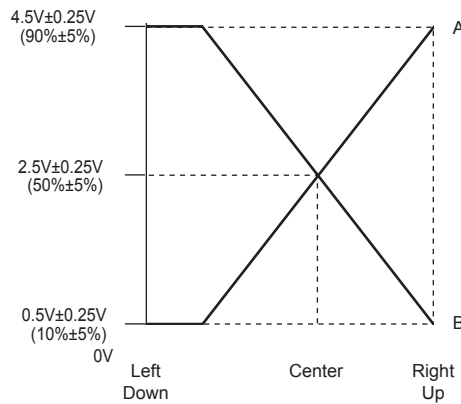

## » Output options

### Single output

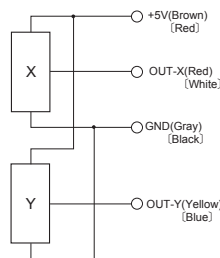

### Parallel output Cross output

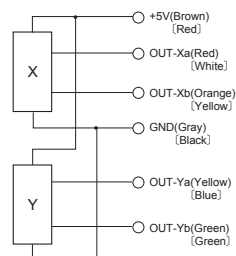

## » Specifications

### Electrical specifications

Applied voltage	D. C. 5V ±10%
Effective output	0.5V~4.5V
Electrical rotating angle	X&Y directions: Approx. ±17° (Approx. 34°)
Independent linearity tolerance	±3%FS
Load resistance	Over 10kΩ
Dielectric strength	1 minute at A. C. 500V
Insulation resistance	Over 1,000MΩ at D. C. 500V
EMS durability	100V/m (80MHz~1GHz 1kHz sine-wave 80%AM modulation)
ESD durability	±8kV contact ±15kV aerial discharge (Based on IEC61000-4-2)

### Mechanical specifications

Controlling range of operating lever	Omni-directionally approx. ±17° from center position
Operating force	Spring return device (Automatically return to center) X&Y directions: Approx. 1N 2.5N
Operating temperature range	Operating temperature range -20°C~60°C
Vibration	10Hz~55Hz 98m/s <sup>2</sup>
Shock	294m/s <sup>2</sup>
Mechanical life expectancy	Approx. 2,000,000 operations
Mass	Single output type: Approx. 22g Dual output type: Approx. 24g