

DIN CONNECTORS GERMAN STANDARD DIN 41617

SPECIFICATIONS

Current Rating:	5 A
Contact Material:	Copper Alloy
Contact Plating:	Silver or Gold
Insulator Material:	Polycarbonate, UL 94 V-0
Operating Voltage:	250 VAC
Contact Resistance:	5 mΩ
Insulation Resistance:	10 ¹² Ω
Temperature Rating:	-55 °C to 120 °C

FEATURES

- The male and female double-row connectors according to DIN 41617 are designed for PCB-mounting.
- They are used with PCB layout of 2.5 mm.
- In case of through-plated PCB-holes they can be used in double and multilayer holes.
- Even the 90.8 mm overall length of the 31-way male connector leaves ample space for guiding of the Europakarte.

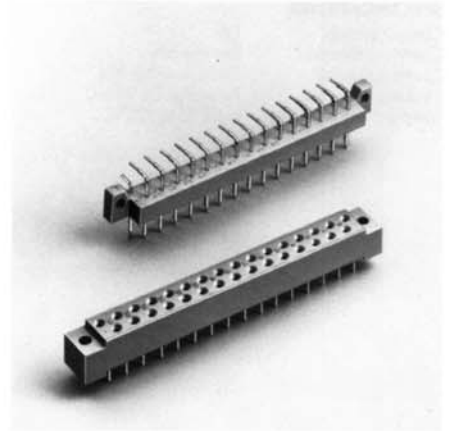

Male connector

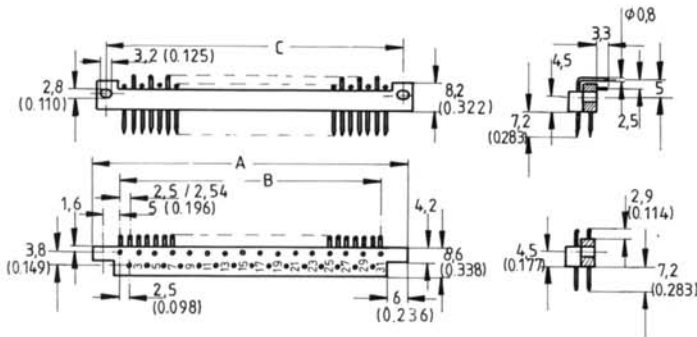

Female connector

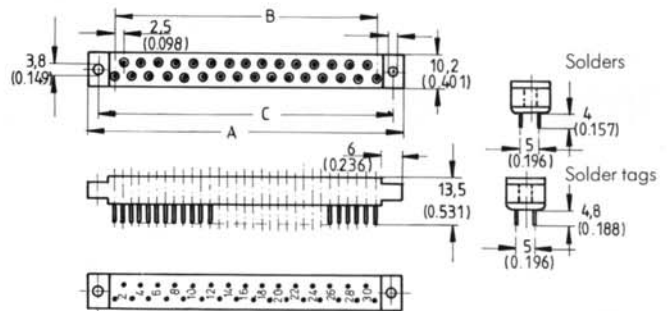

DIMENSIONS

Series	No. of contacts	A	B	C
IDIN 17 M	13	45.8	30	40
IDIN 17 M	21	65.8	50	60
IDIN 17 M	31	90.8	75	85

Series	No. of contacts	A	B	C
IDIN 17 F	13	45.8	30	40
IDIN 17 F	21	65.8	50	60
IDIN 17 F	31	90.8	75	85

ORDERING INFORMATION

Follow the sequence listed below to select the desired part number.

Example: IDIN 17 M 31-A-S is a DIN connector with 31 contacts, angled pins, silver plated.

Series	No. of contacts	Terminal Applications	Contact plating	Series	No. of contacts	Contact Application	Contact plating
IDIN 17 M	31	A	S	IDIN 17 F	31	ST	S
IDIN 17 M	13	A	S	IDIN 17 F	13	ST	S
Male connector	21	Angled	Silver	Female connector	21	Solder tags	Silver
	31	SP	G		31	SP	G
		Solder pin straight	Gold			Solder pin	Gold