

PCB-EDGE-ON CONNECTORS (SLOT)

2x18 to 2x43 contacts

SPECIFICATIONS

Current Rating: 3 A
 Contact Material: Bronze Alloy
 Contact Plating: Selected Gold over Nickel
 Insulator Material: Polyester, UL 94 V-0
 Temperature Rating: -65° to 120°C

FEATURES

- Grid mating face: 2.54 mm
- Double side contacts
- The connectors accept, on the mating side, all P.C. boards from 1.4 to 1.8 mm thickness

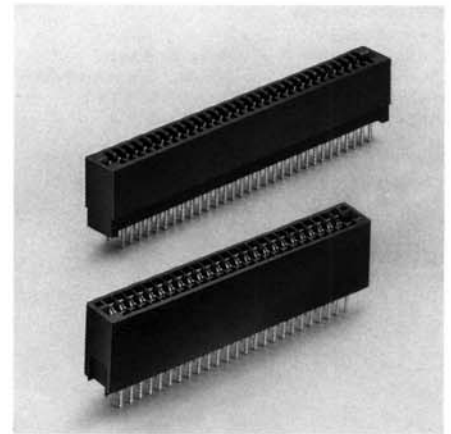

With mounting ears on request

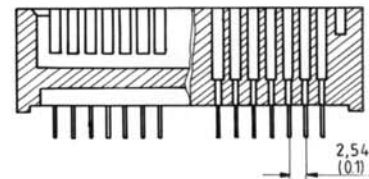
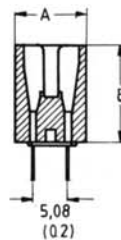
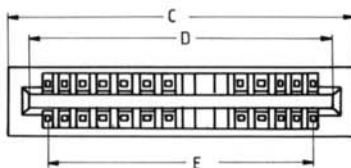

DIMENSIONS

Series	No. of contacts		A	B	C	D	E
ISL	2x18	18/36	9.5	14.0	52.2	48.2	43.2
ISL	2x22	22/44	9.5	14.0	62.3	58.3	53.3
ISL	2x23	23/46	9.5	14.0	64.9	60.9	55.9
ISL	2x25	25/50	9.5	14.0	70.0	66.0	61.0
ISL	2x31	31/62	9.5	14.0	85.2	81.2	76.2
ISL	2x43	43/86	9.5	14.0	121.8	114.0	106.7

ORDERING INFORMATION

Follow the sequence listed below to select the desired part number.

Example: ISL 2x22-G is a slot connector with 2x22 contacts, gold plated.

