

# PIN HEADER STRIPS SINGLE ROW

8 to 40 contacts

## SPECIFICATIONS

Current Rating: 3 A  
 Contact Material: Brass  
 Contact Plating: – Gold over Nickel  
 – Tin over Nickel  
 Insulator Material: Polyester, UL 94 V-0  
 Temperature Rating: –65° to 150°C

## FEATURES

- Grid pattern, 2.54 mm small case pitch
- Include notches to facilitate breaking into custom lengths
- Single Row-Straight Pins
- Single Row-Right Angle Pins

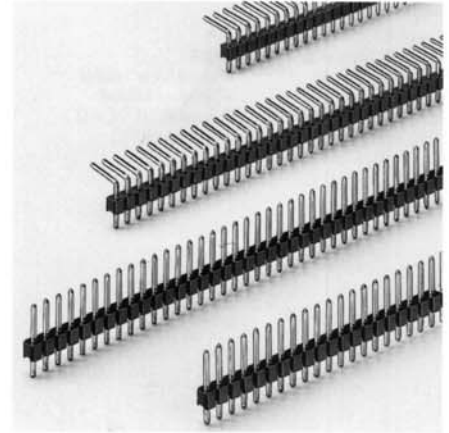

Single Row-Straight Pins

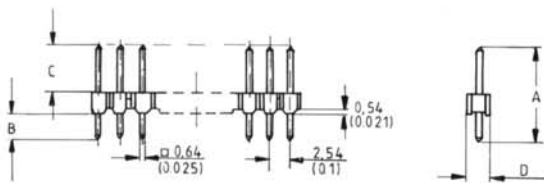

Single Row-Right Angle Pins

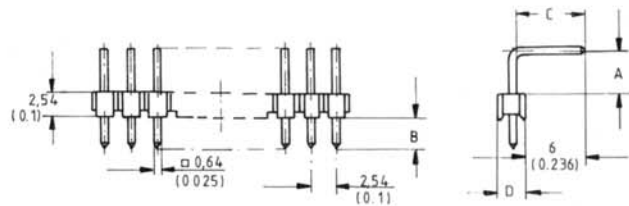

## DIMENSIONS

Series	A	B	C	D
IPHS...S-9	9.20	4.12	2.54	2.54
IPHS...S-11	11.50	3.20	5.76	2.54
IPHS...S-12	12.40	5.84	4.02	2.54

Series	A	B	C	D
IPHS...RA-2	2.60	3.00	7.00	2.54

## ORDERING INFORMATION

Follow the sequence listed below to select the desired part number.

Example: IPHS 40-S-11-G is a pin header single row with 40 contacts 11.50mm, straight pins, gold plated.

Series	No. of contacts	Terminal versions	Pin length	Contact plating	Series	No. of contacts	Terminal versions	Dimension A	Contact plating
<b>IPHS</b>	<b>40</b>	<b>S</b>	<b>11</b>	<b>G</b>	<b>IPHS</b>	<b>40</b>	<b>RA</b>	<b>2</b>	<b>G</b>
IPHS	8 24	S	9	G	IPHS	8 24	RA	2	G
Single row	10 26	Straight pin	9.20mm	Gold	Single row	10 26	Right angle pin	2.60mm	Gold
	14 30		11	T		14 30			T
	16 36		11.50mm	Tin		16 36			
	20 40		Standard			20 40			
			12						
			12.40mm						