

IDC SOCKET CONNECTORS

DIN 41651 2,54 x 2,54 mm (0.100" x 0.100")

10 to 64 contacts

SPECIFICATIONS

Current Rating: 1 A
 Dielectric Strength: 1,000 V
 Contact Material: Phosphor Bronze
 Contact Plating: Gold
 Insulator Material: Polyester, UL 94 V-0

FEATURES

- Provide fast, easy assembly to flat cable AWG 28.
- Positive electrical contact with cable via dual beam contacts
- Compatible with headers of most other major manufacturers.
- Dual polarizing slots.
- Optional pressure relief bow has same narrow profile as body.
- Conforms to MIL-C-83503.
- Assembly tools available.

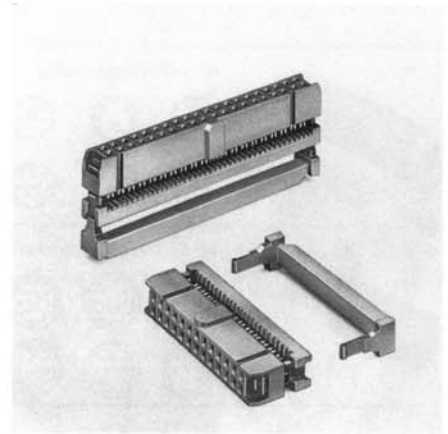

DIN 41651
Flat cable AWG 28 page 67

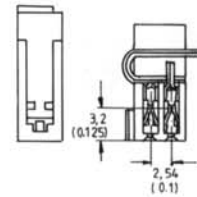
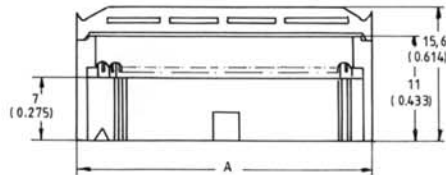
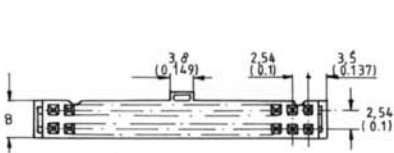

DIMENSIONS

Series	No. of contacts	A	B
IDCS	10	17.3 (.68)	6.1 (.24)
IDCS	14	22.4 (.88)	6.1 (.24)
IDCS	16	24.9 (.98)	6.1 (.24)
IDCS	20	30.0 (1.18)	6.1 (.24)
IDCS	26	37.6 (1.48)	6.1 (.24)
IDCS	30	43.4 (1.70)	6.1 (.24)

Series	No. of contacts	A	B
IDCS	34	47.8 (1.88)	6.1 (.24)
IDCS	40	55.4 (2.18)	6.1 (.24)
IDCS	50	68.1 (2.68)	6.1 (.24)
IDCS	60	80.8 (3.18)	6.1 (.24)
IDCS	64	86.2 (3.39)	6.1 (.24)

ORDERING INFORMATION

Follow the sequence listed below to select the desired part number.

Example: IDCS 26-G-1 is a socket connector with 26 contacts, gold plated, without strain relief.

Series IDCS	No. of contacts 26	Contact plating G	Strain relief 0
IDC socket	10 34 14 40 16 50 20 60 26 64 30	G Gold	0 None

Series IDCS	No. of contacts SR	for no. of contacts 34
strain relief	10 34 14 40 16 50 20 60 26 64 30	