

GP 1272

12V 7.2Ah

GP 1272 is a general purpose battery with 3-5 years in standby service or more than 260 cycles at 100% discharge in cycle service. As with all CSB batteries, all are rechargeable, highly efficient, maintenance free, leak proof, useable in any position and ISO certified as well as recognized by UL.

Specification

Cells per unit	6
Voltage per unit	13.05
Capacity	7.2Ah@20hr-rate to 1.75V per cell@25°C(77°F)
Weight	Approx 2.58kg(5.67 lbs)
Maximum Discharge Current	100A/130A(5sec)
Internal Resistance Approx.	Approx 25mΩ
Operating Temperature Range	Discharge: -15°C~50°C(5°F~122°F) Charge: 5°C~35°C(41°F~95°F) Storage:0°C~40°C(32°F~104°F)
Nominal Operating Temperature Range	25°C ± 3°C(77°F ± 5°F)
Float Charging Voltage	13.5 to 13.8 VDC/unit Average at 25°C (77°F)
Recommended Maximum Charging Current Limit	2.16A
Equalization and Cycle Service	14.4 to 15.0 VDC/unit Average at 25°C(77°F)
Self Discharge	CSB Batteries can be stored for more than 6 months at 25°C(77°F) Please charge batteries before using. For higher temperatures the time interval will be shorter.
Terminal	Faston Tab 187/250
Container Material	-ABS (General grade & 94V-2 flame retardant case)

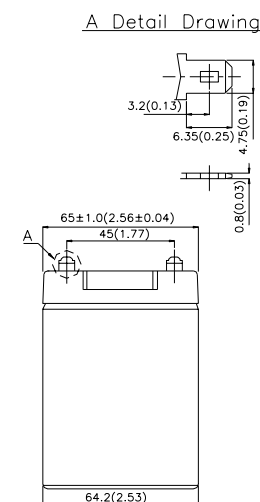
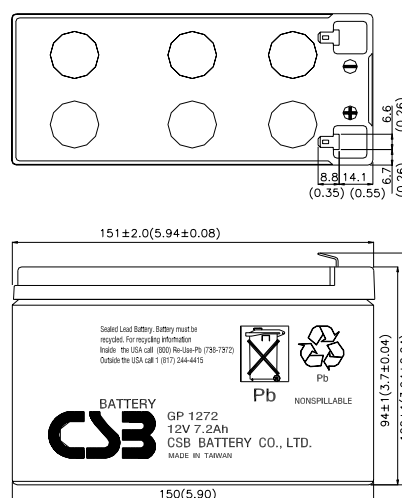
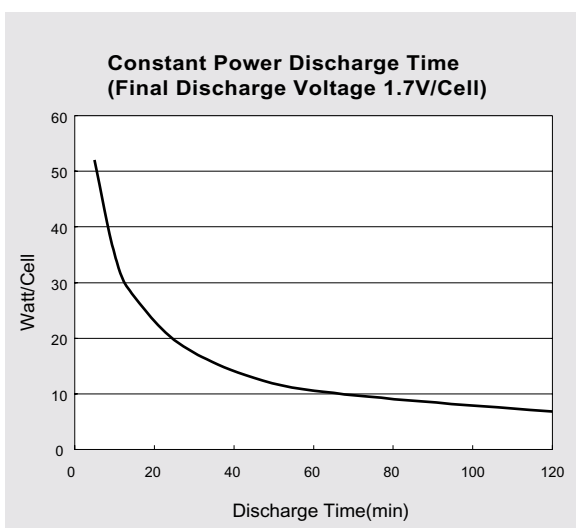

Constant Power Discharge Characteristics Unit: Watts (25°C, 77°F)

F.V/Time	5MIN	10MIN	15MIN	30MIN	60MIN	2HR	3HR	4HR	5HR	8HR	10HR	20HR
9.6V	343	223	171	105	63.4	36.6	26.2	20.7	17.0	11.2	9.10	4.74
10.2V	312	211	165	104	63.1	36.3	26.0	20.6	16.9	11.1	8.99	4.57
10.8V	270	192	154	101	62.6	36.0	25.8	20.5	16.8	10.9	8.75	4.31

Constant Current Discharge Characteristics Unit: A (25°C, 77°F)

F.V/Time	5MIN	10MIN	15MIN	30MIN	60MIN	2HR	3HR	4HR	5HR	8HR	10HR	20HR
9.6V	28.6	18.6	14.3	8.75	5.28	3.06	2.18	1.72	1.42	0.935	0.758	0.395
10.2V	26.0	17.6	13.8	8.67	5.26	3.05	2.17	1.71	1.41	0.930	0.749	0.381
10.8V	22.5	16.0	12.8	8.42	5.22	3.03	2.15	1.70	1.40	0.924	0.729	0.359