

## ●Standard Dimensions

## ●With lug terminals

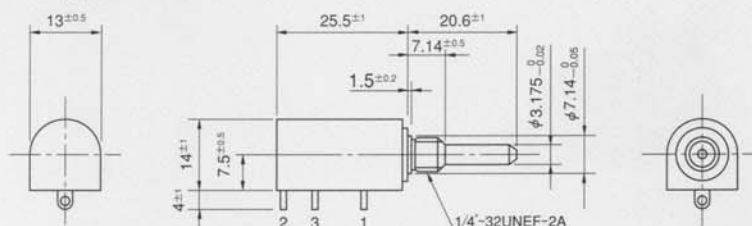

## ●With pin terminals for p.c. board

## Terminal Holes Layout

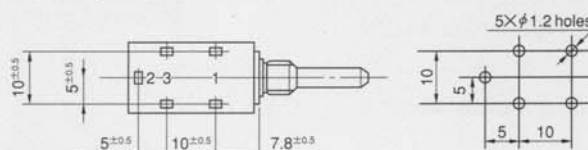

## ●With rear lug terminals

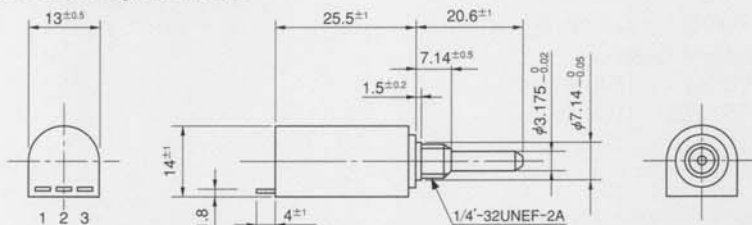

- Note: 1. 1 pc. each inner teeth washer and hex nut are attached.  
2. Outer dimensions of 5-turn version are same as those of 10-turn.  
3. Please process the mounting hole on the panel to be mounted with this potentiometer by the diameter of  $7.14\text{mm}^{+0.05}_0$ .

## ●Standard Model Nos.

## Bushingmount type:

With lug terminals:

12HPC-5E (5-turn)

12HPC-10E (10-turn)

With pin terminals for p.c. board:

12HPC-5EP (5-turn)

12HPC-10EP (10-turn)

With rear lug terminals:

12HPC-5EW (5-turn)

12HPC-10EW (10-turn)

## ●General Specifications

## Standard Resistance

Range: 100Ω to 50kΩ (5-turn)  
100Ω to 100kΩ (10-turn)

## Total Resistance

Tolerance: Standard Class  $\pm 3\%$  (H)  
Precision Class  $\pm 1\%$  (F)

## Independent Linearity

Tolerance: 5-turn 10-turn  
Standard Class  $\pm 0.35\%$   $\pm 0.25\%$   
Precision Class  $\pm 0.2\%$   $\pm 0.1\%$   
(Below 5kΩ) ( $\pm 0.25\%$ ) ( $\pm 0.15\%$ )

## Power Rating:

0.75W (5-turn)

1.5W (10-turn)

## Noise:

Below 100Ω E.N.R.

## Electrical Travel:

 $360^\circ \times n \pm 5^\circ$  (n: No. of turns)

## Mechanical Travel:

 $360^\circ \times n \pm 15^\circ_0$  (n: No. of turns)

Insulation Resistance: Over 1,000MΩ at 500V.D.C.

Dielectric Strength: 1 minute at 1,000V.A.C.

Starting Torque: Below 3mN·m (30gf·cm)

Stopper Strength: Approx. 0.15N·m (1.5kgf·cm)

Max. Torque exerted on fastening the mounting nut to the bushing:

Below 0.8N·m (8kgf·cm)

Max. Working Voltage: 450V

Resist. Temperature

Coefficient of Wire:  $\pm 20\text{p.p.m./}^\circ\text{C}$ 

Mass:

Approx. 10g

(Both 5-turn and 10-turn)

## ●Standard Resistance Values ■No. of Wire Turns ■Resistance Wire Used

Resist. Value (Ω)	100	200	500	1k	2k	5k	10k	20k	50k	100k
12HPC-5E	920	1,190	1,250	1,510	1,790	2,380	3,120	3,800	5,430	—
12HPC-10E	1,690	1,850	2,560	2,500	3,030	4,170	4,760	6,250	8,330	10,870
Resist. Wire Used	Cu-Ni System					Ni-Cr System				

## ●Special Specifications Available

3-turn type (S12HPC-3E), Lower resistance values (20Ω, 50Ω), Shaft with front and rear extension (Rear shaft with 0.8mm dia. and 10mm length), Special machining on the shaft, Simple sealed housing.