

BOURNS®

Features

- Available sharp click feel with a positive tactile feedback
- Ultra-miniature and lightweight structure suitable for high density mounting
- Economical with high reliability

Applications

- Electronic toys
- Radios
- Stereos
- Remote controls

SDT Series Tact Switch

Electrical Characteristics

Electrical Life

O. Force R100,000 cycles min.
 O. Force K+N500,000 cycles min.
 RatingDC 12V 50 mA
 Contact Resistance100 milliohms max.
 Insulation Resistance
100 megohms, DC 500V min.
 Dielectric Strength250V AC for 1 minute
 Contact Arrangement1 pole 1 position

Environmental Characteristics

Mechanical Lifetime100,000 cycles min.
 Operation Force260g ±50g,
 160g ±50g, 100g ±50g
 Stop Strength.....Place the switch such
 that vertical, a static load of 3kg shall
 be applied in the direction of actuator
 operation for a period of 15 sec.
 Stroke
 6mm type0.25 + 0.2/- 0.1mm
 12mm type0.35 ± 0.1mm
 Temperature Range-20°C to +70°C
 Vibration Test.....Mil-STD-202F,
 Method 201A
 Frequency10-55-10 Hz/1 minute
 DirectionsX,Y,Z, three mutually
 perpendicular directions
 Time.....2 hours each direction.
 High reliability
 Shock TestMIL-STD-202F,
 Method 213B, Condition A
 Gravity50G (peak value), 11 msec
 Direction & Times.....6 sides and
 3 times in each direction.
 High reliability

Physical Characteristics

Cover Materials
Steel tin plated, 100µ min.
 Base MaterialsUL94V-0 PBT plus glass
 fiber reinforced
 Cover/Base Color.....Black
 Actuator MaterialsDulacron POM
 plus glass fiber reinforced
 Actuator ColorBlack, brown, red
 Contact Disc MaterialsPhosphor bronze
 with silver cladding
 Terminal Materials
Brass with silver cladding
 Wave Soldering Process
Recommended solder temperature
 at 260°C (500°F) max., 5 seconds
 Hand Soldering Process
Use a soldering iron of 30 watts
 or less, controlled at 320°C (608°F)
 for approximately 2 seconds while
 applying solder
 Packaging1,000 pieces per bag

Product Dimensions

SDTX-610/620/630/650/660

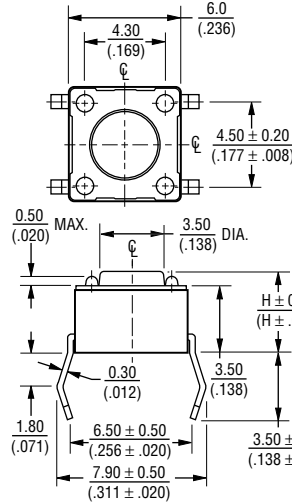

SDTG-610/620/630/650/660

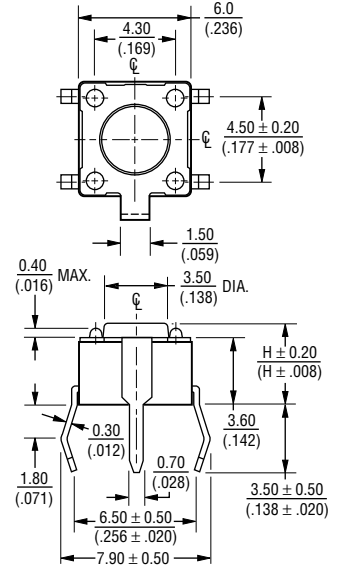

SDTX-644/648

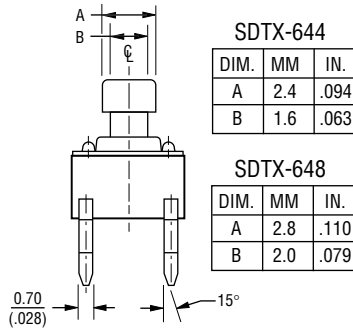

SDTG-644/648

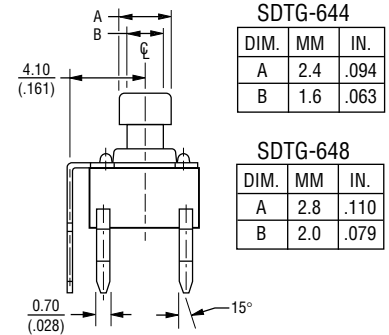

RECOMMENDED PCB LAYOUT

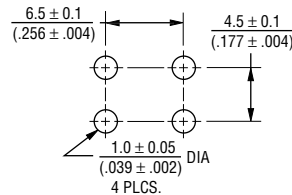

CIRCUIT DIAGRAM

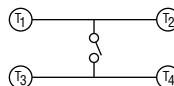

DIMENSIONS: MM (IN)

CIRCUIT DIAGRAM

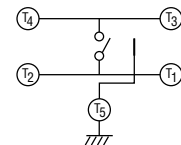

RECOMMENDED PCB LAYOUT

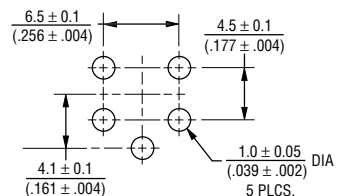

Additional Features

- Insert molding in the contact with special treatment prevents flux buildup during soldering and permits autodipping

SDT Series Tact Switch

BOURNS®

Product Dimensions

SDTA-610/620/630/650/660

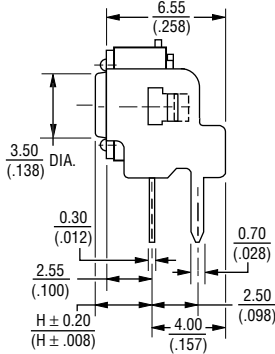
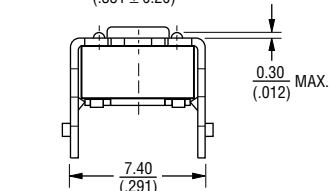
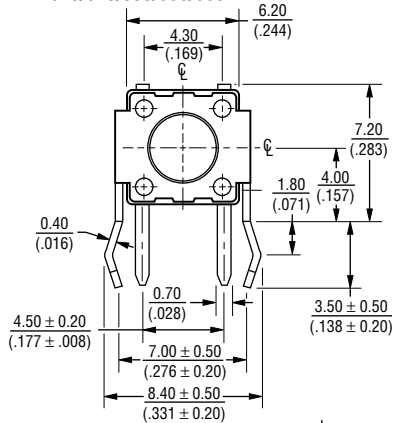

RECOMMENDED PCB LAYOUT

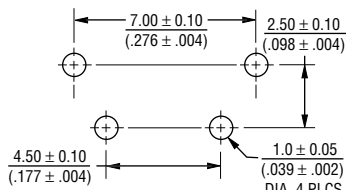

CIRCUIT DIAGRAM

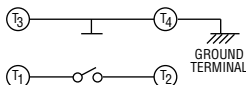

SDTA-644/648

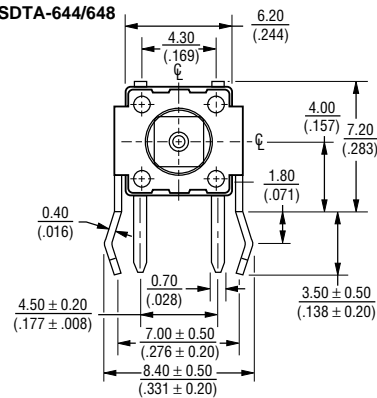

SDTA-644

DIM.	MM	IN.
A	2.4	.094
B	1.6	.063

SDTA-648

DIM.	MM	IN.
A	2.8	.110
B	2.0	.079

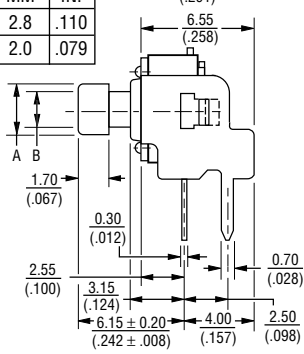
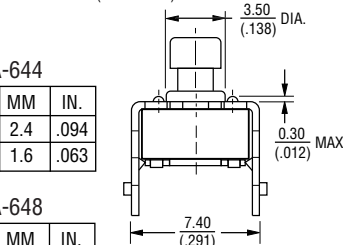

RECOMMENDED PCB LAYOUT

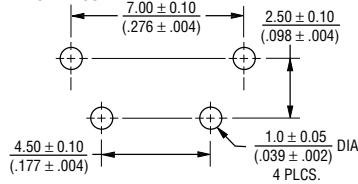

CIRCUIT DIAGRAM

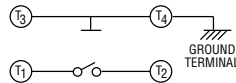

SDTU Series

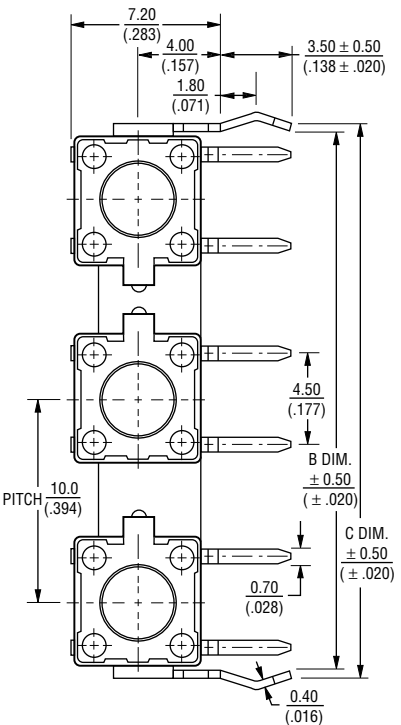
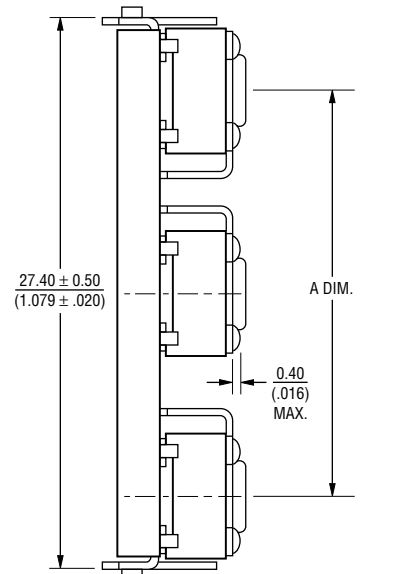

SDT Series Tact Switch

BOURNS®

Product Dimensions

SDTU Series (Continued)

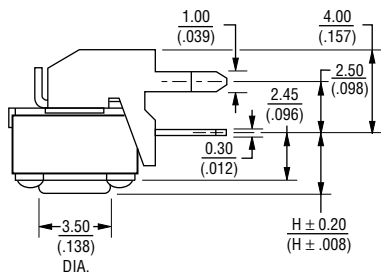

RECOMMENDED PCB LAYOUT

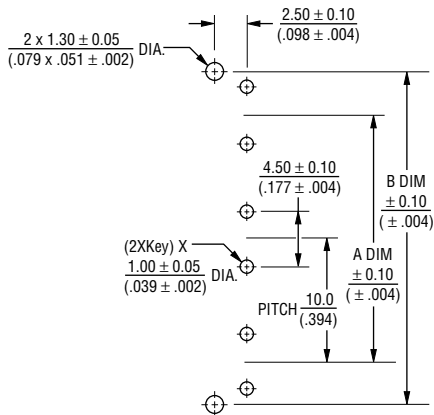

CIRCUIT DIAGRAM

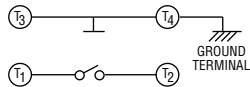

DIM.	3 KEYS (-11)	4 KEYS (-12)	6 KEYS (-13)
A	$\frac{20}{(.787)}$	$\frac{30}{(1.181)}$	$\frac{50}{(1.969)}$
B	$\frac{27}{(1.063)}$	$\frac{37}{(1.457)}$	$\frac{57}{(2.244)}$
C	$\frac{28.4}{(1.118)}$	$\frac{38.4}{(1.512)}$	$\frac{58.4}{(2.299)}$

SDTX-210

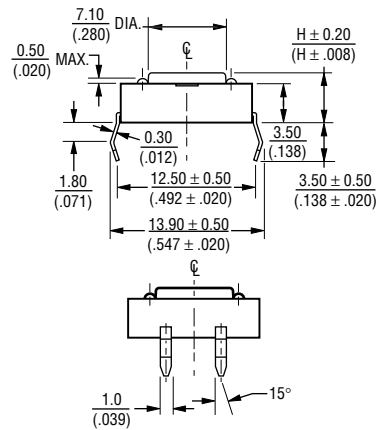
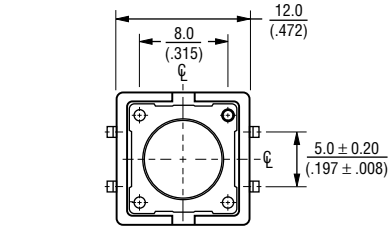

RECOMMENDED PCB LAYOUT

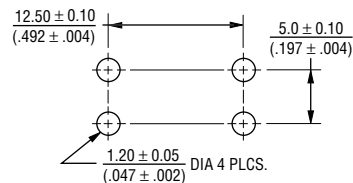

CIRCUIT DIAGRAM

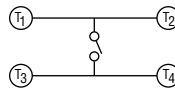

SDTX-244

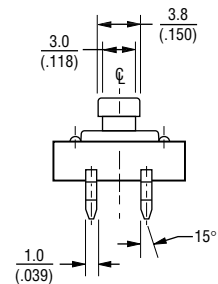
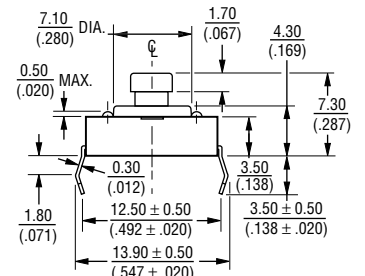
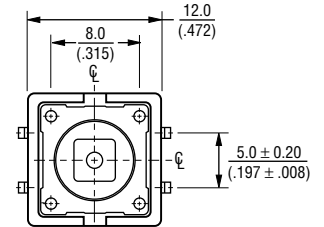

RECOMMENDED PCB LAYOUT

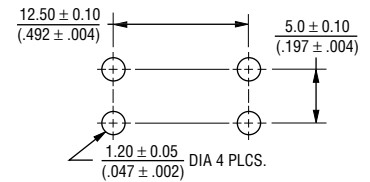

CIRCUIT DIAGRAM

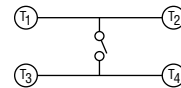

SDT Series Tact Switch

BOURNS®

Packaging Specifications

SDTX-610/620/630/644/648/650 Ammo Pack

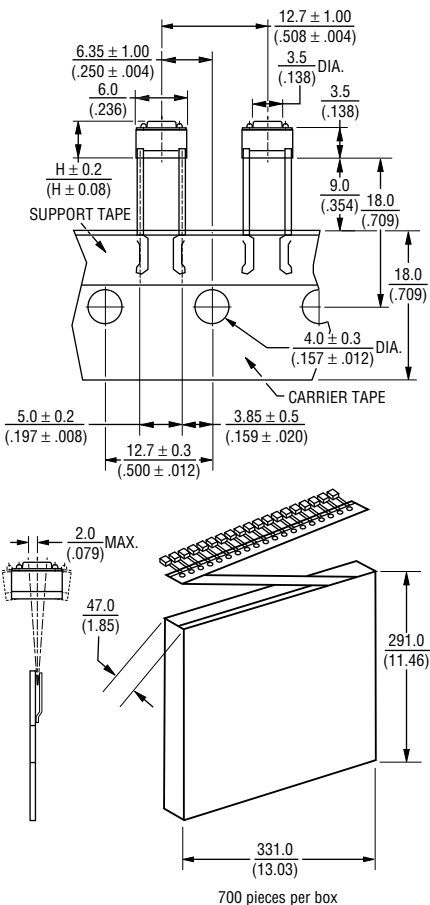

RECOMMENDED PCB LAYOUT

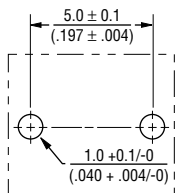

CIRCUIT DIAGRAM

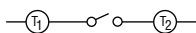

How to Order

SDT G - 6 10 - K 2 1

