

Carbon Composition Potentiometers



Model 185



Model 186

FEATURES

- 185: Panel Mount, Metal Shaft, 1, 2 or 4 Sections
- 186: Vertical or Horizontal PC Mount, Plastic Shaft, 1 Section
- Carbon Composition Element
- Economical Consumer Grade
- Compact 9mm Package

| ELECTRICAL SPECIFICATIONS | | |
|---|--|--|
| PARAMETER | MODEL 185 | MODEL 186 |
| Resistance Range Linear | 500Ω to 2.0MΩ | 500Ω to 2.0MΩ |
| Resistance Range Non-Linear | 1.0KΩ to 1.0MΩ | 1.0KΩ to 1.0MΩ |
| Resistance Tolerance | ± 20% Standard | ± 20% Standard |
| Linearity (Through 100KΩ) | ± 5% Independent | ± 5% Independent |
| Power Rating: Bushing Mount (Linear Taper) Bushing Mount (Non-Linear Taper) | 0.05 watt @ 40°C 0.025 watt @ 40°C | Bushing Mount not available Bushing Mount not available |
| PC Mount | 0.025 watt @ 40°C Derate to 0 @ 100 | |
| Minimum Resistance | 20Ω maximum Each End-Linear 20Ω maximum Low End 1% High End Non Linear | |
| Max. Count. Working Voltage | 50VAC | 50VAC |
| Dynamic Noise (CRV) | <47mV | <47mV |

| ORDERING INFORMATION | | | | | | | | | |
|---|--|---|----------------------|--|---|---|--|---|--------------------------------|
| Model 185 | | | | | | | | | |
| 185 | S | X | 4 | P | 25 | F | 102 | S | P |
| MODEL | NUMBER OF SECTIONS | MECHANICAL CONFIGURATION | LOCATING PIN | BUSHING SIZE SHAFT DIAMETER | SHAFT LENGTHS CODES | SHAFT STYLE | RESISTANCE CODES | TAPER | TERMINAL |
| 185 | S: Single D: Dual Q: Quad | X: Standard D: Centre Detent | 4: @ 6o,clock | Metal shaft: 6mm dia Q: M7 x 0.75 thrd, 7mm lg P: M7 x 0.75 thrd, 5mm lg | L (F) 15 (7) 20 (12) 25 (12) 30 (12) 35 (12) | S: Slotted F: Flatted K: Knurled | 500 1K 2.5K 5K 10K 25K 50K 100K 250K 500K 1MΩ 2MΩ | S: Linear ± 20% Z: CW Log ± 20% R: CCW Log, ± 20% Resistance values above 1MΩ are ± 30% | P: PC terms 3.5mm lg |
| Example: 185 - S - X - 4 - P - 25 - F - 102 - S - P | | | | | | | | | |

| ORDERING INFORMATION | | | | | | | | | |
|---|--------------------|--------------------------|-----------------------|--|--|---|--|---|--|
| Model 186 | | | | | | | | | |
| 186 | S | X | 4 | P | 25 | F | 102 | S | P |
| MODEL | NUMBER OF SECTIONS | MECHANICAL CONFIGURATION | LOCATING PIN | BUSHING SIZE SHAFT DIAMETER CODES | SHAFT LENGTHS | SHAFT STYLE | RESISTANCE CODES | TAPER | TERMINAL |
| 186 | S: Single | | X: No Loc. Pin | Plastic shaft: 6mm dia X: No Bushing | *15 (6) 20 (7) 25 (12) 30 (12) ** 35 | S: Slotted F: Flatted K: Knurled | 500 1K 2.5K 5K 10K 25K 50K 100K 250K 500K 1MΩ 2MΩ | S: Linear ± 20% Z: CW Log ± 20% R: CCW Log, ± 20% Resistance values above 1MΩ are ± 30% | Type B L: 6.5mm M: 10mm N: 12.5mm Type C Q: Vertical -Mount |
| Example: 186 - S - X - 4 - P - 25 - F - 102 - S - P | | | | | | | | | |

Model 185, 186

Spectrol

Carbon Composition Potentiometers

DIMENSIONS in millimeters

MODEL 185

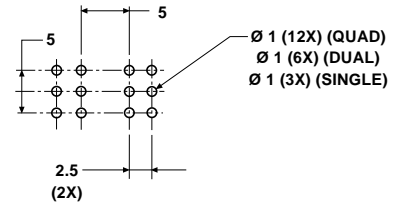
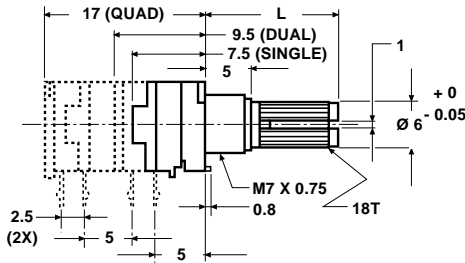
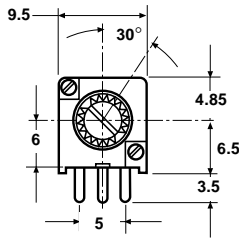

MODEL 186 TYPE C

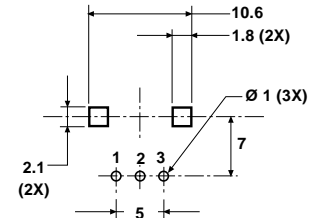
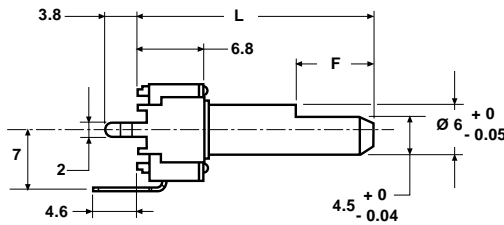
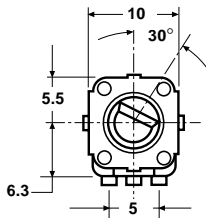

MODEL 186 TYPE B

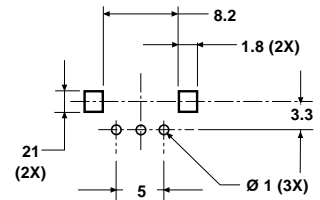
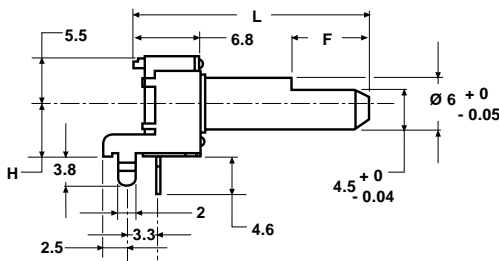
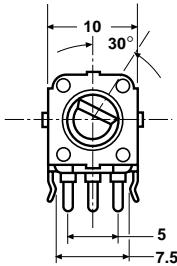

MECHANICAL SPECIFICATIONS

| PARAMETER | 185 | 186 |
|---------------------------|----------------------------|--------------------------|
| Materials of Construction | | |
| Shaft | Metal | Plastic |
| Bushing | Metal | None |
| Body | Plastic (Green) | - |
| Construction | | |
| Mounting | Bushing or PC | PC |
| Locating Pin | @ 6 o'clock | No locating Pin |
| Terminals | Not sealed for washing | |
| | Number - 3 in line | |
| | Strength - 2lb Push & Pull | |
| Mechanical Rotation | 300° ± 5° | 280° ± 5° |
| Operating Torque | 0.2 to 2.5 oz - in @ 25C | 0.15 to 2.0 oz - in @ 25 |
| Stop Torque (185/186) | 3 in - lbs | |

ENVIRONMENTAL SPECIFICATIONS

| | |
|-----------------------|---------------|
| Temperature Load Life | |
| 185: | 10,000 cycles |
| 186: | 10,000 cycles |

MARKING

| | |
|---------------------|---|
| Unit Identification | 185/186: Ink stamp on periphery or rear |
|---------------------|---|